



ovlac



REV: 2014 - 06

INSTRUCTIONS AND SPARE PARTS

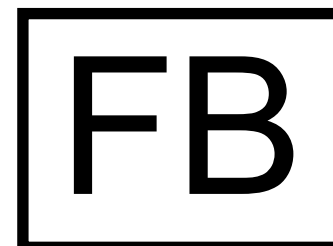

OBSERVATIONS

This handbook describes the use, maintenance instructions and spare parts, supplied for the indicated plough.

The farming implement known as a “plough” is designed to work the soil, linked to a tractor with lift and universal 3-point coupling.

Regular and satisfactory operation together with economic and long lasting use of the implement depend on compliance with the instructions given in this handbook. It is, therefore, advisable to strictly comply with the following instructions in order to prevent faults which could jeopardise the correct and long-lasting operation of the implement.

Compliance with the instructions in this handbook is also important **since the Manufacturer declines all and every responsibility caused by negligence and failure to comply with these instructions.**

The Manufacturer shall, however, remain at the customers disposal for immediate and through assistance together with anything else that may be required in order to ensure the correct operation and maximum efficiency of the implement.

The Manufacturer reserves the right to make any modifications and improvements to the implement as may be considered opportune, without being obliged to immediately the user.

CONTENTS

1. Safety provisions	3
2. Description and Technical data.....	4
3. “ VARILABOR “	5
4. Protection system by shear bolts.....	6
5. Set to work:	
5.1. Mouldboards	7
5.2. Hitching to the tractor	8
5.3. Alignment	9
5.4. Front furrow width	10
5.5. Other adjustments	11
6. Ploughing depth	12
7. Transport and parking	13
8. Maintenance	14
9. Optional equipment	14
10. Spare parts	15
10.1 Spare parts contents	15

1. SAFETY PROVISIONS

- **Thoroughly read all the plough use instructions.**
- **The Manufacturer declines all and every responsibility for failure to comply with the safety and accident-preventing rules described herein.**

1.- Comply with the instructions given by the danger signals exposed in this handbook (Fig.1) and affixed to the plough itself.
 2.- Operations and adjustments to the implement must always be carried out when the engine is off and the tractor braked.
 3.- It is absolutely forbidden to carry passengers or animals on the plough
 4.- It is absolutely forbidden for persons without a driving license, inexpert persons or those in precarious health conditions to drive the tractor with the plough mounted.
 5.- Strictly comply with all the recommended accident preventing measures described in this handbook.

6.- Assembly of an implement on the tractor will shift the weights on the axles.
 7.- Before starting the tractor and plough, always check that all safety devices guarding transport and use are in perfect conditions.
 8.- The instructions labels affixed to the plough give useful advice on how to prevent accidents.
 9.- Always comply with the highway code in force in your country when travelling on public roads.
 10.- Comply with the maximum permissible weight on the axle of the tractor, the total adjustable weight, transport regulations and the highway code.
 11.- Always become familiar with the controls and their operation before starting work.

12.- Take the utmost care during the plough coupling and release phases.
 13.- Never ever leave the driving seat whilst the tractor is moving.
 14.- Remember that the road holding, steering and breaking capacity may be notably influenced by the presence of a mounted implement.
 15.- It is absolutely forbidden to stand within the operative range of the plough.
 16.- Before leaving the tractor, lower the mounted plough coupled to the lift unit, stop the engine, engage the hand brake and remove the ignition key from the control panel.
 17.- The category of the implement coupling pins must correspond to that of the lift coupling.
 18.- Take care when working close to the lift links. This is a very dangerous area.

19.- It is absolutely forbidden to stand between the tractor and the plough, to manoeuvre the outside lift control.
 20.- Set the control lever of the hydraulic lift to the locked position during road transport with the plough mounted.
 21.- The spare parts must correspond to the requirements established by the Manufacturer. Use only genuine spare parts.
 22.- The safety transfers must always be perfectly visible. They must be kept clean and should be replaced if they become illegible. Replacements are available on request from your local dealer.
 23.- The instruction manual must be kept for as long as the machine lasts.

WARNING

- Thoroughly read the manual before starting to work

DANGER

- Do not handle the plough when lifted, danger of flattening. Keep safety distance.

Fig. 1

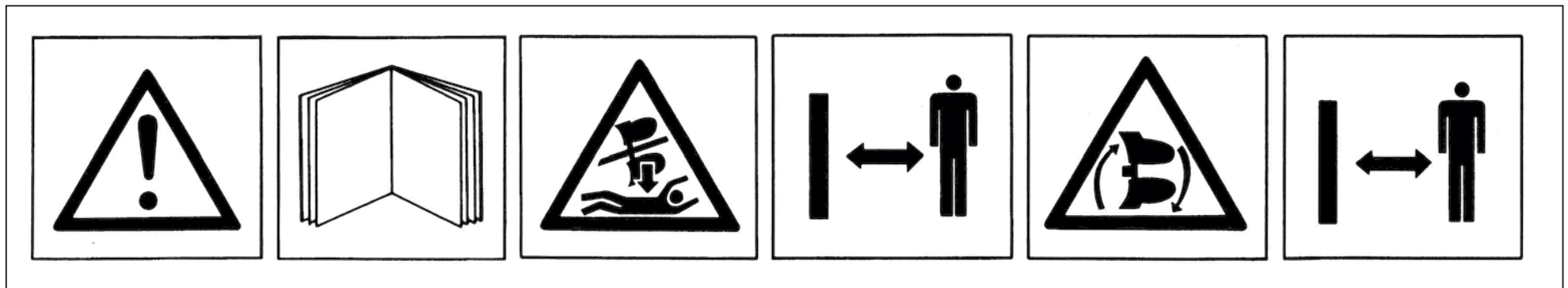

2. DESCRIPTION

- 1.- Headstock
- 2.- Identification plate (Fig. A)
- 3.- Headstock support
- 4.- Cross shaft
- 5.- Shin piece
- 6.- Share point
- 7.- Share
- 8.- Mouldboard
- 9.- Frame
- 10.- Beam
- 11.- Depth Control Wheel
- 12.- Leaf spring

REMARK: The construction number that is engraved in the identification plate (Fig. A) must be coincident with the number engraved on the headstock support.

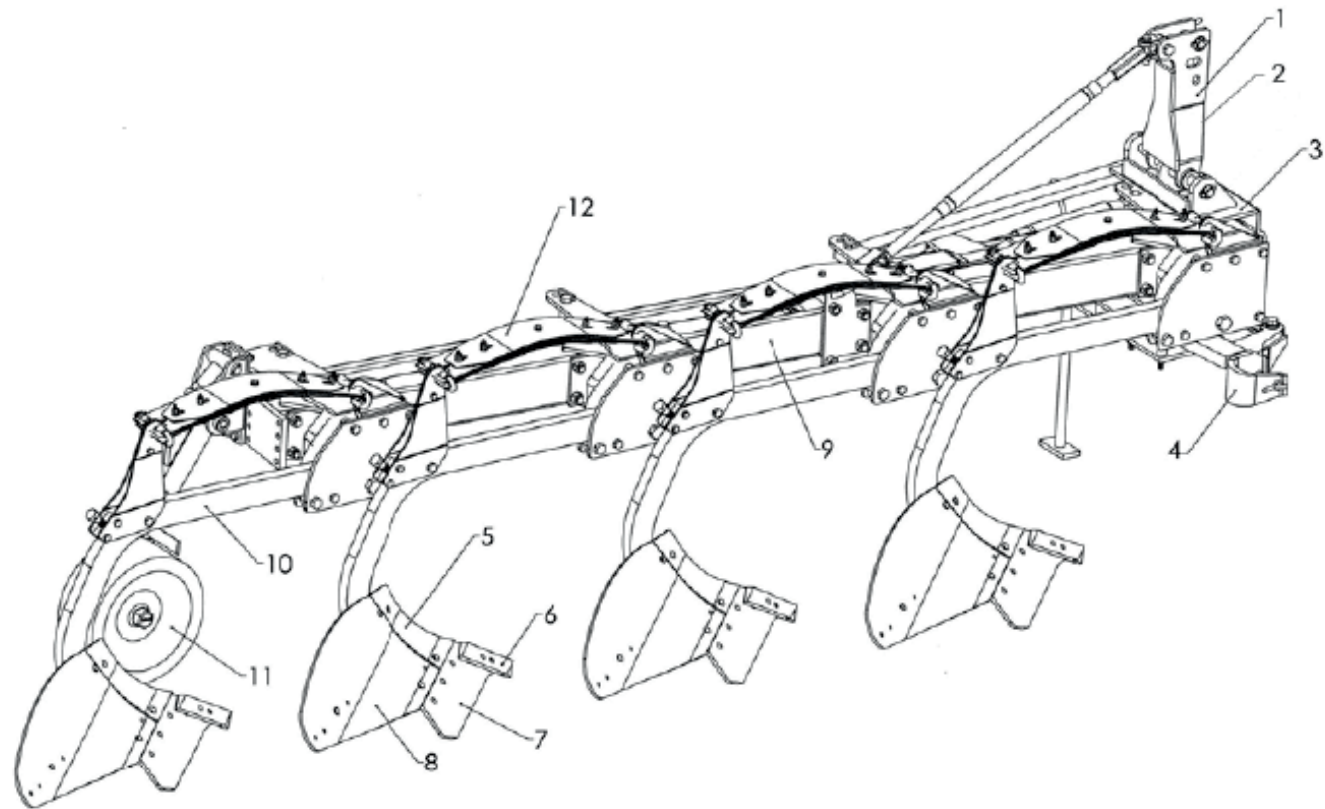





MODEL	FB-2	FB-3	FB-4	FB-4+1	FB-5 EXT	FB-6
	INCHES 12" - 20"					
	CM 30 - 50					
	50/100	75/150	100/200	125/250	125/250	150/300
 CV	60-80	80-90	90-120	120-140	120-140	130-160
 APROX.	730	990	1250	1510	1670	1860
	700 mm					
 mm	850 - 950 mm					



Fig. A

3. VARILABOR

The **FB** plough incorporates the OVLAC exclusive system to adjust the furrow width **-Varilabor-** wich allows to choose any working width between 12" (30 cm) and 20" (50 cm) by means of one only operation on the turnbuckle A (Fig 3.). With the optional hydraulic adjustment, the same operation can be done, even while working, from the tractor cabin, by means of the cylinder B (Fig 4.).

The pointer C (Fig. 3-4) shows the chosen furrow width. Varying the furrow width permits to adapt the plough to soil conditions and to the power of the tractor.

Fig. 3

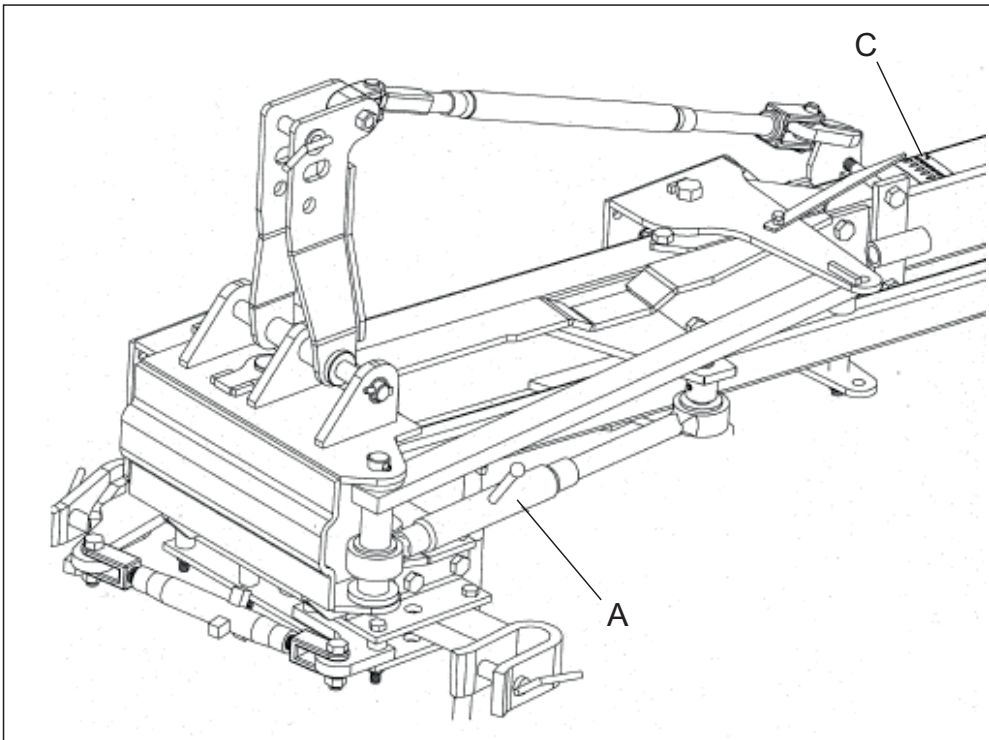
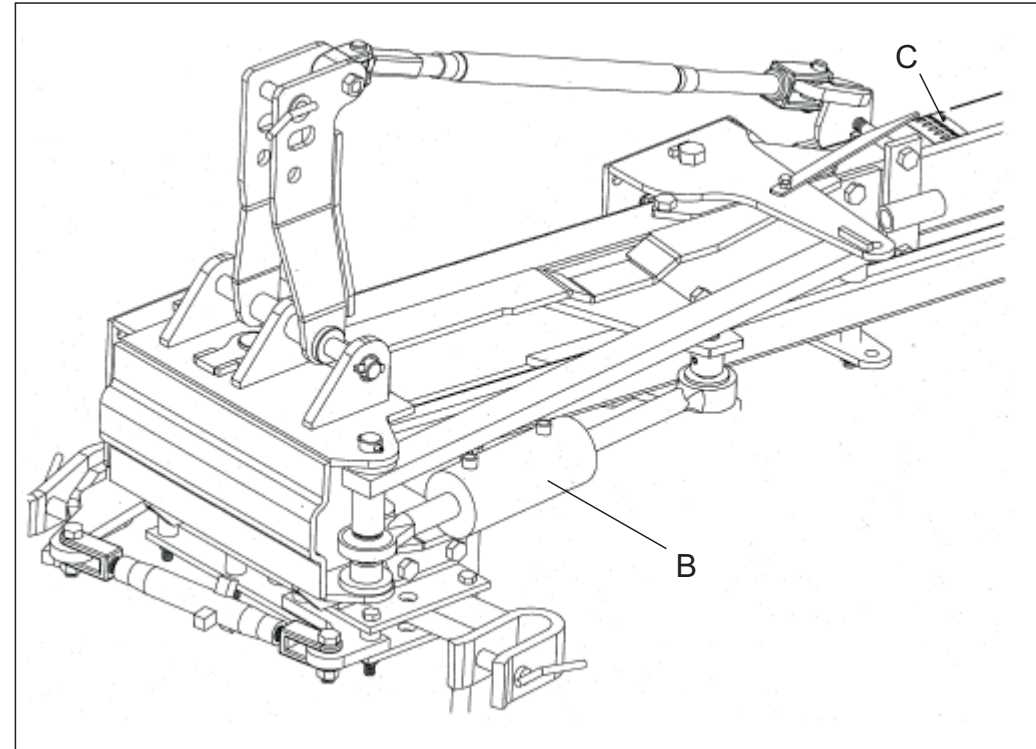

Fig. 4



4. AUTO - RESET PROTECTION SYSTEM

The Auto Reset protection system works automatically. When the share meets an obstacle the protection system pulls the beam up (Fig. 5) thus avoiding the obstacle and returning to its original position afterwards with no need to stop the tractor.

This way all the impacts produced by an uneven field are absorbed by the protection system thus protecting all the elements of the plough and of the tractor too.

For the same reason, the Auto Reset protection decreases the traction effort by not making the tractor overcome every eventual obstacle.

In heavy duty conditions one or more leafs can be added to ease penetration of the plough.

Always check that the distance of the arch determined by the spring is 700 ± 2 mm (Fig 6.). This is achieved by means of the bolt A (Fig 6.) The same figure shows how to adjust the angle of the frogs by means of the hexagonal excentric nut B.

NOTE: The Auto Reset systems from OVLAC are adjusted at the works at an optimal pressure for average conditions

Fig. 5

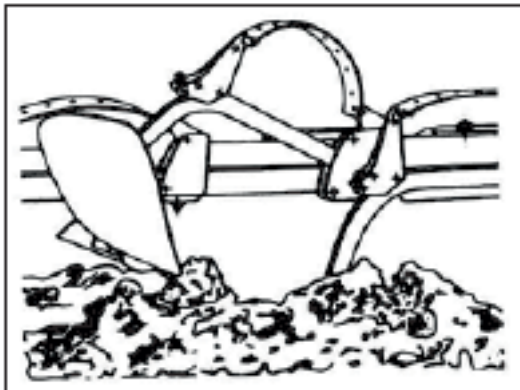
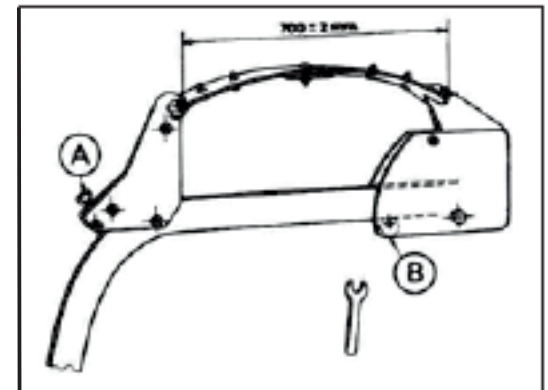

Fig. 6



5. SET TO WORK

5.1. MOULDBOARDS

Before starting work, the paint on the mouldboards should be removed to avoid that the soil remains adhered.

Verify that the lengths $A_1=A_2$ and $B_1=B_2$, as shown in figure (Fig. 7). If these lengths are not coincident, adjust by means of the stay C, working on the nuts D and D' (Fig. 8).

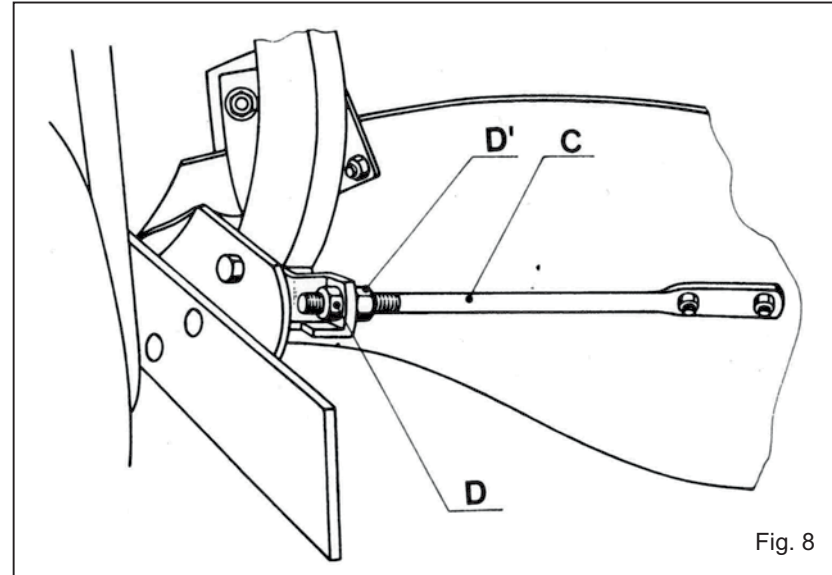
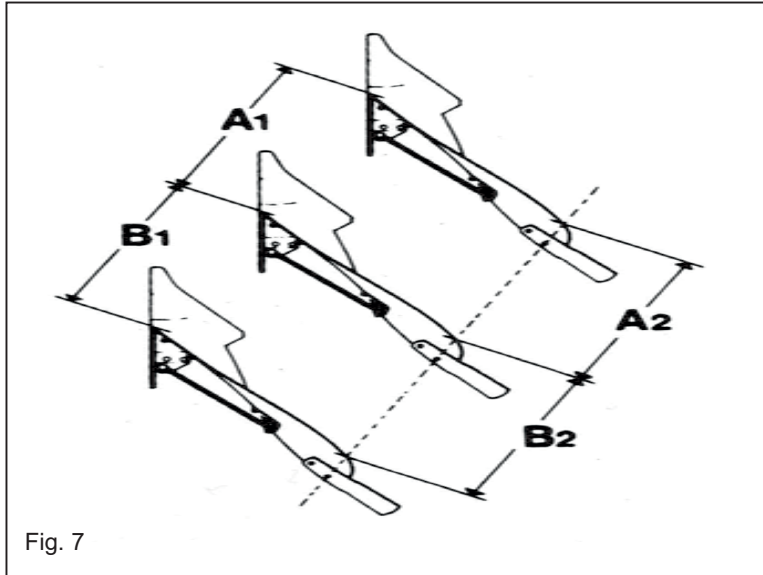

5.2. HITCHING TO THE TRACTOR

The OVLAC ploughs are designed to fit to the 3-point universal coupling of any farming tractor.

The cross shaft can be supplied in two different lengths (centre to centre):

- Category II 900 mm
- Category III 1.000 mm

The cross shaft must have the appropriate length to make the drawing powers converge in the centre of the frontal axle, as shown in figure (Fig. 9).

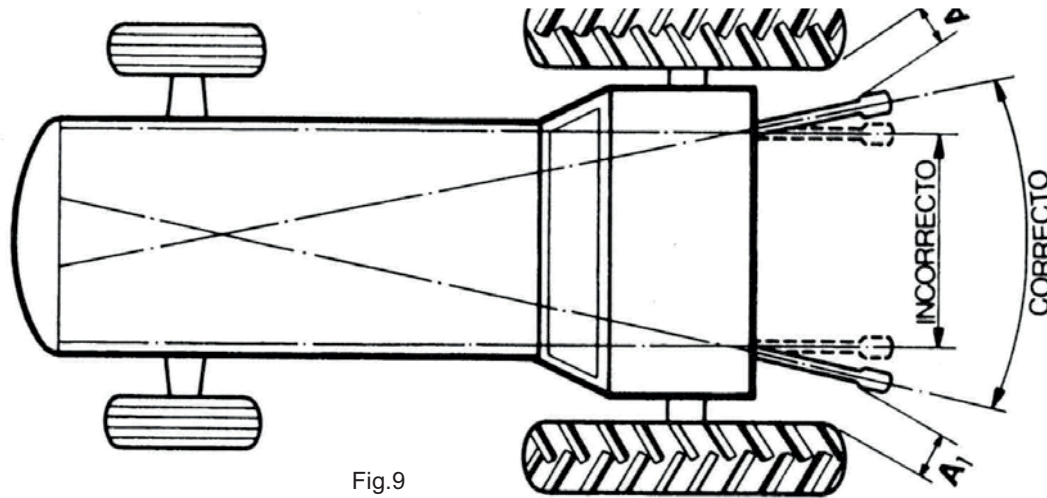

Fig.9

5.3. ALIGNMENT

The plough should always work in line with the tractor. Otherwise, the tractor will tend to leave the furrow course. Check that lengths $A_1=A_2$ (Fig. 9).

Crabbing is corrected automatically in OVLAC ploughs thanks to their oscillating cross shaft.

Nevertheless, if the tractor tends to get out of the furrow, the pin B (fig. 10) must be moved one hole to the right if the trend is leftwards and viceversa.

The top link must be parallel to the direction of the tractor sliding, if necessary, the headstock T (fig.10) along support C.

The top link should be placed so that the end linked to the plough is slightly higher than the one linked to the tractor (Fig.11)

The top link should always be placed in the oblong hole E (Fig. 10), so that its length does not hinder it to move freely while working.

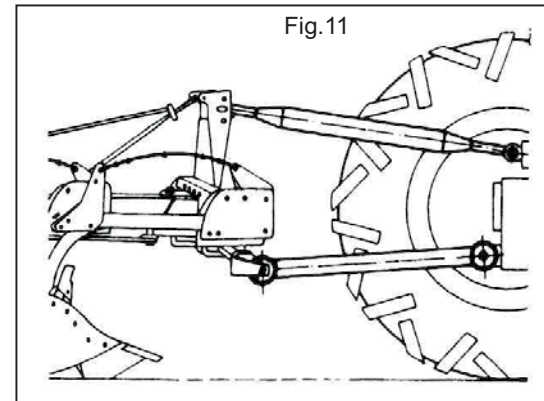
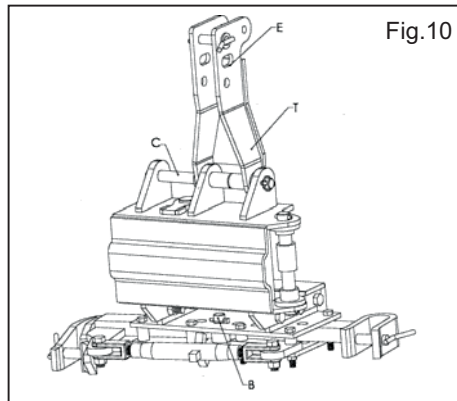

5.4. FRONT FURROW WIDTH

The width of the first furrow is adjusted by sliding the cross shaft B left or right by means of the turnbuckle T (Fig.11), so that the observations in figure (Fig.13) are complied.

The chart below shows the working widths which can be chosen according to the tractor width and the length of the cross shaft.

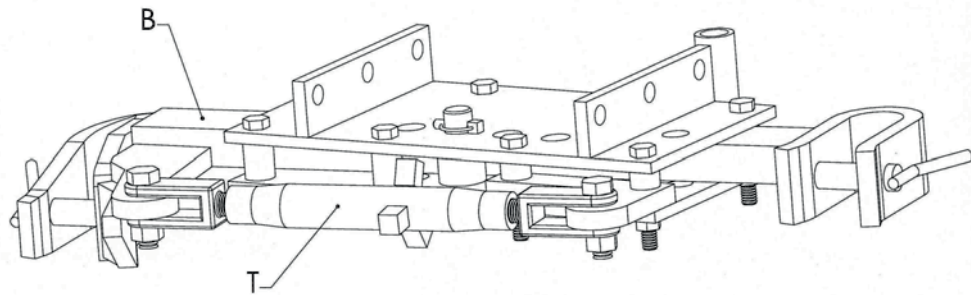
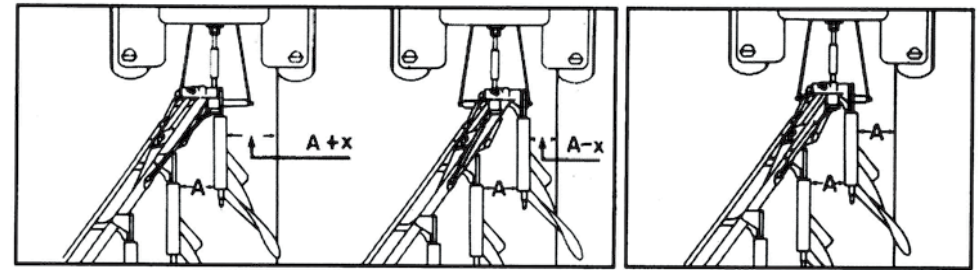

Fig. 12



Incorrecto / Wrong / Incorrect

Correcto / Right / Correct

Fig. 13

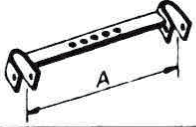
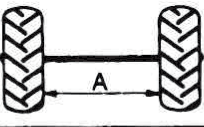
 A	 A	Ancho de Surco Furrow Width Largeur Du Sillon
A = 90	120	30-45
	130	40-50
	140	35-45
	150	40-50
A = 100	140	35-45
	150	40-50
	160	40-50

5.5. OTHER ADJUSTMENTS

The length of the third point should be adjusted so that the frame works in a parallel position with respect to the field since, if not, the front bodies would plough at a different depth than the rear ones achieving an uneven labour (Fig.14).

For the same reason, check that the beams work vertically to the field (Fig.15). To this end, the lifting arms of the tractor should be adjusted so that the cross shaft is in a horizontal position (Fig.16).

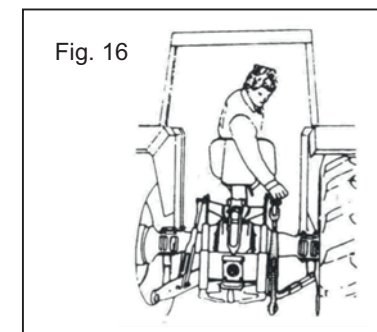
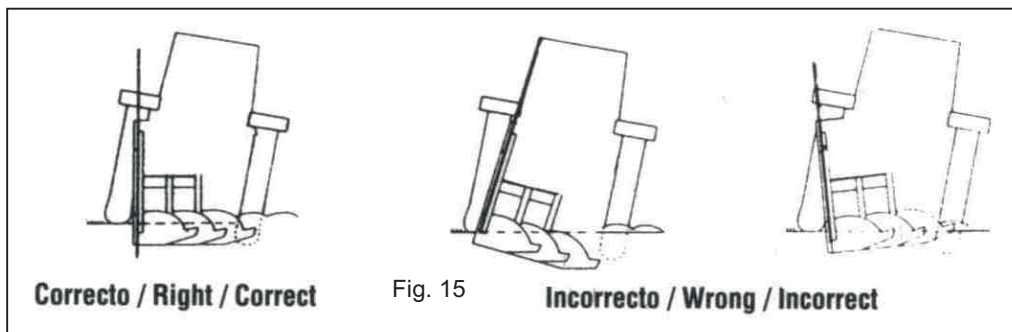
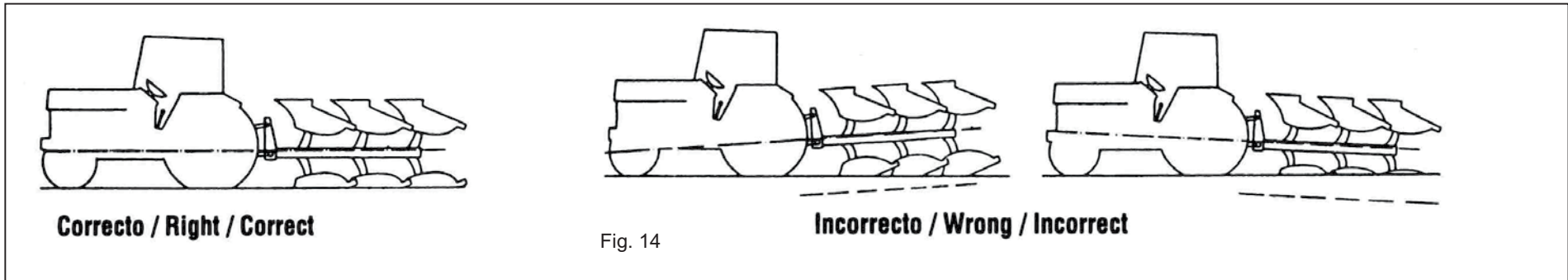

6. PLOUGHING DEPTH

The ploughing depth is adjusted by means of the hydraulic lever of the tractor. Nevertheless, to obtain an even depth, all ploughs can be equipped with a depth control wheel (Fig.17) whose height is adjusted with bolt A.

There is a relationship between depth and width which should be respected in order to achieve satisfactory results.

The following chart gives an excellent reference which, if complied, will lead to satisfactory results

Fig. 17

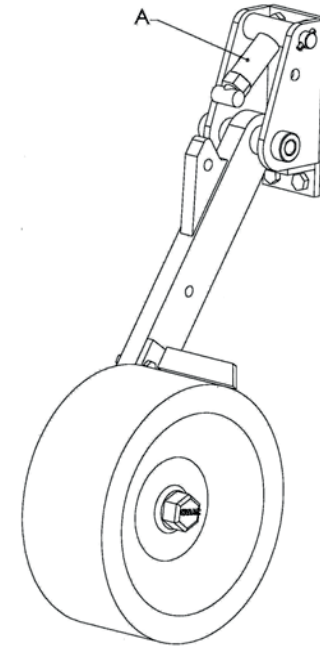

Width	Inches	12"	14"	16"	18"	20"
	Cm	30	35	40	45	50
Max. Depth (cm)		24	28	32	36	40
Min. Depth (cm)		15	17	20	22	25
Recommended depth (cm)		21	25	28	32	25

7. TRANSPORT AND PARKING

In order to ease transport, the plough should be drawn to its minimum width by means of the turnbuckle (T), (Fig.3, pag 9). Large ploughs (4 and 5 furrows) can be equipped with a multi-purpose wheel: depth control and transport wheel: depth control and transport (Fig.18).

To carry the plough on the combi wheel, place pin B in Hole C and release the top link from the headstock. Block the oscillating cross shaft by means of pin D .

The stand P (Fig.19) guarantees a steady position when the plough is parked. When ploughing the support must be in position P

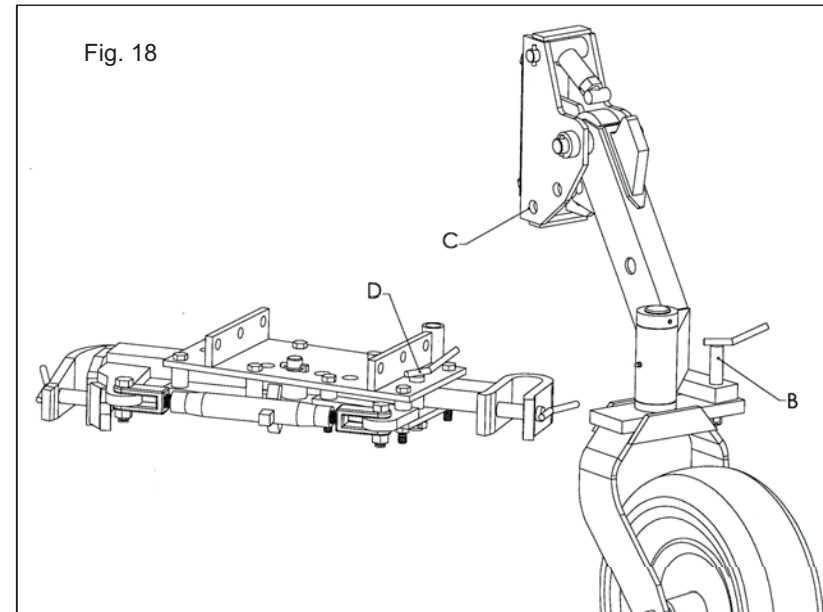
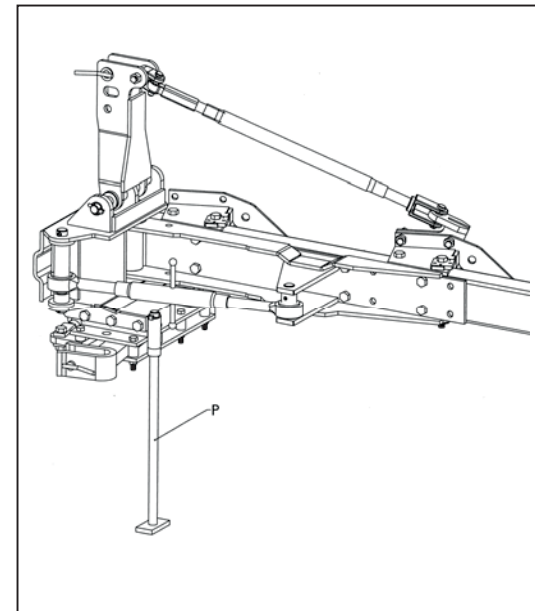

Fig. 19



8. MAINTENANCE

Retighten all bolts and nuts after the first 8 hours of work, specially the ones of mouldboards, shares and points. Henceforth, check every 100 hours of work. When putting the plough away, clean and grease thoroughly the mouldboards to prevent from rusting.

Lubrication: grease the points shown in figure (Fig. 20) regularly.

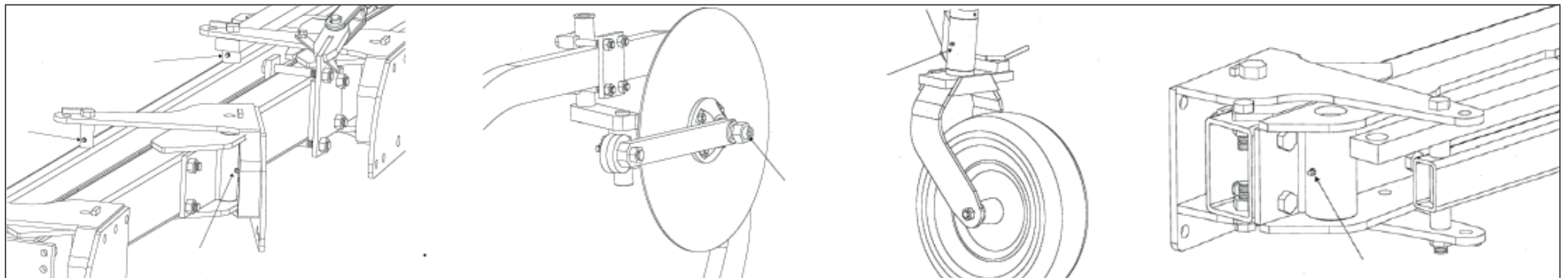

Fig. 20

9. OPTIONAL EQUIPMENT

Our ploughs can be equipped with (Fig. 21):

- A.- Cover boards
- B.- Grass skimmers
- C.- Maize skimmers
- D.- Disc coulters

Fig. 21

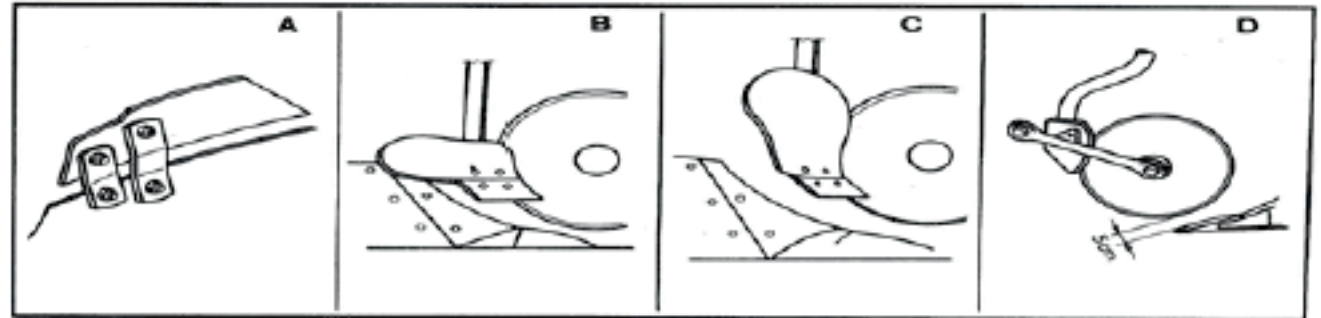

10. SPARE PARTS

Spare parts should always be ordered from your dealer and should always include the following indications:

- **Type, model and serial number of the plough.** These data are punched on the identification plate with every plough is equipped (Pág. 4, Fig. A)
- **Code number of the required spare parts.** This will be found in the attached spare parts list.
- **Description of the part and required quantity.**
- **Mrsnd of delivery.** Transport expenses shall always be at the consignor's charge.

NOTE: The terms **Right** and **Left** indicated on the descriptions, refer to the plough when viewed from the rear. The sapre parts components of waste equipment, as shares, mouldboards, etc... are considered right if they are mounted on a body which spills the soil to the right side and vice versa.

NOTE ABOUT THE WARRANTY:The orders of spare parts in warrantly should always be clearly specified. **The Manufacturer will always sentence if the spare parts are warranted in their replacement.**

MOREOVER, THE WARRANTY IS SUPPRESSED IF:

- **The plough is repaired witout authorisation from the Manufacturer, or spurious spare parts, and inadequate bolts are mounted.**
- **The plough has been used beyond the specified power limit as given in the chart o page 4 or anomalous manoeuvres and operations have been made.**

CONTENTS

1. HEADSTOCKS	16
2. FRAMES	22
3. ADDITIONAL BODY	31
4. LEG ASSEMBLY	32
5. DISC COULTERS	34
6. VARYWIDTH SYSTEM	38
7. HYDR. 1° BODY ADJUSTMENT .	39
8. TRASH BOARDS	41
9. SKIMMERS	43
10. BODIES	45
11. WHEELS	51

HEADSTOCK 100

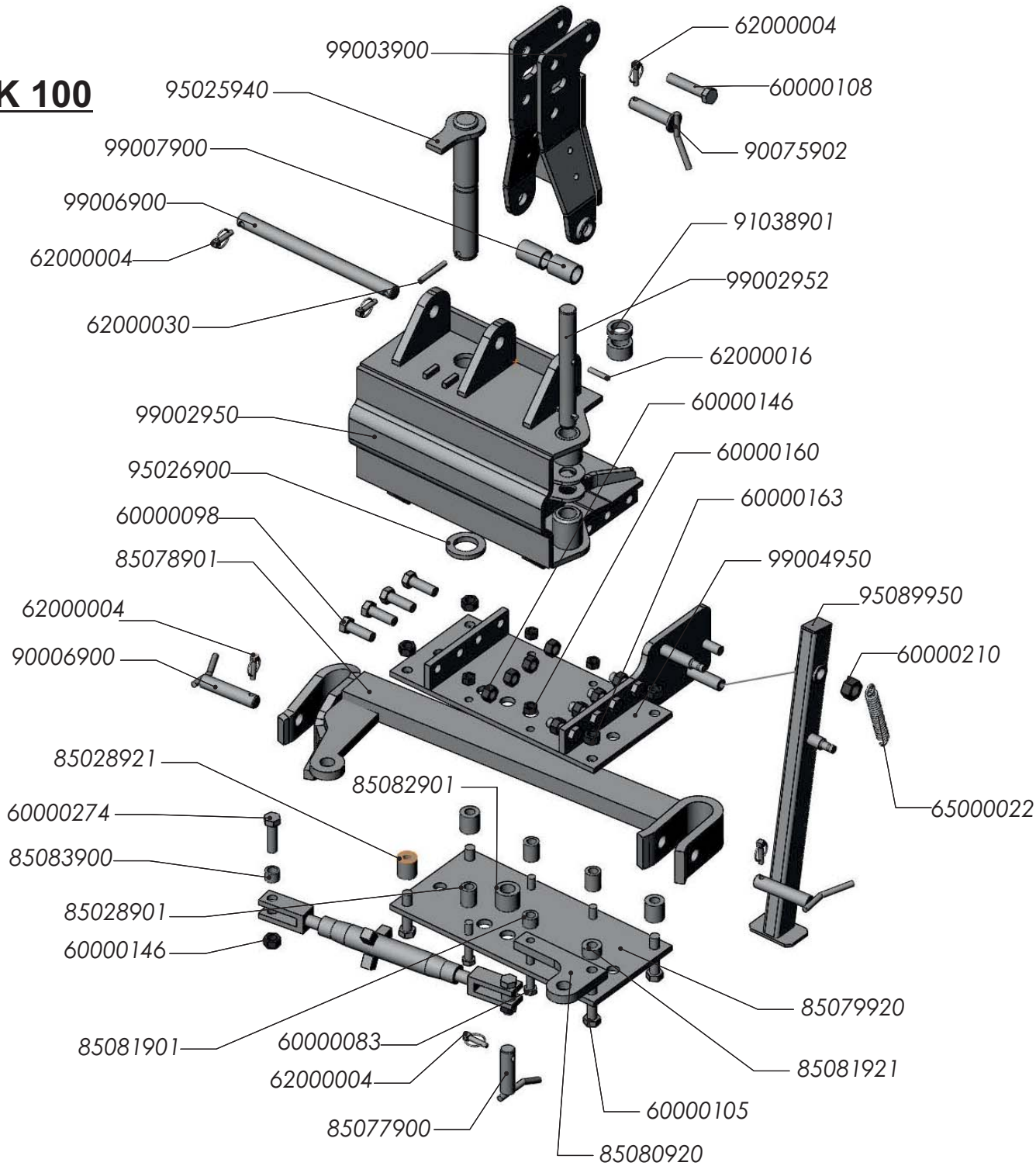

HEADSTOCK 100

Reference	Description	Reference	Description
60000083	BOLT D-931 16*90 8.8	85079920	SHAFT PLATE UP/LOW FB
60000098	BOLT D-931 20*60 8.8	85080920	SHAFT MOVING PLATE
60000105	BOLT D-931 20*90 8.8	85081901	SPACER B.P. 32/20*23 mm
60000108	BOLT D-931 20*110 8.8 ZINC	85081921	BUSH D=40/21*22 mm SHAFT SPACER 40 mm FB
60000146	SELF LOCK NUT D-980 20 10.9 ZINC	85082901	BUSH D=50/31*40 mm SUPPORT CROSS SHAFT 40 mm
60000160	NUT D-934 16 8.8 ZINC	85083900	BUSH D=29.8/21*21 mm SHAFT PLATE FRBV/FB
60000163	NUT D-934 20 8.8	90006900	SHAFT PIN D=28*130 mm CAT II ZINC
60000210	SELF LOCK NUT D-985 1" SAE 8.8	90075902	PIN D=25*110 3RD POINT CAT II ZINC
60000274	BOLT D-931 20*70 8.8 ZINC	91038901	SPACER B.P. 51/36*15 mm ZINC
62000004	RING SPLIT PIN 10 ZINC	95025940	PIN D=50*336mm FRAME TURNING
62000016	ELASTIC PIN D-1481 10*50 ZINC	95026900	WASHER FRAME TURNING
62000030	ELASTIC PIN D-1481 10*80 ZINC	95089950	STAND FBN
64000012	TURNBUCKLE D=20 30195 ZINC	99002950	HEADSTOCK FBN
65000022	SPRING 225/175*26*5 195 mm	99002952	TURNBUCKLE FRONT PIN D=34.6*288 mm FBN
85028901	SPACER B.P. 32/20*42 mm	99003900	HEADSTOCK FB-2/3/4
85028921	BUSH D=40/21*42 mm SHAFT SPACER 40 mm FB	99004950	SHAFT SUPPORT FBN
85077900	PULL PIN D=30*105 mm FB	99006900	HEADSTOCK TURNING PIN D=30*400 FB
85078901	CROSS SHAFT 40mm CAT II	99007900	SPACER 1" 1/4 60mm ZINC

HEADSTOCK 150

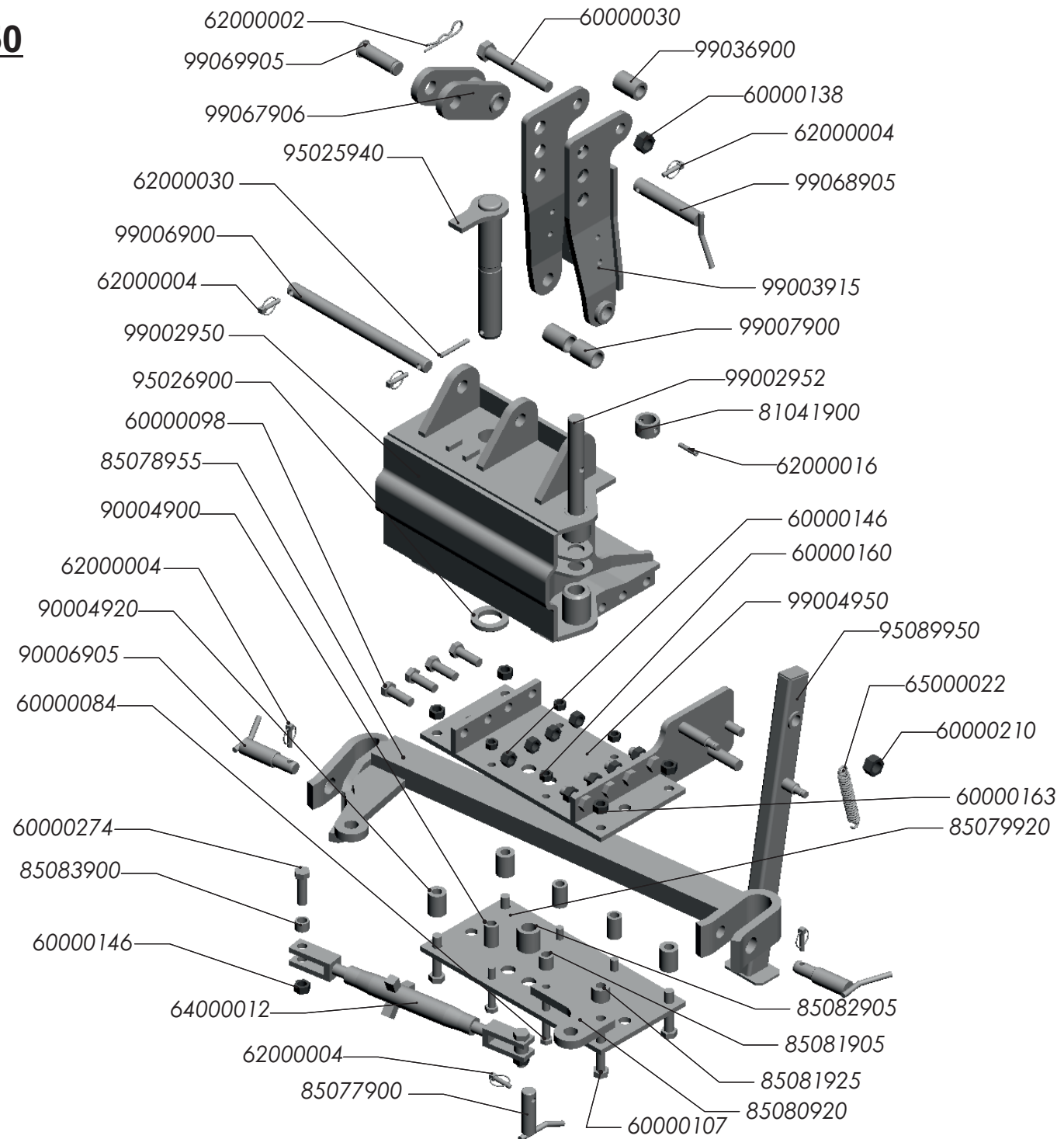

HEADSTOCK 150

Reference	Description	Reference	Description
60000030	BOLT 1"*175 SAE 12.9	85081905	SPACER B.P. 32/20*31 mm
60000084	BOLT D-931 16*100 8.8	85081925	BUSH D=40/21*32 mm SHAFT SPACER 50 mm FB
60000098	BOLT D-931 20*60 8.8	85082905	LEAN PIN CROSS SHAFT 50mm
60000107	BOLT D-931 20*100 8.8	85083900	BUSH D=29.8/21*21 mm SHAFT PLATE FRBV/FB
60000138	SELF LOCK NUT D-980 1" SAE 10.9 ZINC	90004900	SPACER B.P. 32/20*52 mm
60000146	SELF LOCK NUT D-980 20 10.9 ZINC	90004920	BUSH D=40/21*52 mm SHAFT SPACER 50 mm FB
60000160	NUT D-934 16 8.8 ZINC	90006905	CROSS SHAFT PIN D=36/28*140 mm CAT.III
60000163	NUT D-934 20 8.8	95025940	PIN D=50*336mm FRAME TURNING
60000210	SELF LOCK NUT D-985 1" SAE 8.8	95026900	WASHER FRAME TURNING
60000274	BOLT D-931 20*70 8.8 ZINC	95089950	STAND FBN
62000002	SPLIT PIN 5 ZINC	99002950	HEADSTOCK FBN
62000004	RING SPLIT PIN 10 ZINC	99002952	TURNBUCKLE FRONT PIN D=34.6*288 mm FBN
62000016	ELASTIC PIN D-1481 10*50 ZINC	99003915	HEADSTOCK FB-5
62000030	ELASTIC PIN D-1481 10*80 ZINC	99004950	SHAFT SUPPORT FBN
64000012	TURNBUCKLE D=20 30195 ZINC	99006900	HEADSTOCK TURNING PIN D=30*400 FB
65000022	SPRING 225/175*26*5 195 mm	99007900	SPACER 1" 1/4 60mm ZINC
81041900	SPACER B.P. 51/36*32 mm	99036900	SPACER B.P. 42/26*60mm
85077900	PULL PIN D=30*105 mm FB	99067906	THIRD POINT ROD
85078955	CROSS SHAFT 50mm. CAT-III/III	99068905	PIN D=31,5*180 mm
85079920	SHAFT PLATE UP/LOW FB	99069905	PIN D=31,5*106 mm FB-5/6
85080920	SHAFT MOVING PLATE		

HEADSTOCK 180

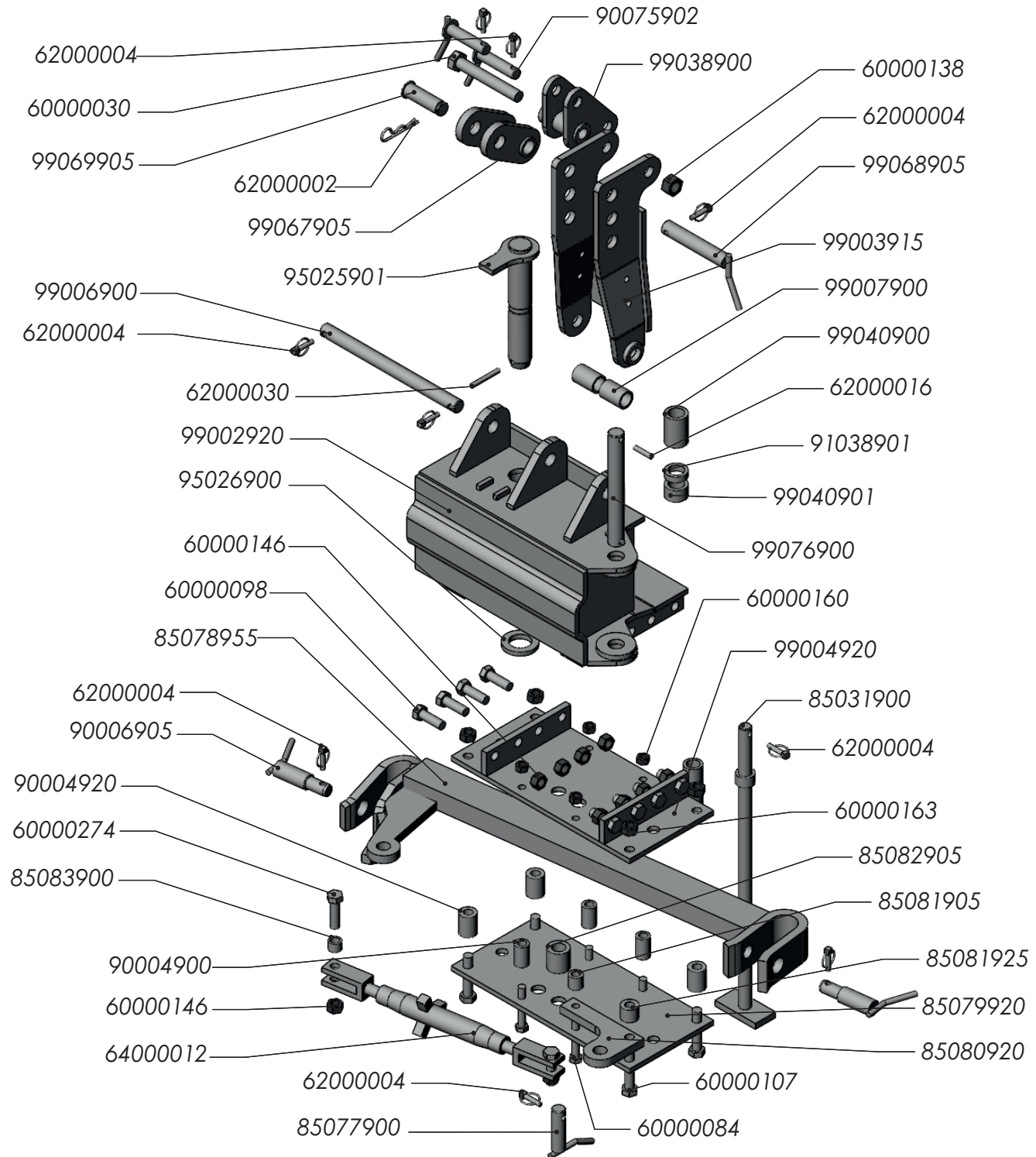

HEADSTOCK 180

Reference	Description	Reference	Description
60000030	BOLT 1"*175 SAE 12.9	85081905	SPACER B.P. 32/20*31 mm
60000084	BOLT D-931 16*100 8.8	85081925	BUSH D=40/21*32 mm SHAFT SPACER 50 mm FB
60000098	BOLT D-931 20*60 8.8	85082905	LEAN PIN CROSS SHAFT 50mm
60000107	BOLT D-931 20*100 8.8	85083900	BUSH D=29.8/21*21 mm SHAFT PLATE FRBV/FB
60000138	SELF LOCK NUT D-980 1" SAE 10.9 ZINC	90004900	SPACER B.P. 32/20*52 mm
60000146	SELF LOCK NUT D-980 20 10.9 ZINC	90004920	BUSH D=40/21*52 mm SHAFT SPACER 50 mm FB
60000160	NUT D-934 16 8.8 ZINC	90006905	CROSS SHAFT PIN D=36/28*140 mm CAT.III
60000163	NUT D-934 20 8.8	90075902	PIN D=25*110 3RD POINT CAT II ZINC
60000210	SELF LOCK NUT D-985 1" SAE 8.8	95025940	PIN D=50*336mm FRAME TURNING
60000274	BOLT D-931 20*70 8.8 ZINC	95026900	WASHER FRAME TURNING
62000002	SPLIT PIN 5 ZINC	95089950	STAND FBN
62000004	RING SPLIT PIN 10 ZINC	99002952	TURNBUCKLE FRONT PIN D=34.6*288 mm FBN
62000016	ELASTIC PIN D-1481 10*50 ZINC	99002970	HEADSTOCK FBN-6
62000030	ELASTIC PIN D-1481 10*80 ZINC	99003915	HEADSTOCK FB-5
64000012	TURNBUCKLE D=20 30195 ZINC	99004950	SHAFT SUPPORT FBN
65000022	SPRING 225/175*26*5 195 mm	99006900	HEADSTOCK TURNING PIN D=30*400 FB
81041900	SPACER B.P. 51/36*32 mm	99007900	SPACER 1" 1/4 60mm ZINC
85077900	PULL PIN D=30*105 mm FB	99038900	DOUBLE STAY SUPPORT FB/FF
85078955	CROSS SHAFT 50mm. CAT-III/III	99067906	THIRD POINT ROD
85079920	SHAFT PLATE UP/LOW FB	99068905	PIN D=31,5*180 mm
85080920	SHAFT MOVING PLATE	99069905	PIN D=31,5*106 mm FB-5/6

FRAME 100

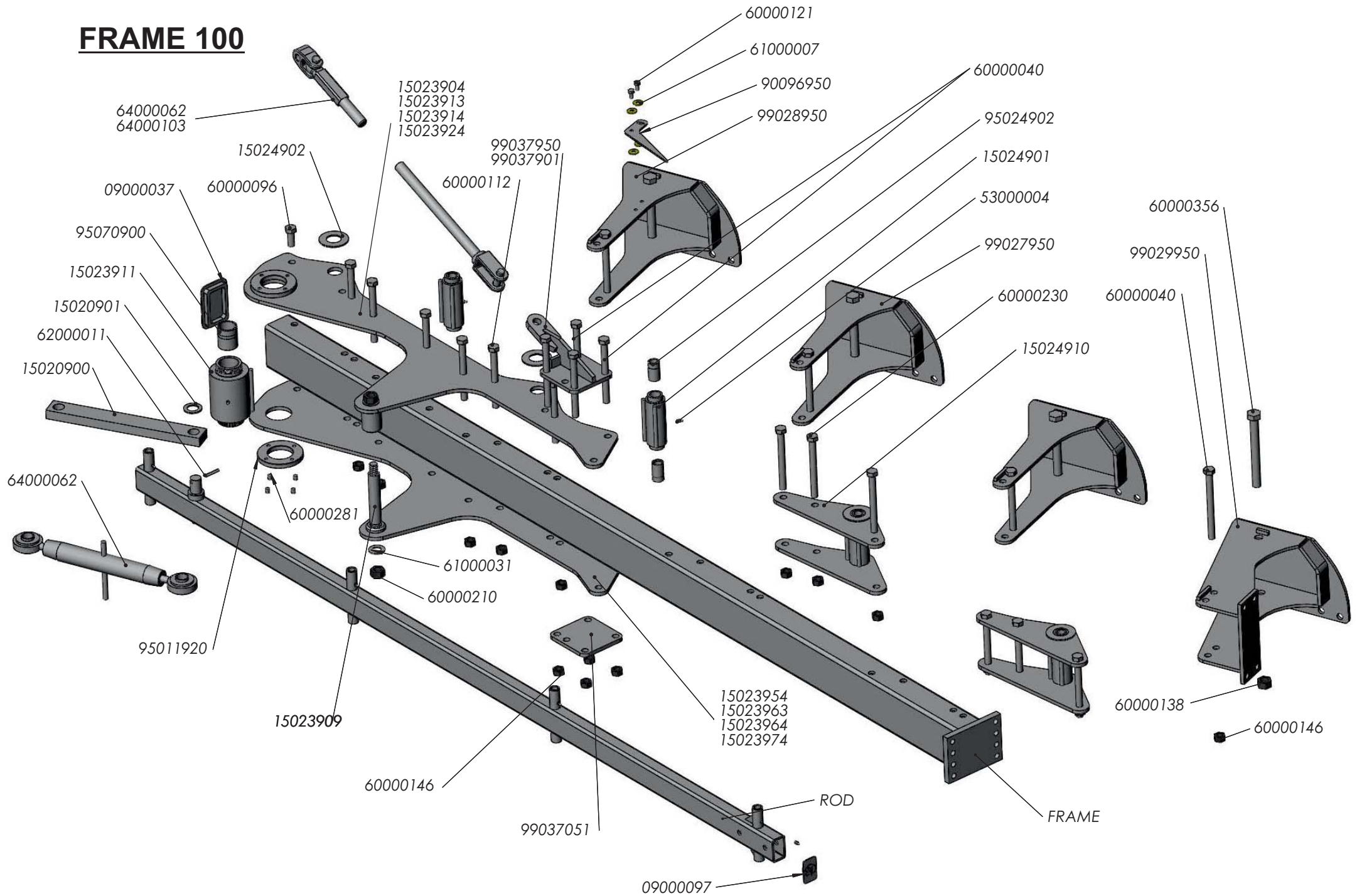

FRAME 100

Reference	Description	Reference	Description
9000037	RUBBER CAP 150*100*10 mm	60000138	SELF LOCK NUT D-980 1" SAE 10.9 ZINC
9000097	RUBBER CAP 80*50*6 mm	60000146	SELF LOCK NUT D-980 20 10.9 ZINC
15020900	CONNECTION ROD PLATE SN (500/440)	60000210	SELF LOCK NUT D-985 1" SAE 8.8
15020901	WASHER ROD PULL PLATE D=35,5 mm	60000230	BOLT 20*200 12.9
15023904	UPPER PLATE FRAME TURN SUPPORT SN-3/4-95	60000281	ALLEN BOLT D-913 12*14 12.9
15023909	TURNBUCKLE REAR PIN SN D=34,6*240 mm	60000356	BOLT 1"*240 SAE 12.9
15023911	FRAME TURNING BUSH SN 120	61000007	WASHER D-9021 10 ZINC
15023913	UPPER PLATE FRAME TURN SUPPORT SN-2-85	61000031	WASHER 26 ZINC
15023914	UPPER PLATE FRAME TURN SUPPORT SN-3/4-85	62000011	ELASTIC PIN D-1481 8*50 ZINC
15023924	UPPER PLATE FRAME TURN SUPPORT SN-3/4-105	64000062	TURNBUCKLE WITH EYE D=35 30386 ZINC
15023954	LOWER PLATE FRAME TURN SUPPORT SN-3/4-95	64000103	TURNBUCKLE 1" 1/4*650 30231-30367 ZINC
15023963	LOWER PLATE FRAME TURN SUPPORT SN-2-85	90096950	WIDTH POINTER ZINC
15023964	LOWER PLATE FRAME TURN SUPPORT SN-3/4-85	95011920	HEADSTOCK 120/140/150 SHAFT NET LOCK
15023974	LOWER PLATE FRAME TURN SUPPORT SN-3/4-105	95024902	LAMINATED BUSH D=35/26/30*60 mm
15024901	BUSH D=60/45,9/35*183mm.	95070900	LAMINATED BUSH D=60/50*70 mm SS / FRAME TURNING
15024902	WASHER D=90/46*4mm	99027950	BEAM BRACKET FBN
15024910	TURNING SUPPORT BEAM BRACKET SN	99028950	BEAM BRACKET (POINTER)
53000004	GREASER MT-503 8*125 D-71412	99029950	BEAM/WHEEL BRACKET FBN
60000040	BOLT D-931 20*230 8.8	99037901	SUPP.FRAME TURNBUCKLE FB-2
60000096	BOLT D-933 20*50 8.8	99037950	TURNBUCKLE SUPP. FBN-100
60000112	BOLT D-931 20*200 8.8	99037951	PLATE SUPPORT TURNBUCKLE FBN-100
60000121	BOLT D-931 10*20 8.8 ZINC		

FRAME 100

FRAME		ROD	
Reference	Description	Reference	Description
15019903	FRAME SN-3-95	15021903	ROD SN-3-95
15019912	FRAME SN-2-85	15021912	ROD SN-2-85
15019913	FRAME SN-3-85	15021913	ROD SN-3-85
15019923	FRAME SN-3-105	15021923	ROD SN-3-105
15019924	FRAME SN-4-105	15021924	ROD SN-4-105
28019904	FRAME FBN-4-95	15021954	ROD SN-4-95-EXT
28019914	FRAME FBN-4-85	15021964	ROD SN-4-85-EXT

FRAME 150

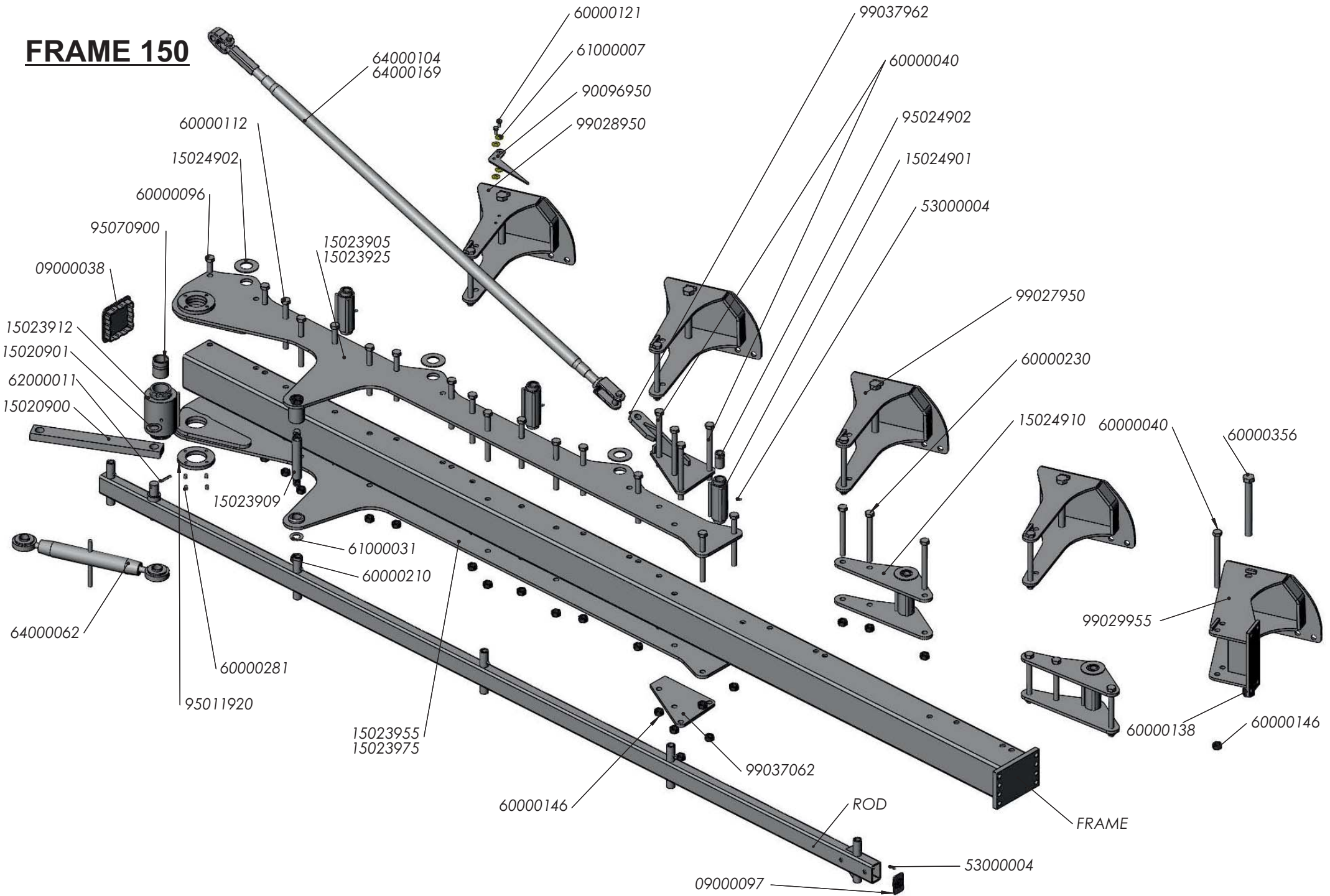

FRAME 150

FRAME		ROD	
Reference	Description	Reference	Description
15019953	FRAME SN-3-95 (150)	15021903	ROD SN-3-95
28019954	FRAME FBN-4-95-EXT	15021954	ROD SN-4-95-EXT
28019974	FRAME FBN-4-105-EXT	15021974	ROD SN-4-105-EXT

Reference	Description	Reference	Description
9000038	RUBBER CAP 150*150*10 mm	60000210	SELF LOCK NUT D-985 1" SAE 8.8
9000097	RUBBER CAP 80*50*6 mm	60000230	BOLT 20*200 12.9
15020900	CONNECTION ROD PLATE SN (500/440)	60000281	ALLEN BOLT D-913 12*14 12.9
15020901	WASHER ROD PULL PLATE D=35,5 mm	60000356	BOLT 1"*240 SAE 12.9
15023905	UPPER PLATE FRAME TURN SUPPORT SN-4A/5-95	61000007	WASHER D-9021 10 ZINC
15023909	TURNBUCKLE REAR PIN SN D=34,6*240 mm	61000031	WASHER 26 ZINC
15023912	FRAME TURNING BUSH SN 150	62000011	ELASTIC PIN D-1481 8*50 ZINC
15023925	UPPER PLATE FRAME TURN SUPPORT SN-4A/5-105	64000062	TURNBUCKLE WITH EYE D=35 30386 ZINC
15023955	LOWER PLATE FRAME TURN SUPPORT SN-4A/5-95	64000104	TURNBUCKLE 1"1/4 1450 30231-30367
15023975	LOWER PLATE FRAME TURN SUPPORT SN-4A/5-105	64000169	TURNBUCKLE 1"1/4 1650 30231-30367
15024901	BUSH D=60/45,9/35*183mm.	90096950	WIDTH POINTER ZINC
15024902	WASHER D=90/46*4mm	95011920	HEADSTOCK 120/140/150 SHAFT NET LOCK
15024910	TURNING SUPPORT BEAM BRACKET SN	95024902	LAMINATED BUSH D=35/26/30*60 mm
53000004	GREASER MT-503 8*125 D-71412	95070900	LAMINATED BUSH D=60/50*70 mm SS / FRAME TURNING
60000040	BOLT D-931 20*230 8.8	99027950	BEAM BRACKET FBN
60000096	BOLT D-933 20*50 8.8	99028950	BEAM BRACKET (POINTER)
60000112	BOLT D-931 20*200 8.8	99029955	BEAM/WHEEL BRACKET FBN-5A/6
60000121	BOLT D-931 10*20 8.8 ZINC	99037062	BASE PLATE TURNBUCKLE SUPP FBN-150-95/105
60000138	SELF LOCK NUT D-980 1" SAE 10.9 ZINC	99037962	TURNBUCKLE SUPP. FBN-150-95/105
60000146	SELF LOCK NUT D-980 20 10.9 ZINC		

FRAME 180

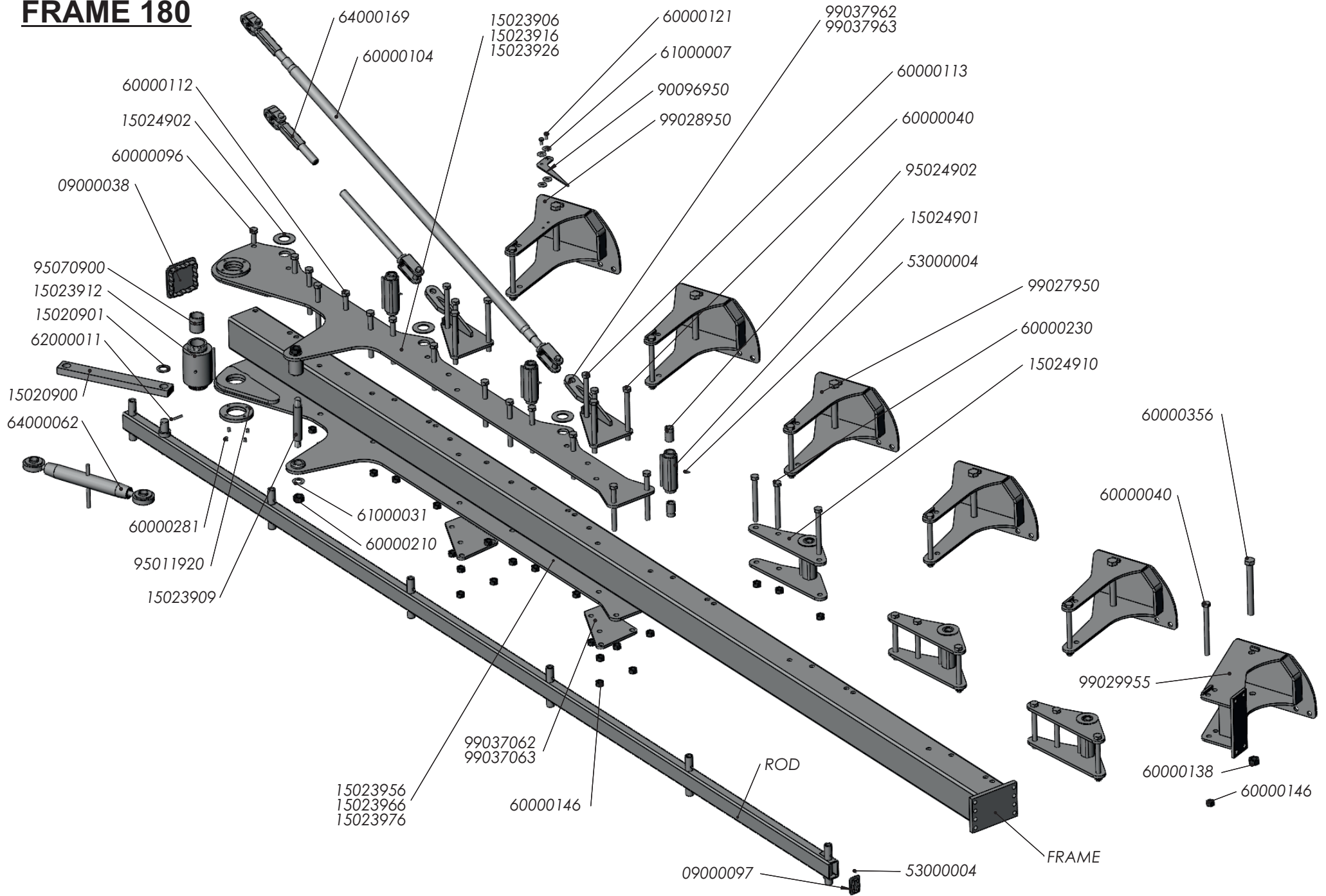

FRAME 180

FRAME		ROD	
Reference	Description	Reference	Description
15019906	FRAME SN-6-95	15021906	ROD SN-5-95
15019916	FRAME SN-6-85	15021916	ROD SN-6-85
15019955	FRAME SN-5-95-EXT	15021955	ROD SN-5-95-EXT
15019965	FRAME SN-5-95 EXT.	15021965	ROD SN-5-85-EXT
15019975	FRAME SN-5-105-EXT	15021975	ROD SN-5-105-EXT

Reference	Description	Reference	Description
9000038	RUBBER CAP 150*150*10 mm	60000146	SELF LOCK NUT D-980 20 10.9 ZINC
9000097	RUBBER CAP 80*50*6 mm	60000210	SELF LOCK NUT D-985 1" SAE 8.8
15020900	CONNECTION ROD PLATE SN (500/440)	60000230	BOLT 20*200 12.9
15020901	WASHER ROD PULL PLATE D=35,5 mm	60000281	ALLEN BOLT D-913 12*14 12.9
15023906	UPPER PLATE FRAME TURN SUPPORT SN-5A/6-95	60000356	BOLT 1"*240 SAE 12.9
15023909	TURNBUCKLE REAR PIN SN D=34,6*240 mm	61000007	WASHER D-9021 10 ZINC
15023912	FRAME TURNING BUSH SN 150	61000031	WASHER 26 ZINC
15023916	UPPER PLATE FRAME TURN SUPPORT SN-5A/6-85	62000011	ELASTIC PIN D-1481 8*50 ZINC
15023926	UPPER PLATE FRAME TURN SUPPORT SN-5A/6-105	64000062	TURNBUCKLE WITH EYE D=35 30386 ZINC
15023956	LOWER PLATE FRAME TURN SUPPORT SN-5A/6-95	64000104	TURNBUCKLE 1"1/4 1450 30231-30367
15023966	LOWER PLATE FRAME TURN SUPPORT SN-5A/6-85	64000169	TURNBUCKLE 1"1/4 1650 30231-30367
15023976	LOWER PLATE FRAME TURN SUPPORT SN-5A/6-105	90096950	WIDTH POINTER ZINC
15024901	BUSH D=60/45,9/35*183mm.	95011920	HEADSTOCK 120/140/150 SHAFT NET LOCK
15024902	WASHER D=90/46*4mm	95024902	LAMINATED BUSH D=35/26/30*60 mm
15024910	TURNING SUPPORT BEAM BRACKET SN	95070900	LAMINATED BUSH D=60/50*70 mm SS / FRAME TURNING
53000004	GREASER MT-503 8*125 D-71412	99027950	BEAM BRACKET FBN
60000040	BOLT D-931 20*230 8.8	99028950	BEAM BRACKET (POINTER)
60000096	BOLT D-933 20*50 8.8	99029955	BEAM/WHEEL BRACKET FBN-5A/6
60000104	BOLT D-931 20*85 8.8	99037062	BASE PLATE TURNBUCKLE SUPP FBN-150-95/105
60000112	BOLT D-931 20*200 8.8	99037063	BASE PLATE TURNBUCKLE SUPP FBN-150-85
60000113	BOLT D-931 20*210 8.8	99037962	TURNBUCKLE SUPP. FBN-150-95/105
60000121	BOLT D-931 10*20 8.8 ZINC	99037963	TURNBUCKLE SUPP. FBN-150-85
60000138	SELF LOCK NUT D-980 1" SAE 10.9 ZINC		

ADDITIONAL BODY

Reference	Description
9000038	RUBBER CAP 150*150*10 mm
9000097	RUBBER CAP 80*50*6 mm
15019901	FRAME SN-1-95-(100)
15019911	FRAME SN-1-85-(100)
15019951	FRAME SN-1-95-(150)
15019961	FRAME SN-1-85-(150)
15021901	ROD SN-1-95
15021911	ROD SN-1-85
53000004	GREASER MT-503 8*125 D-71412
60000080	BOLT D-931 16*60 8.8 ZINC
60000083	BOLT D-931 16*90 8.8
60000143	SELF LOCK NUT D-980 16 8.8 ZINC
95022900	CONNECTION PLATE ROD ADD. FU.

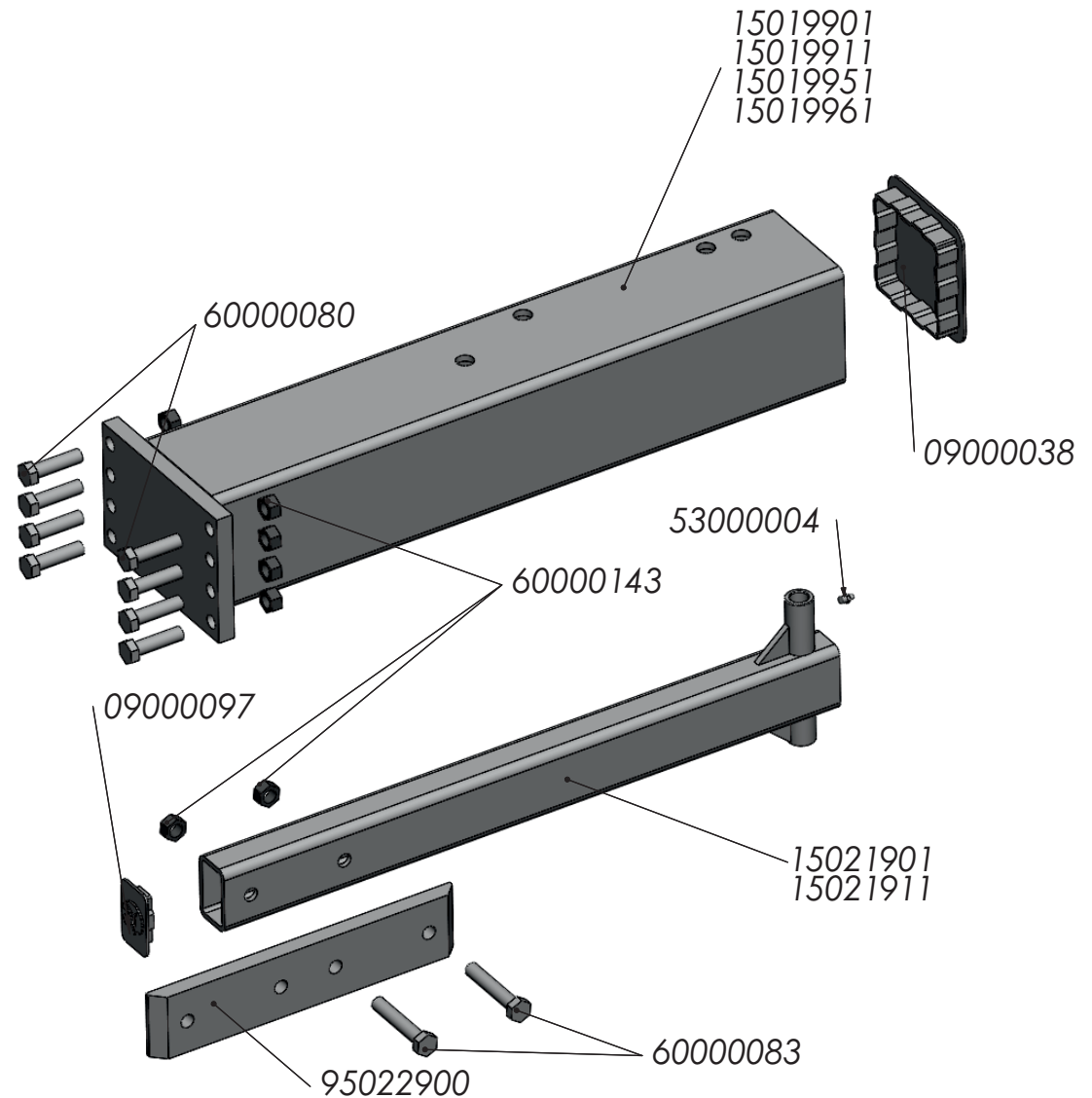

LEG ASSEMBLY

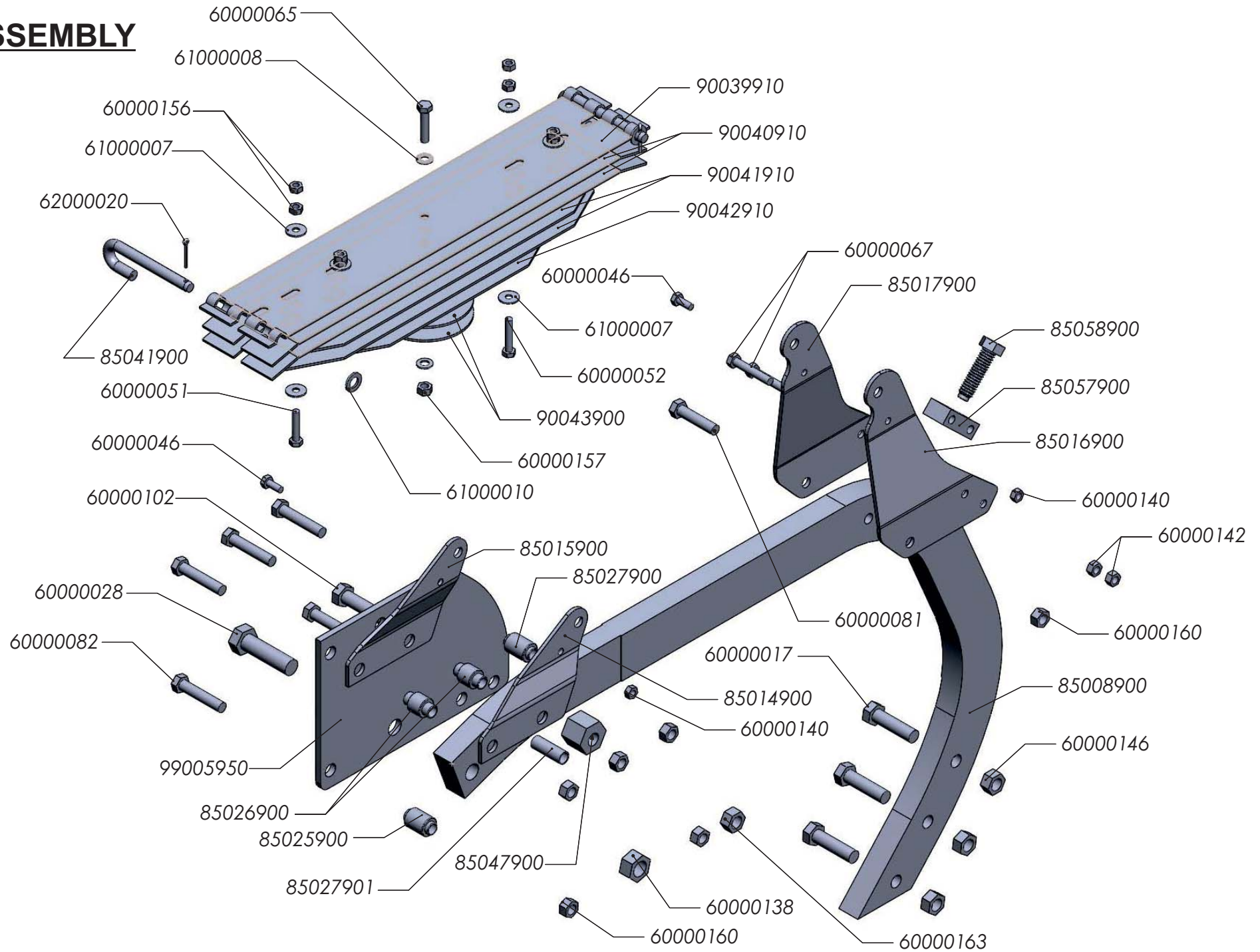

LEG ASSEMBLY

Reference	Description	Reference	Description
60000017	BOLT D-931 20*75 8.8	62000020	PIN D-94 4*40 ZINC
60000028	BOLT D-931 1"*90 SAE 8.8	85008900	BEAM FRBV/FB
60000046	BOLT D-933 10* 25 8.8 ZINC	85014900	SHORT SPRING BRACKET LEFT
60000051	BOLT D-933 10*50 8.8 ZINC	85015900	SPRING BRACKET SHORT RIGTH
60000052	BOLT D-931 10*55 10.9 ZINC	85016900	SPRING BRACKET LONG LEFT
60000065	BOLT D-931 12*55 10.9 ZINC	85017900	SPRING BRACKET LONG RIGTH
60000067	BOLT D-931 12*70 8.8 ZINC	85025900	GENERAL SPACER BUSH D=20/30*37/16,5*50 mm FB
60000081	BOLT D-931 16*70 8.8 ZINC	85026900	SPACER BUSH D=20/30*25/16,5*50 mm FB
60000082	BOLT D-931 16*80 8.8	85027900	UPPER SPACER BUSH D=20/30*38,5/16,5*51,1 mm FB
60000102	BOLT D-931 20*80 8.8	85027901	SPACER 20*57 mm
60000138	SELF LOCK NUT D-980 1" SAE 10.9 ZINC	85041900	SPRING BENT PIN
60000140	SELF LOCK. NUT D-980 10 8.8 ZINC	85047900	ADJUSTMENT HEXAGONAL SPACER FB/SUBSOL
60000142	SELF LOCK NUT D-980 12 8.8 ZINC	85057900	SPRING ADJUST. SUPPORT ZINC
60000146	SELF LOCK NUT D-980 20 10.9 ZINC	85058900	SPRING ADJUST. BOLT (22*80)
60000156	NUT D-934 10 8.8 ZINC	90039910	MASTER GREEN LEAF RAL-6029
60000157	NUT D-934 12 8.8 ZINC	90040910	GREEN LEAF NO 1 RAL-6029
60000160	NUT D-934 16 8.8 ZINC	90041910	GREEN LEAF NO. 2 RAL-6029
60000163	NUT D-934 20 8.8 ZINC	90042910	GREEN LEAF NO 3 RAL-6029
61000007	WASHER D-9021 10 ZINC	90043910	GREEN LEAF DISC RAL-6029
61000008	WASHER D-125 12 ZINC	99005950	BEAM PLATE FBN
61000010	WASHER D-125 16 ZINC		

DISC COULTERS

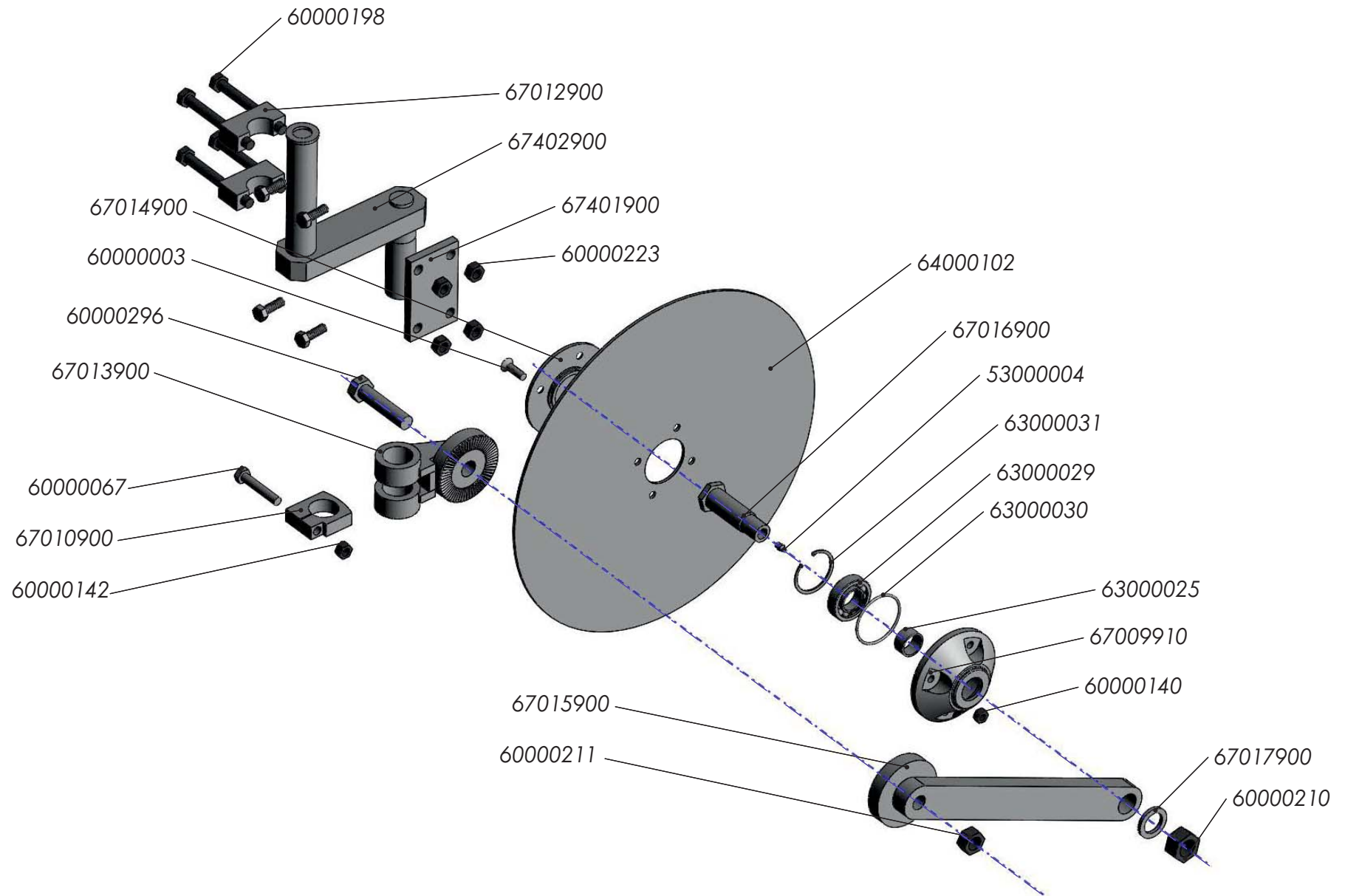

DISC COULTERS

Reference	Description	Reference	Description
53000004	GREASER MT-503 8*125 D-71412	63000031	ELASTIC RING D-472 62
60000003	ALLEN BOLT D-7991 10*40 10.9 ZINC	64000102	DISC COULTER ED 5 1983-20" R-68
60000067	BOLT D-931 12*70 8.8 ZINC	67009910	20" DISC HUB
60000140	SELF LOCK. NUT D-980 10 8.8 ZINC	67010900	ADJUSTMENT PLATE
60000142	SELF LOCK NUT D-980 12 8.8 ZINC	67012900	LOCK U-BOLT ZINC
60000198	BOLT D-931 14*130 8.8 ZINZ	67013900	TURN SUPPORT 20" DISC
60000210	SELF LOCK NUT D-985 1" SAE 8.8	67014900	DISC CAP
60000211	SELF LOCK NUT D-985 20 8.8	67015900	20" DISC ARM
60000223	SELF LOCK. NUT D-980 14 8.8	67016900	SHAFT 20" DISCS
60000296	BOLT D-931 20*90 8.8 ZINC	67017900	WASHER 20" DISC SHAFT
63000025	INSIDE RING 30*35*17	67401900	DISCS SUPPORT FRBV/FB
63000029	BEARING 3206	67402900	HANDLE FRBV/FB
63000030	OIL SEAL 35-52-7		

NON STOP DISC COULTERS

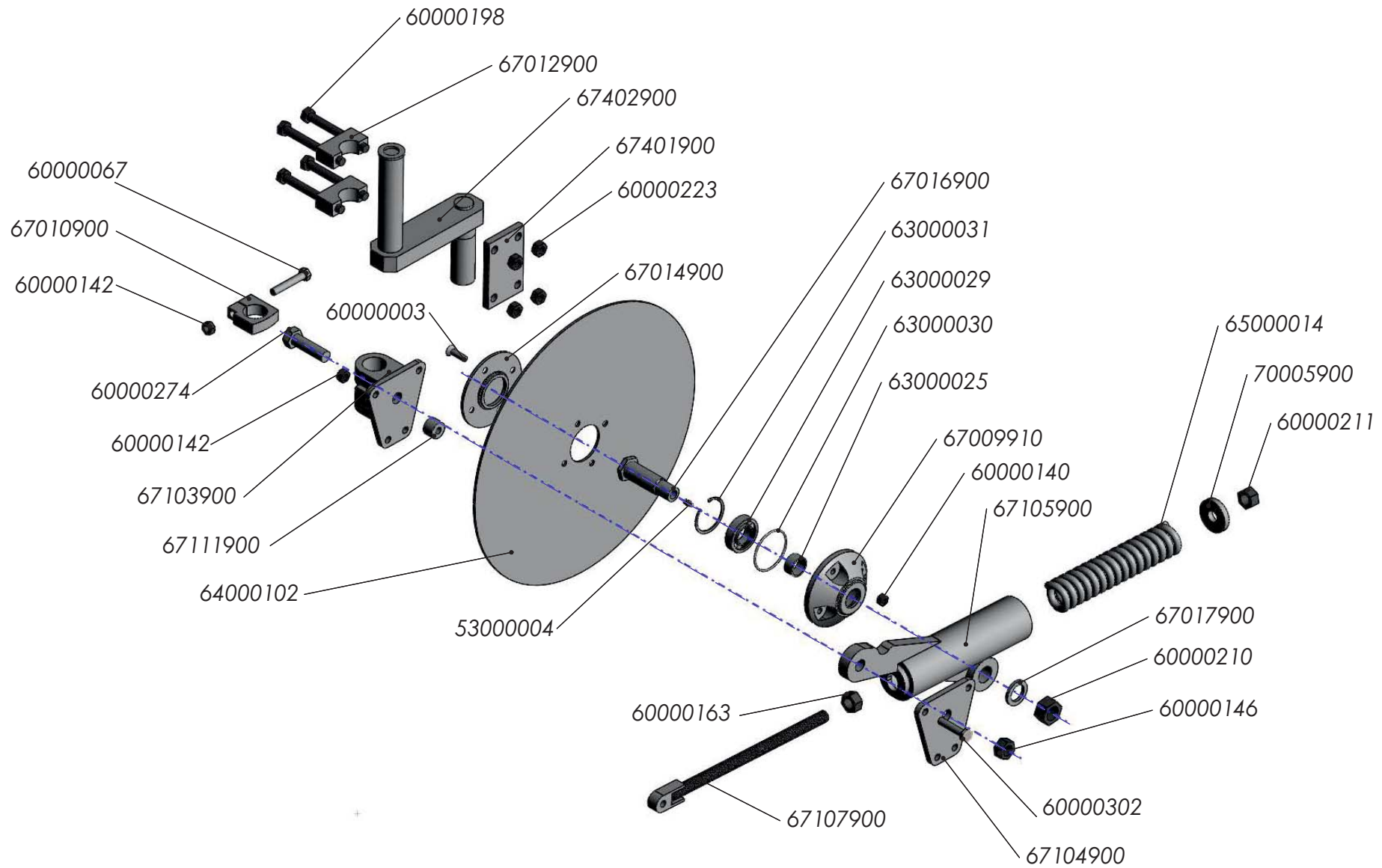

NON STOP DISC COULTERS

Reference	Description	Reference	Description
53000004	GREASER MT-503 8*125 D-71412	64000102	DISC COULTER ED 5 1983-20" R-68
60000003	ALLEN BOLT D-7991 10*40 10.9 ZINC	65000014	COMPRESSION CYLINDER SPRING 275*57*12
60000067	BOLT D-931 12*70 8.8 ZINC	67009910	20" DISC HUB
60000140	SELF LOCK. NUT D-980 10 8.8 ZINC	67010900	ADJUSTMENT PLATE
60000142	SELF LOCK NUT D-980 12 8.8 ZINC	67012900	LOCK U-BOLT ZINC
60000146	SELF LOCK NUT D-980 20 10.9 ZINC	67014900	DISC CAP
60000163	NUT D-934 22/150 8.8	67016900	SHAFT 20" DISCS
60000198	BOLT D-931 14*130 8.8 ZINZ	67017900	WASHER 20" DISC SHAFT
60000210	SELF LOCK NUT D-985 1" SAE 8.8	67103900	SPRING-LOADED DISC TURN
60000211	SELF LOCK NUT D-985 20 8.8	67104900	PLATE TURN SUPPORT SP.LOADED DISC
60000223	SELF LOCK. NUT D-980 14 8.8	67105900	SPRING-LOAD. DISC ARM
60000274	BOLT D-931 20*70 8.8 ZINC	67107900	SPRING-LOADED DISC ROD
60000302	BOLT D-931 12*55 8.8	67111900	SPACER SP.-LOADED DISC TURN
63000025	INSIDE RING 30*35*17	67401900	DISCS SUPPORT FRBV/FB
63000029	BEARING 3206	67402900	HANDLE FRBV/FB
63000030	OIL SEAL 35-52-7	70005900	REINF. WASHER 58*21 E-10mm
63000031	ELASTIC RING D-472 62		

VARYWIDTH SYSTEM

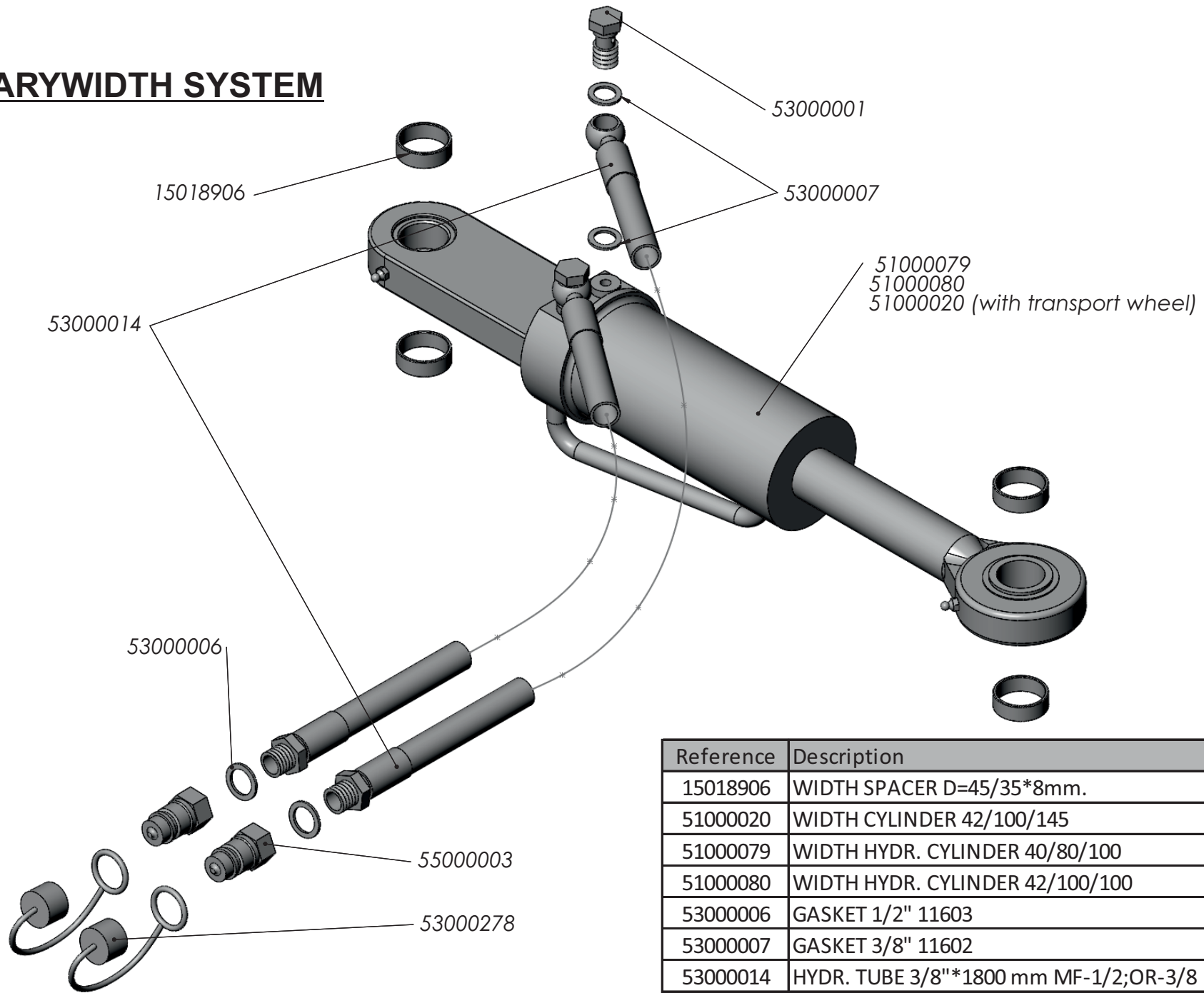

Reference	Description
15018906	WIDTH SPACER D=45/35*8mm.
51000020	WIDTH CYLINDER 42/100/145
51000079	WIDTH HYDR. CYLINDER 40/80/100
51000080	WIDTH HYDR. CYLINDER 42/100/100
53000006	GASKET 1/2" 11603
53000007	GASKET 3/8" 11602
53000014	HYDR. TUBE 3/8"*1800 mm MF-1/2;OR-3/8
53000278	PLUG YELLOW CAP 1/2" 5029
55000003	MALE FAST COUPLING 1/2" 30410108

HYDRAULIC FIRST BODY ADJUSTMENT

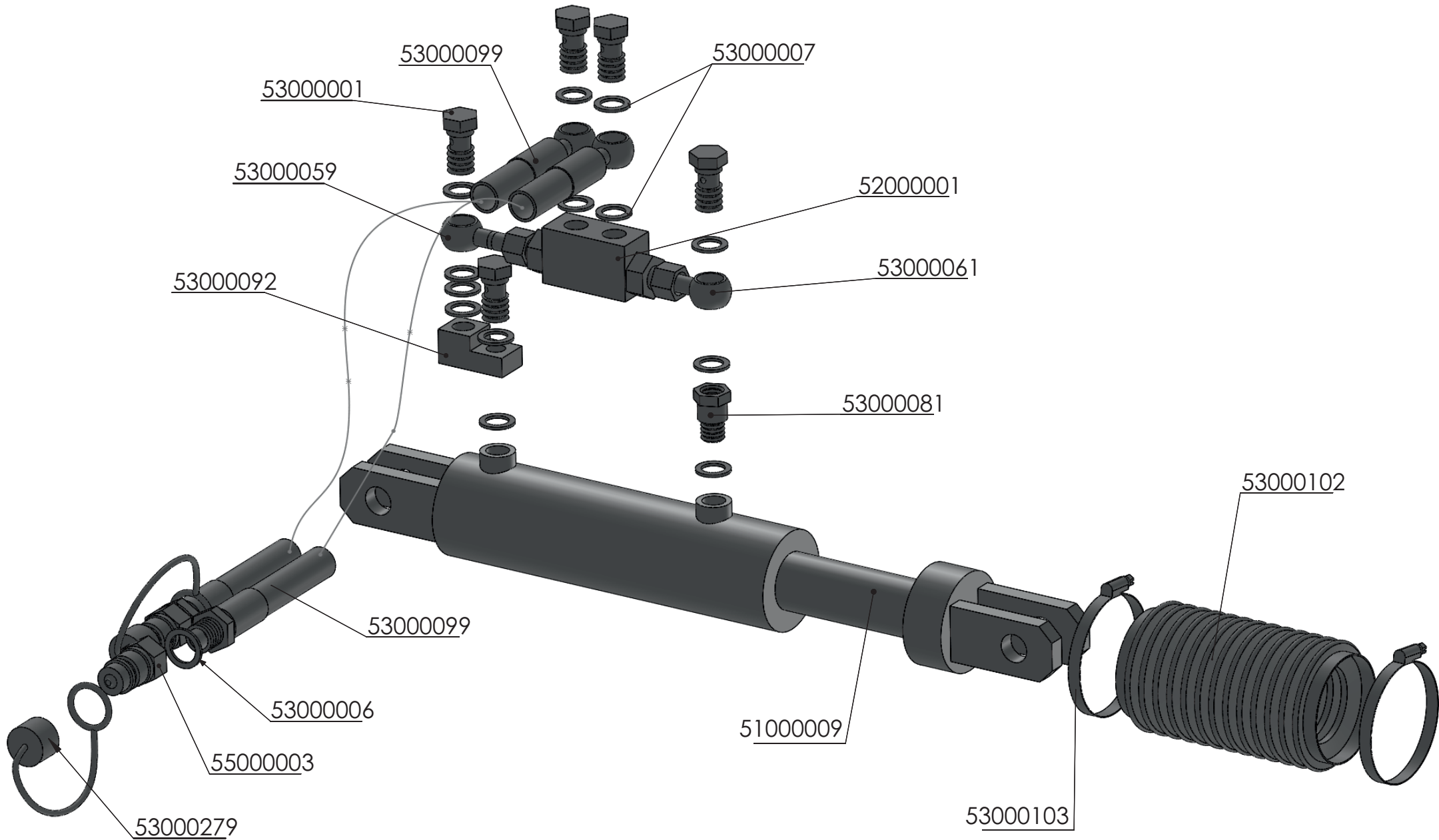

HYDRAULIC FIRST BODY ADJUSTMENT

Reference	Description
51000009	1ST FU. WIDTH CYLINDER 60/30/120
52000001	LOCKING VALVE 12 ZINC VBD38
53000001	BOLT 3/8 4022
53000006	GASKET 1/2" 11603
53000007	GASKET 3/8" 11602
53000059	NIPPLE 3/8" * 12mm SHORT 4002E
53000061	NIPPLE 3/8" 12mm LARGE
53000081	ENLARGEMENT 3/8" 4092
53000092	EXTENSION 1/4-3/8
53000099	HYDR. TUBE 3/8"*1500 mm MF-1/2;OR-3/8
53000102	RAM PROTECTION D=70 mm
53000103	HOLDER D=60/80
53000279	PLUG GREEN CAP 1/2" 5029
55000003	MALE FAST COUPLING 1/2" 30410108

TRASH BOARDS

V-40

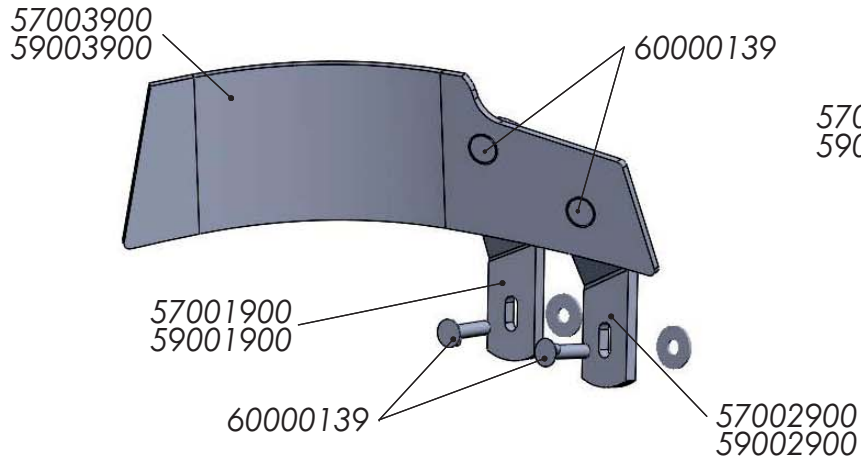

V-34 / V-74

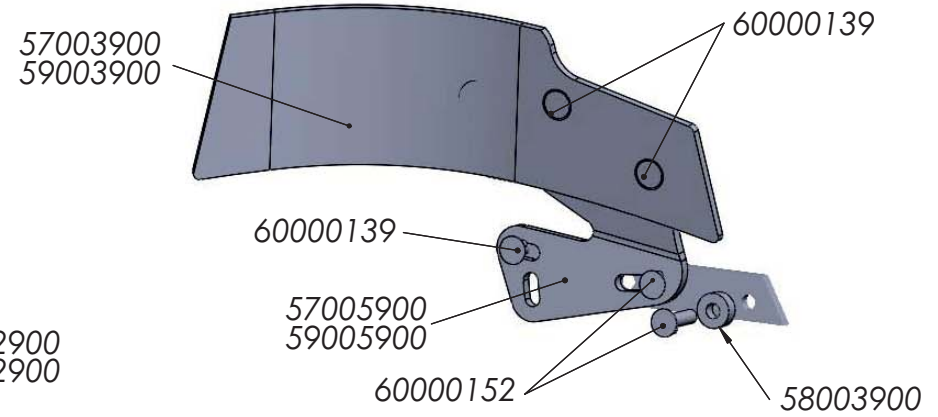

V-LOV

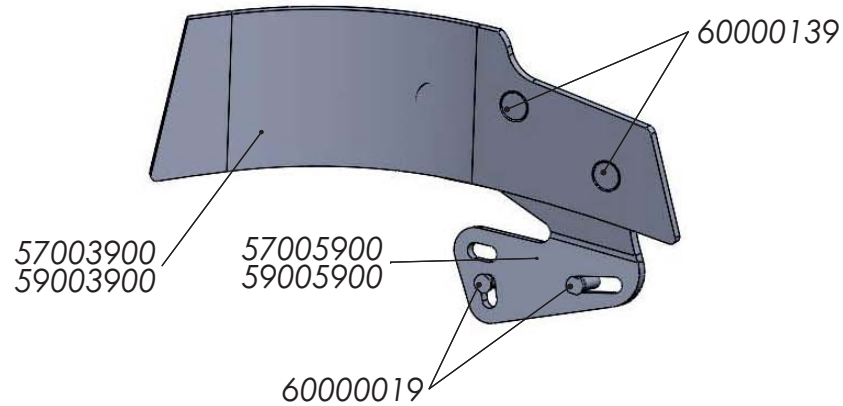

V-90 / V-97

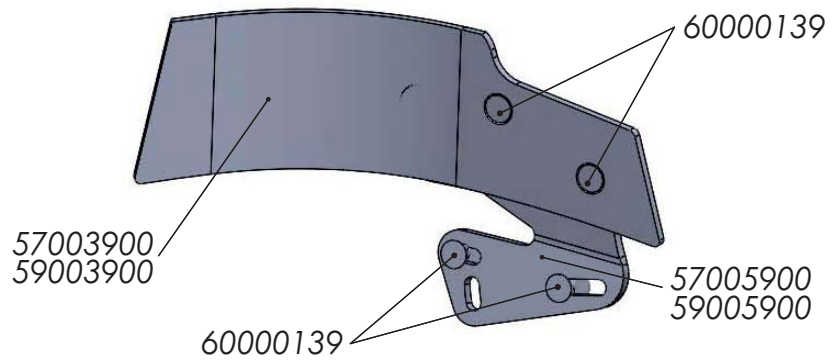

TRASH BOARDS

Reference	Description
57001900	REAR SUPP. TRASH B. V-40 RIGHT
57002900	FRONT SUPPORT TRASH B. V-40 RIGHT
57003900	TRASH BOARD 1856-RIGHT BORON
57005900	SUPP. RIGHT TRASH B. V-97 / V-34 / V-LOV)
58003900	BUSH D=30/13*12 mm SPACER SUPPORT V-34 ZINC
59001900	REAR SUPPORT TRASH B. V-40 LEFT
59002900	FRONT SUPPORT TRASH B. V-40 LEFT / REAR TRASH 1701
59003900	TRASH BOARD 1856-LEFT BORON
59005900	SUPP. LEFT TRASH B. V-97 / V-34 / V-LOV
60000019	PLOUGH BOLT 934 12*36 12.9
60000139	PLOUGH BOLT 934 12*35 8.8 ZINC
60000152	PLOUGH BOLT 934 12*45 8.8 ZINC

SKIMMERS

LARGE CAPACITY

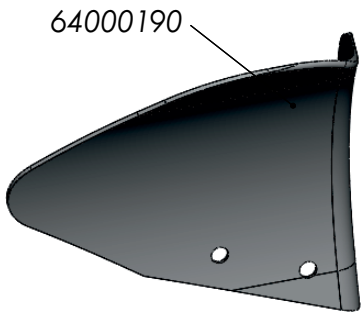

GRASS

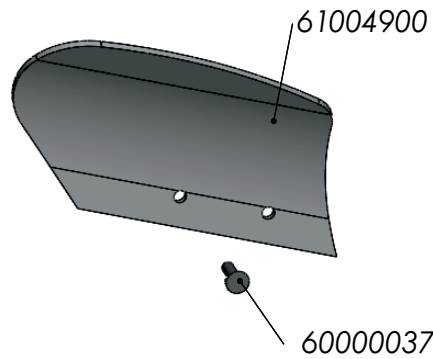

MAIZE

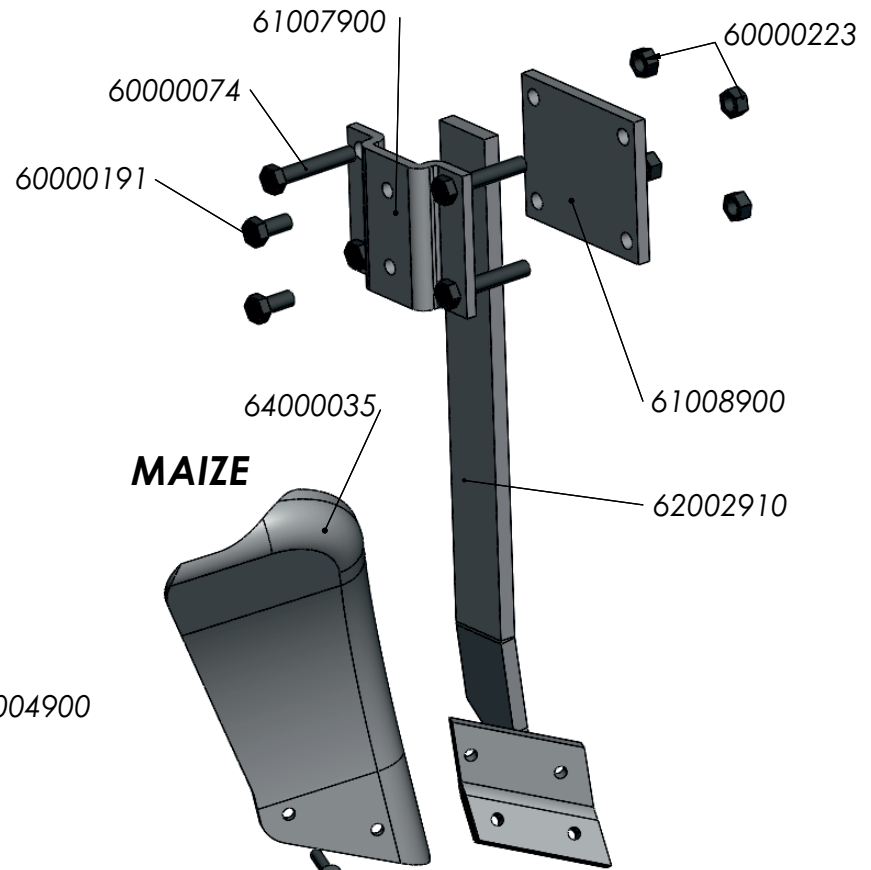
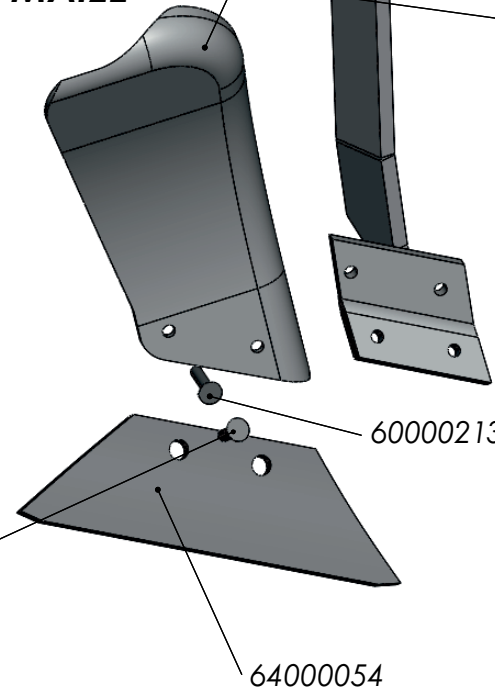

SKIMMERS

Reference	Description
60000037	PLOUGH BOLT 934 10*35 10.9 ZINC
60000074	BOLT D-931 14*80 8.8 ZINC
60000191	BOLT D-933 14*30 8.8 ZINC
60000213	PLOUGH BOLT 10*45 10.9 ZINC
60000223	SELF LOCK. NUT D-980 14 8.8 ZINC
61004900	RIGHT GRASS SKIM. 1855 BORON
61007900	OUTER SUPPORT SKIMMERS FB
61008900	INSIDE SUPPORT SKIMMERS FB
62002910	SKIMMER ARM FB
64000035	RIGHT MAIZE SKIM. 1820 BORON
64000054	SKIM. SHARE 1394 RH
64000190	RIGHT SKIM 1705 BORON

BODIES V-34 / V-74 / V-90 / V-97

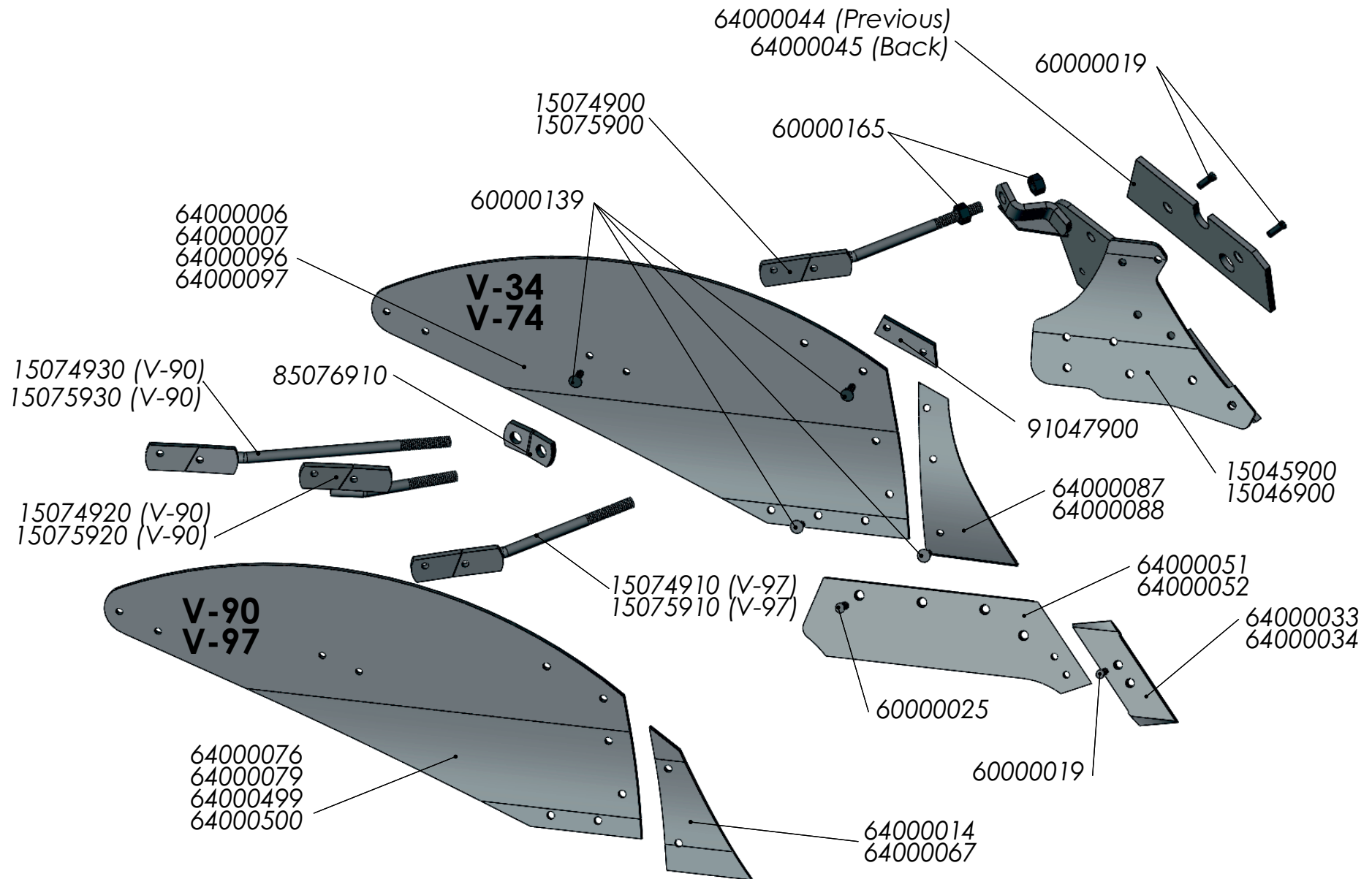

BODIES V-34 / V-74 / V-90 / V-97

Reference	Description	Reference	Description
15045900	RIGHT FROG V-97 / V-34	64000033	SHARE POINT 1365-RIGHT 65x12 mm
15046900	LEFT FROG V-97 / V-34	64000034	SHARE POINT 1365-LEFT 65x12 mm
15074900	V-34 SHORT STAY RIGHT	64000044	SHORT LANDSLIDE 2338-CAV-BAR
15074910	V-97 SHORT STAY RIGHT	64000045	LONG LANDSLIDE 2339-CAV-BAR
15074920	V-90 SHORT STAY RIGHT	64000051	SHARE V-34-17 RIGHT-CAV
15074930	V-90 LONG STAY RIGHT	64000052	SHARE V-34-17 LEFT-CAV
15075900	V-34 SHORT STAY LEFT	64000067	SHIN 1798-LEFT BORON
15075910	V-97 SHORT STAY LEFT	64000076	MOULDBOARD V-97-RIGHT LAMIN.
15075920	V-90 SHORT STAY LEFT	64000079	MOULDBOARD V-97-LEFT LAMIN.
15075930	V-90 LONG STAY LEFT	64000087	SHIN 1849-RIGHT BORON
60000019	PLOUGH BOLT 934 12*36 12.9	64000088	SHIN 1849-LEFT BORON
60000025	PLOUGH BOLT 934 14*35 12.9	64000096	MOULDBOARD V-74-RIGHT BORON
60000139	PLOUGH BOLT 934 12*35 8.8 ZINC	64000097	MOULDBOARD V-74-LEFT BORON
60000165	NUT D-934 22 8.8 ZINC	64000499	MOULDBOARD V-90-RIGHT LAMIN.
64000006	MOULDBOARD V-34-RIGHT LAMIN.	64000500	MOULDBOARD V-90-LEFT LAMIN.
64000007	MOULDBOARD V-34-LEFT LAMIN.	85076910	V-90 LONG STAY SUPPORT
64000014	SHIN 1798-RIGHT BORON CAV	91047900	CONNECT. PLATE BOARD/SHIN V-34

BODY V-40

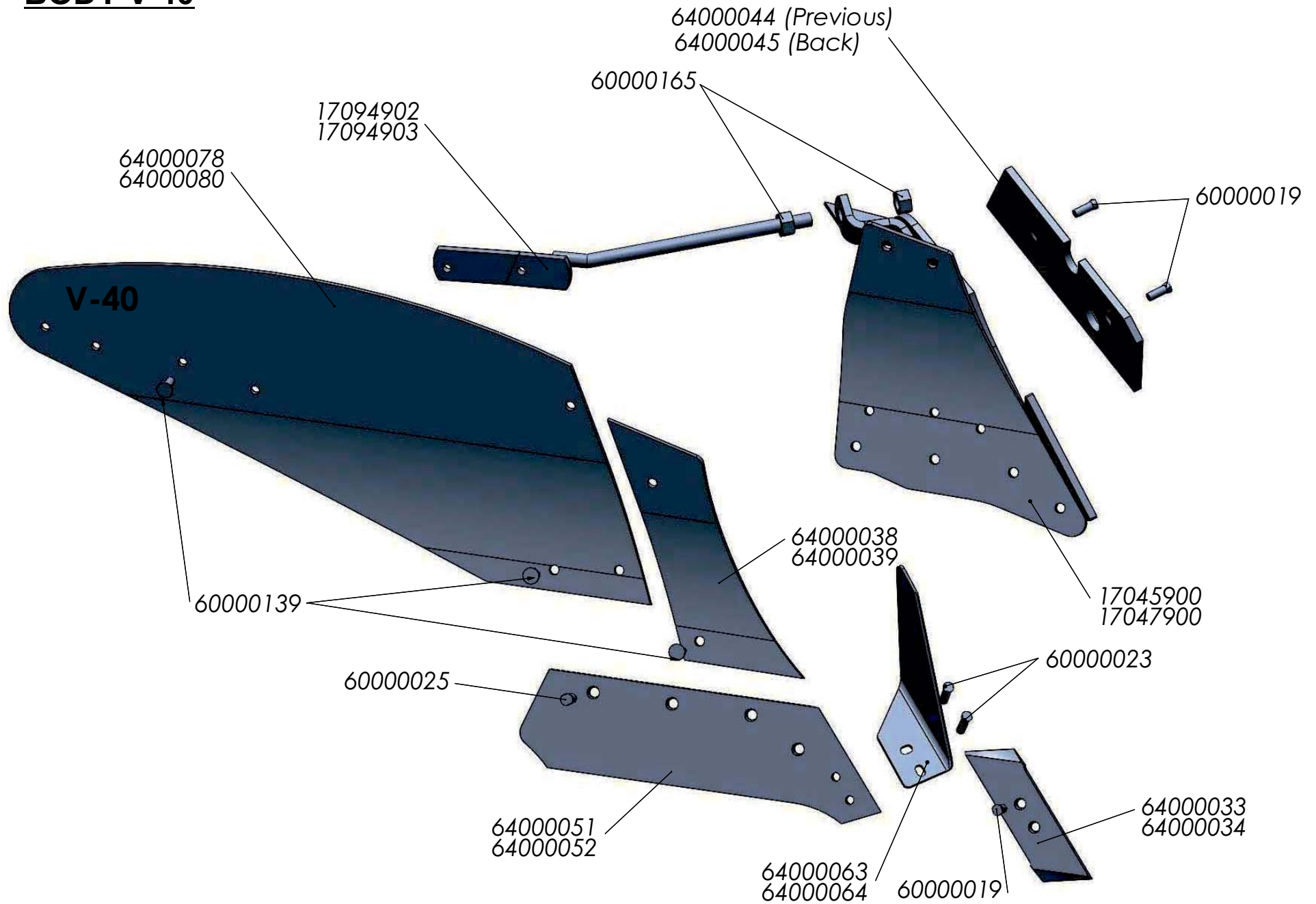

BODY V-40

Reference	Description
17045900	RIGHT FROG V-40
17047900	LEFT FROG V-40
17094902	V-40 SHORT STAY RIGHT
17094903	V-40 SHORT STAY LEFT
60000019	PLOUGH BOLT 934 12*36 12.9
60000023	PLOUGH BOLT 934 12*42 12.9
60000025	PLOUGH BOLT 934 14*35 12.9
60000139	PLOUGH BOLT 934 12*35 8.8 ZINC
60000165	NUT D-934 22 8.8 ZINC
64000033	SHARE POINT 1365-RIGHT 65x12 mm
64000034	SHARE POINT 1365-LEFT 65x12 mm
64000038	SHIN 1839-RIGHT BORON
64000039	SHIN 1839-LEFT BORON
64000044	SHORT LANDSLIDE 2338-CAV-BAR
64000045	LONG LANDSLIDE 2339-CAV-BAR
64000051	SHARE V-34-17 RIGHT-CAV
64000052	SHARE V-34-17 LEFT-CAV
64000063	SHARE KNIFE 1464-RIGHT
64000064	SHARE KNIFE 1464-LEFT
64000078	MOULDBOARD V-40-RIGHT LAMIN.
64000080	MOULDBOARD V-40-LEFT LAMIN.

BODY LOV (SLATTED)

POINTS :

en 20 mm

A: 60000465
B: 60000014

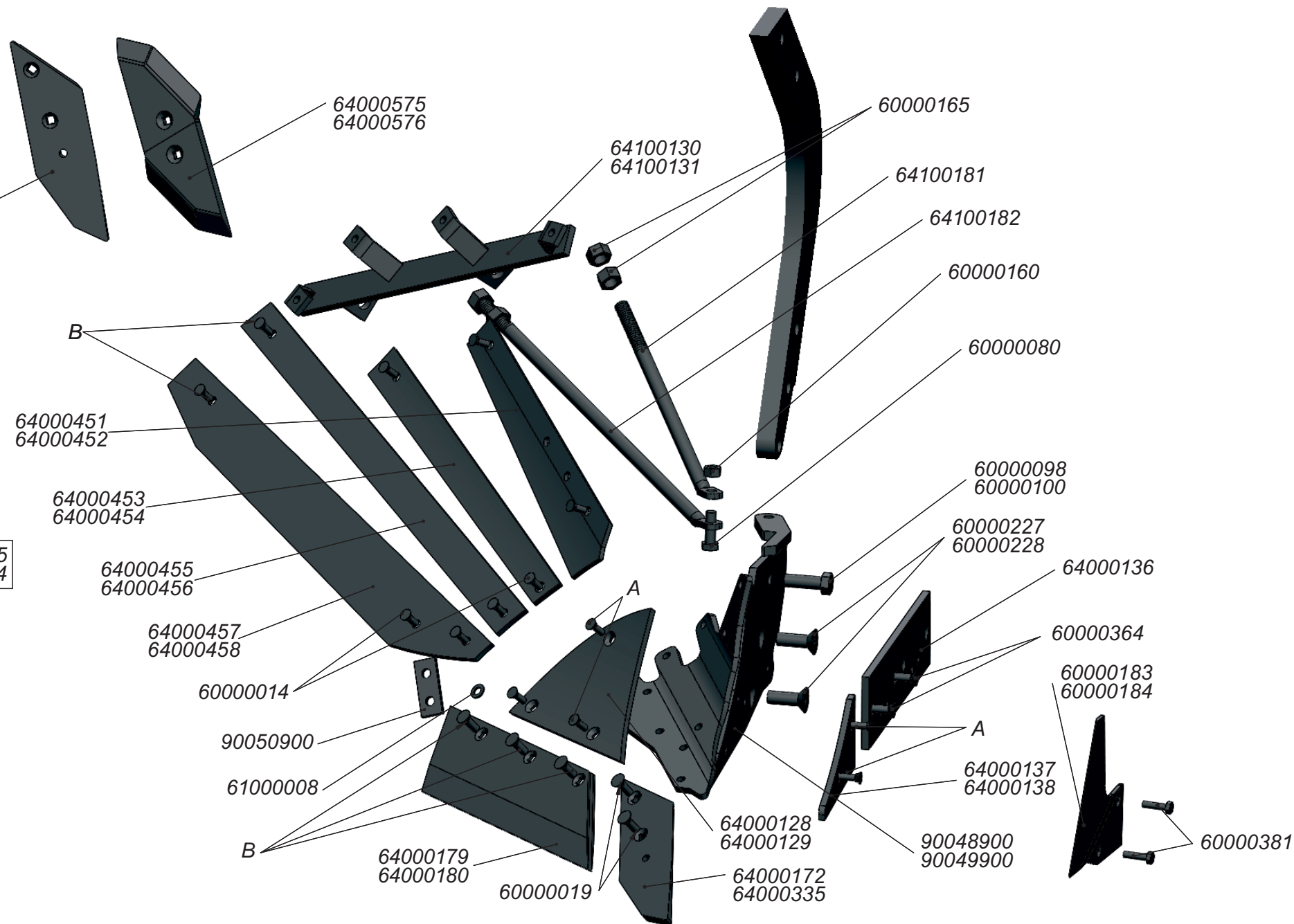

BODY LOV (SLATTED)

Reference	Description	Reference	Description
60000014	PLOUGH BOLT 12*33 12.9	64000183	SHARE KNIFE RIGHT-LK 3492890
60000019	PLOUGH BOLT 934 12*36 12.9	64000184	SHARE KNIFE LEFT-LK 3492891
60000080	BOLT D-931 16*60 8.8 ZINC	64000335	SHARE POINT LEFT 15 mm
60000098	BOLT D-931 20*60 8.8	64000451	SLAT 1-RIGHT
60000100	BOLT D-931 20*70 8.8	64000452	SLAT 1-LEFT
60000160	NUT D-934 16 8.8 ZINC	64000453	SLAT 2-RIGHT
60000165	NUT D-934 22 8.8 ZINC	64000454	SLAT 2-LEFT
60000227	ALLEN BOLT D-7991 20*60 10.9	64000455	SLAT 3-RIGHT
60000228	ALLEN BOLT D-7991 20*70 10.9	64000456	SLAT 3-LEFT
60000381	PLOUGH BOLT D-608/934 10*40 8.8	64000457	SLAT 4-RIGHT
60000465	PLOUGH BOLT 934 10*33 12.9	64000458	SLAT 4-LEFT
61000008	WASHER D-125 12 ZINC	64000575	SHARE POINT RIGHT REVERS.
64000128	SHIN RIGHT	64000576	SHARE POINT LEFT REVERS.
64000129	SHIN LEFT	64100130	SUPPORT WITH STAYS RIGHT SLATTED
64000136	LANDSLIDE RIGHT/LEFT	64100131	SUPPORT WITH STAYS LEFT SLATTED
64000137	LANDSLIDE POINT RIGHT	64100181	SHORT STAY SLATT.MOULDB.
64000138	LANDSLIDE POINT LEFT	64100182	LONG STAY SLATT.MOULDB.
64000172	SHARE POINT RIGHT 15 mm	90048900	PLOUGH BODY SLATTED RIGHT
64000179	SHARE 20" RIGHT	90049900	PLOUGH BODY SLATTED LEFT
64000180	SHARE 20" LEFT	90050900	CONNECT.PLATE BOARD/SHARE SLATTED

METALIC / PNEUMATIC WHEEL

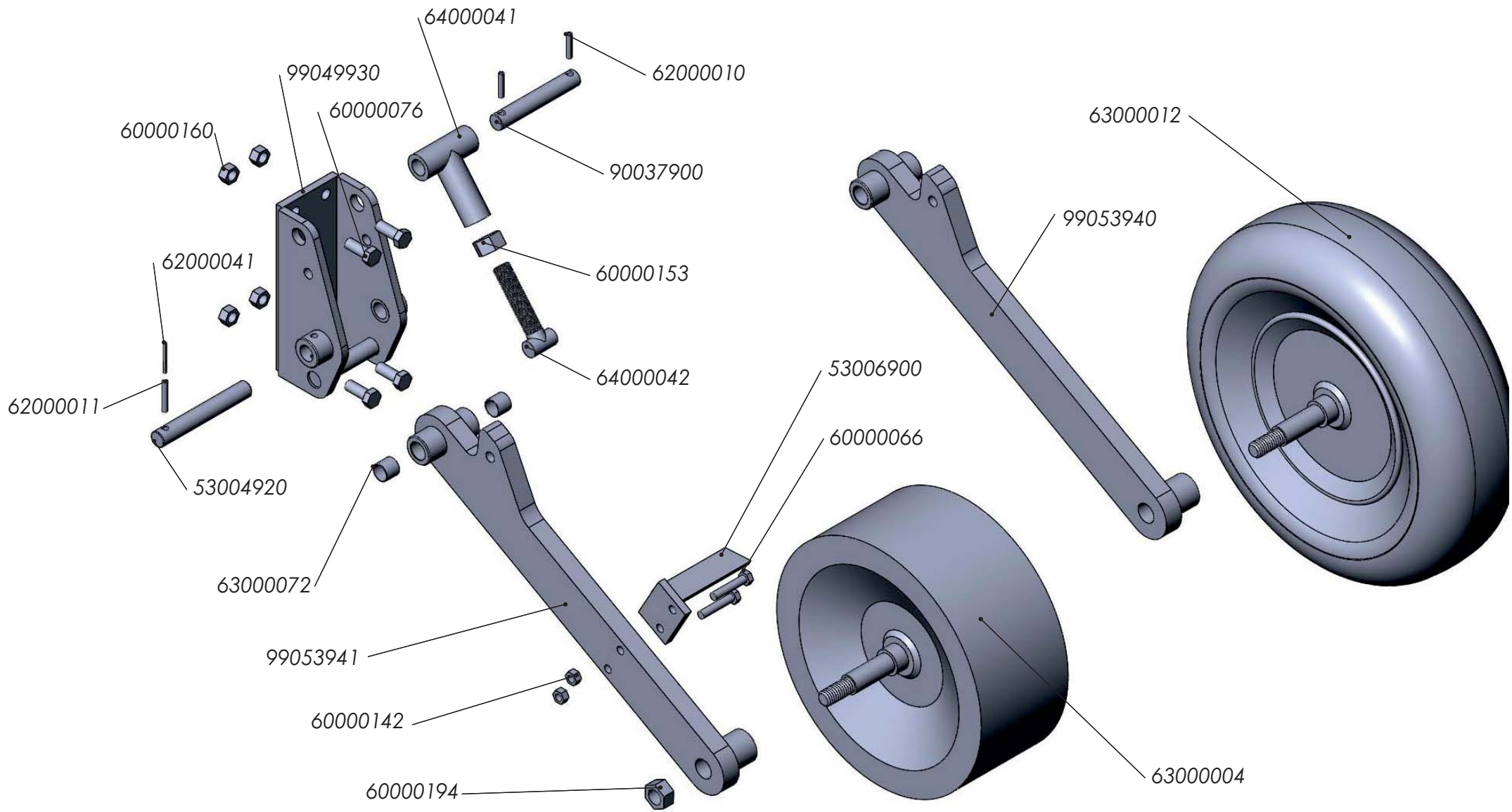

METALIC / PNEUMATIC WHEEL

Reference	Description
53004920	PIN D=25*175 mm WHEEL ARM
53006900	WHEEL SCRAPER
60000066	BOLT D-931 12*60 8.8 ZINC
60000076	BOLT D-933 16*40 8.8 ZINC
60000142	SELF LOCK NUT D-980 12 8.8 ZINC
60000153	NUT D-934 1" SAE 8.8 ZINC
60000160	NUT D-934 16 8.8 ZINC
60000194	SELF LOCK. NUT D-980 24/200 8.8
62000010	ELASTIC PIN D-1481 8*40 ZINC
62000011	ELASTIC PIN D-1481 8*50 ZINC
62000041	ELASTIC PIN DIN-1481 5*50
63000004	METAL WHEEL 400*170*3
63000012	RUBBER WHEEL 6.00*9"-10 PR
63000072	BUSH PAP 2525 P10
64000041	DEPTH STOP SUPPORT ZINC
64000042	DEPTH STOP TREATY + ZINC
90037900	PIN D=25*154 mm WHEEL STOPPER
99049930	BRACKET WHEEL FB (D/04)
99053940	ARM RUBBER WHEEL FB/FF (D/04)
99053941	ARM METALLIC WHEEL FB/FF (D/04)

WHEEL CONTROL 608

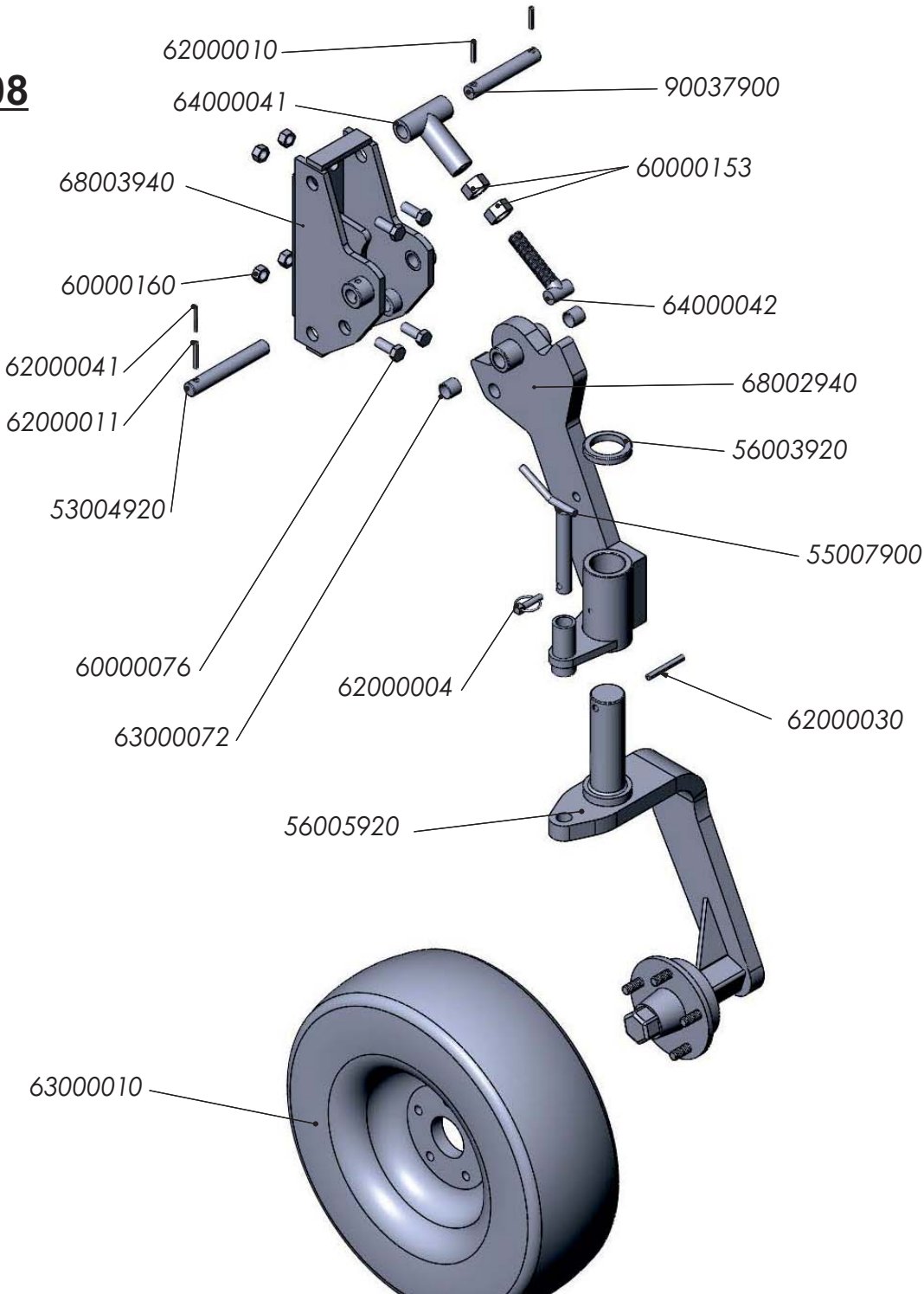

WHEEL CONTROL 608

Reference	Description
53004920	PIN D=25*175 mm WHEEL ARM
55007900	TRANSPORT PIN D=25*160 mm
56003920	AXLE WHEEL WASHER
56005920	TRANSPORT WHEEL FORK (608*205)
60000076	BOLT D-933 16*40 8.8 ZINC
60000153	NUT D-934 1" SAE 8.8 ZINC
60000160	NUT D-934 16 8.8 ZINC
62000004	RING SPLIT PIN 10 ZINC
62000010	ELASTIC PIN D-1481 8*40 ZINC
62000011	ELASTIC PIN D-1481 8*50 ZINC
62000030	ELASTIC PIN D-1481 10*80 ZINC
62000041	ELASTIC PIN DIN-1481 5*50
63000010	RUBBER WHEEL 14,5"*200/60-10PR
63000072	BUSH PAP 2525 P10
64000041	DEPTH STOP SUPPORT ZINC
64000042	DEPTH STOP TREATY + ZINC
68002940	TRANSPORT WHEEL SUPPORT FB (D/05)
68003940	TRANSPORT WHEEL ARM FB (D/05)
90037900	PIN D=25*154 mm WHEEL STOPPER

HYDRAULIC WHEEL

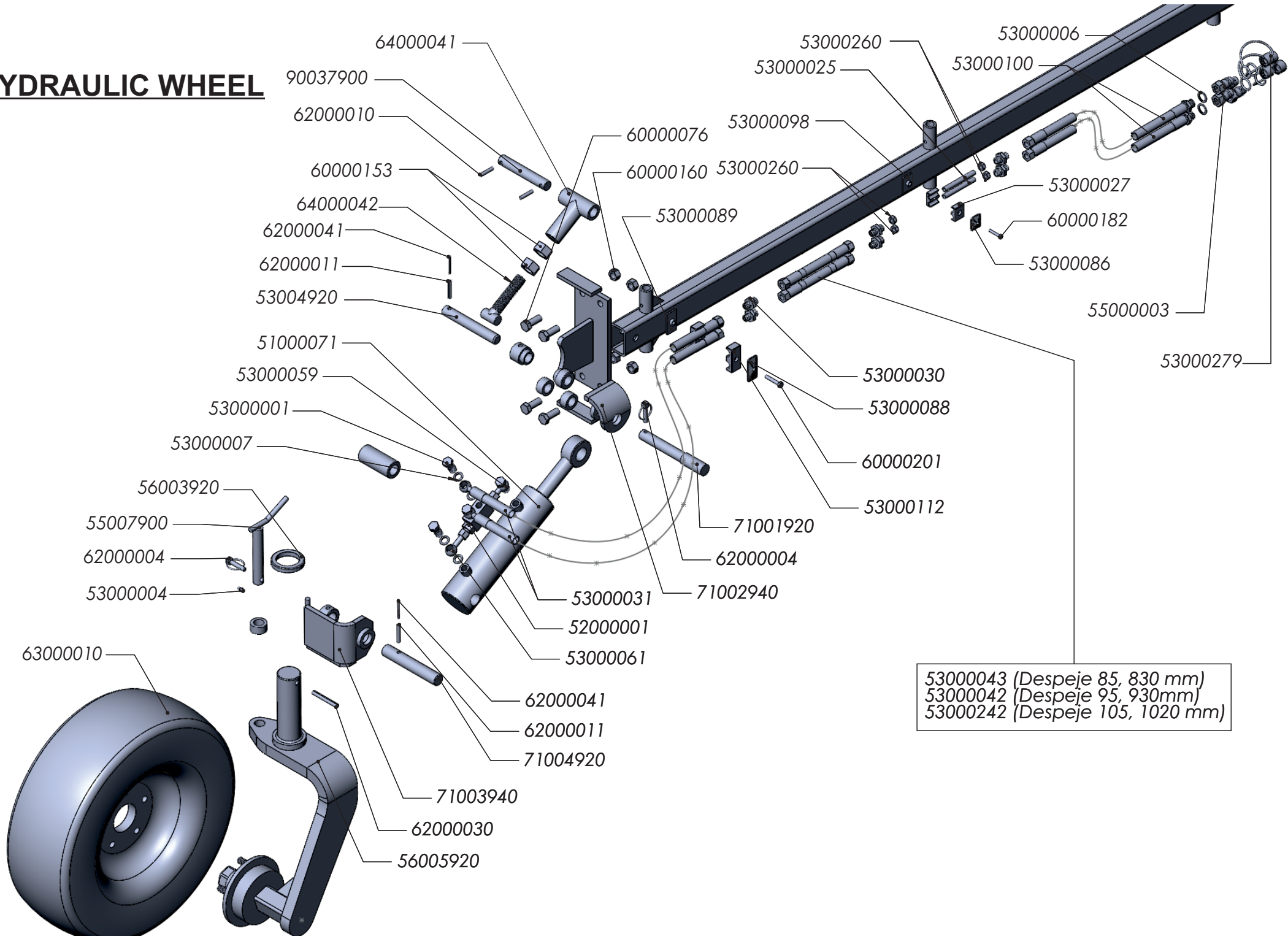

HYDRAULIC WHEEL

Reference	Description	Reference	Description
51000071	WHEEL CYLINDER 40/80/160 FB RAL-6029	53004920	PIN D=25*175 mm WHEEL ARM
52000001	LOCKING VALVE 12 ZINC VBD38	55000003	MALE FAST COUPLING 1/2" 30410108
53000001	BOLT 3/8 4022	55007900	TRANSPORT PIN D=25*160 mm
53000004	GREASER MT-503 8*125 D-71412	56003920	AXLE WHEEL WASHER
53000006	GASKET 1/2" 11603	56005920	TRANSPORT WHEEL FORK (608*205)
53000007	GASKET 3/8" 11602	60000076	BOLT D-933 16*40 8.8 ZINC
53000025	METRE STEEL TUBE 12*9 mm ZINC	60000153	NUT D-934 1" SAE 8.8 ZINC
53000027	DOUBLE STIRRUP D=12 mm 1D12PP	60000160	NUT D-934 16 8.8 ZINC
53000030	TUBE/TUBE COUPLING 12mm G12-L	60000182	BOLT D-933 6*35 8.8 ZINC
53000031	HYDR. TUBE 3/8" 1300 mm OR-3/8; TL-18	60000201	BOLT D-931 8*50 8.8 ZINC
53000042	HYDR. TUBE 3/8*930mm TL-18; TL-18	62000004	RING SPLIT PIN 10 ZINC
53000043	HYDR. TUBE 3/8" 830mm TL-18; TL-18	62000010	ELASTIC PIN D-1481 8*40 ZINC
53000059	NIPPLE 3/8" * 12mm SHORT 4002E	62000011	ELASTIC PIN D-1481 8*50 ZINC
53000061	NIPPLE 3/8" 12mm LARGE	62000030	ELASTIC PIN D-1481 10*80 ZINC
53000086	REINFORCEMENT PLATE 12 GD1D	62000041	ELASTIC PIN DIN-1481 5*50
53000088	REINFORCEMENT PLATE 20 GD3D	63000010	RUBBER WHEEL 14,5"*200/60-10PR
53000089	PLATE 20 SP3D	64000041	DEPTH STOP SUPPORT ZINC
53000098	PLATE 12 SP1D	64000042	DEPTH STOP TREATY + ZINC
53000100	HYDR. TUBE 3/8*1800mm E-12; MF-1/2	71001920	WHEEL STOP PIN D=29,7/25*210 mm
53000112	DOUBLE STIRRUP D=20mm 1D20PP	71002940	CONT/TRANSP.WHEEL BRACKET
53000242	HYDR. TUBE 3/8*1020mm TL-18; TL-18	71003940	HYDR.TRANSPORT WHEEL ARM
53000260	NUT M18*1,5 BICONE D12L	71004920	PIN 29,7*177mm WHEEL CYLIND.
53000279	PLUG GREEN CAP 1/2" 5029-4PG	90037900	PIN D=25*154 mm WHEEL STOPPER



ovlac

FACTORY AND ADMINISTRATION
OVLAC Fabricación de Maquinaria Agrícola, S.A.
Polígono Industrial, C/ TAF , P-163
34200 – Venta de Baños (Palencia)
SPAIN
Phone: + 34 979 76 10 11
Fax: + 34 979 76 10 22
E-mail: fabricacion@ovlac.com