

# EURODISC

REV JUL-2021



INSTRUCTIONS AND SPARE PARTS MANUAL



# CONGRATULATIONS!

You have just acquired an Ovlac Eurodisc!

As Spain's largest producer of agricultural machinery for soil tillage, we feel honoured that you have chosen Ovlac as your trusted choice.

After many years of experience in the field, we make sure that you will be proud of your purchase in the same way that we are proud of the product we have created under the strictest quality standards.

For the correct use and enjoyment of this equipment, we strongly recommend that the customer read the instructions contained in this manual and use it as a reference for any questions that may arise regarding the operation of your Ovlac equipment.

Sincerely yours: Jorge Calvo  
CEO of Ovlac



# CONSIDERATIONS

This instruction manual describes the Operating and Maintenance Instructions and Spare Parts for the indicated equipment.

This agricultural equipment, called **EURODISC**, is designed for tilling the soil, applied to a Tractor with lifting gear and universal threepoint linkage.

The proper functioning of the machine depends on its correct use. It is therefore advisable to read the instructions given in this manual carefully in order to avoid any inconvenience that could impair the proper functioning and durability of the machine.

It is also important to follow the instructions in the manual, as the Manufacturer declines all responsibility for negligence and non-observance of these instructions.

The Manufacturer is at your disposal to guarantee immediate and accurate technical assistance and to provide all that may be necessary for a better functioning and performance of the machine.

The Manufacturer reserves the right to modify the Machine without the need to urgently update this publication.



# INDEX

- 1.- Security Rules
- 2.- Description and technical data
- 3.- NON STOP Security Systems
- 4.- Turn up
  - 4.1.- Adaptation to the tractor
  - 4.2.- Alignment
  - 4.3.- Other adjustments
- 5.- Working depth
- 6.- Transport and parking
  - 6.1.- Hydraulic functions
- 7.- Maintenance
- 8.- Optional equipment
- 9.- Spare parts



# 1.- Security Rules

Read carefully all the instructions for use of the cultivator.

The manufacturer declines all responsibility for any inconvenience caused by NOT observing the Safety and Accident Prevention Regulations described below.

- 1.- Pay attention to the danger and warning symbols shown in this manual and indicated on the equipment.
- 2.- Repairs and adjustments to the equipment must always be carried out with the engine stopped and the tractor locked.
- 3.- It is strictly forbidden to transport people or animals on the equipment.
- 4.- It is strictly forbidden to entrust the driving of the tractor, with the equipment hooked up, to people without a driving license, inexperienced, or who are not in good condition.
- 5.- Scrupulously observe all the accident prevention measures recommended and described in this manual.
- 6.- The application of additional equipment to the tractor implies a different weight distribution on the tractor axles.
- 7.- Before putting the tractor and the equipment into operation, check that all the safety elements for transport and use are in perfect condition.
- 8.- The symbols with warnings displayed on the equipment give the appropriate suggestions for the use of the same.
- 9.- To circulate on the road, it is necessary to observe the rules of circulation according to the country where it's operated.
- 10.- Respect the maximum weight foreseen on the tractor, the total mobile weight, the transport regulations and the road code.
- 11.- Before starting to work, familiarise yourself with the control devices.
- 12.- Pay the utmost attention to hitching and unhitching the equipment.
- 13.- Never leave the driving position when the tractor is in motion.
- 14.- Remember that road adherence, steering and braking capacity may vary significantly due to the presence of suspended equipment.
- 15.- It is strictly forbidden to remain in the area of action of the equipment.
- 16.- Before leaving the tractor, lower the suspended equipment, stop the engine, apply the parking brake, and remove the ignition key from the dashboard.
- 17.- The category of the hitch pins of the equipment must correspond to that of the linkage of the lift.
- 18.- Pay maximum attention when working in the area of the arms of the tractor, it is a very dangerous area.
- 19.- It is strictly forbidden to stand between the tractor and the equipment to manoeuvre the external lifting control.
- 20.- During road transport with the equipment suspended, put the control lever of the hydraulic lift in the locking position.
- 21.- The spare parts must correspond to the requirements defined by the Manufacturer. Always use original spare parts.
- 22.- The safety instruction decals must always be clearly visible. Clean and replace them if they are not legible (You can ask your dealer for them).
- 23.- The instruction manual must be kept for the whole life of the equipment.





## WARNING

Before starting to work, read the instructions in the manual.

## DANGER

Do not handle the equipment when it is suspended, danger of crushing. Maintain the safety distance.

## DANGER

Lifting the equipment can cause injuries due to reaching. Maintain the safety distance.

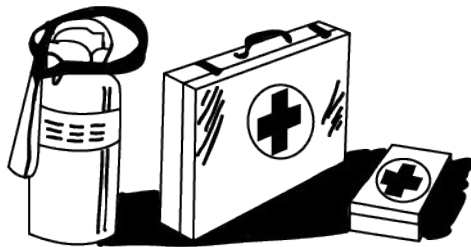

## To be ready in case of an emergency

Keep a first aid kit and fire extinguisher on hand. Write down the telephone numbers of doctors, ambulance and fire brigade and keep them near the phone.

## Use adequate clothes

Avoid loose clothing and use appropriate safety equipment depending on the type of work. Safe operation of the machine requires the full attention of the operator.

**Don't use headphones** for listening to the radio while working with the machine.

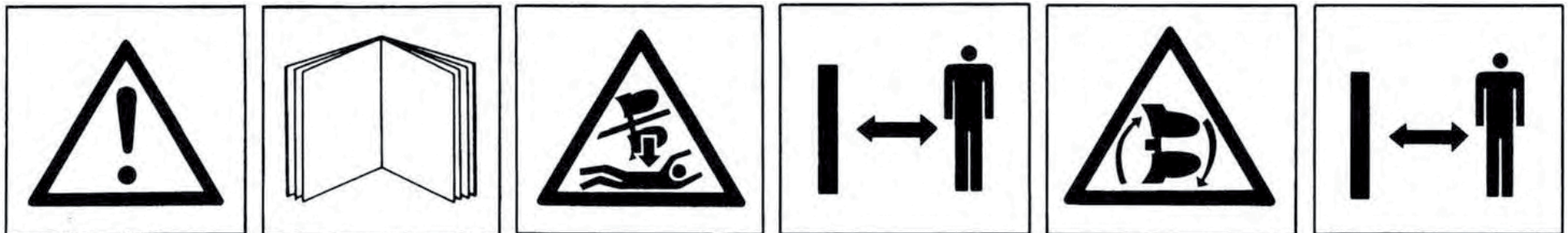

# SPECIFIC INSTRUCTIONS FOR WELDING REPAIRS

When repair by welding is authorised by the manufacturer, the following points shall be taken into account generally. In particular cases, appropriate welding instructions shall be provided for each application.

- 1** Repair welding should be carried out by qualified welders and in accordance with good technical and safety code practice.
- 2** Before welding repairs, remove paint, rust, dirt or any other substances harmful to the weld.
- 3** To avoid damage to mechanical or hydraulic components such as bearings, shafts, hydraulic actuators, hydraulic systems, etc., care should be taken to place the earth connection in an area of good contact, free of paint and rust.  
On machines with hydraulic cylinders, we must ensure that the welding current does not flow through such elements. For this purpose, the earth connection shall be placed on the same part of the machine to be repaired.

**4** Our machines are made of high elastic limit (HEL) steels, which means that special attention must be paid to welding processes and filler materials. In general, basic coated electrodes E7016 or E7018 will be used. For the MAG (semi-automatic) welding process, ER70S6 wire and Ar+20CO<sub>2</sub> will be used as shielding gas. In both cases, follow the recommendations for drying times and temperatures recommended by the manufacturers of the filler material.

**5** When the parts to be welded are thicker than 15 mm, or the ambient temperature is lower than 15 C, preheating by flame between 75-100 C is recommended.

**6** It is strictly forbidden to cool welding seams with water, air or any other substance.  
In case of questions during repair, please contact the manufacturer via the usual means of communication.



## 2.- Description and Technical Data

1. HEADSTOCK
2. IDENTIFICATION PLATE\*
3. CENTRAL FRAME
4. LATERAL FRAME
5. HYDRAULIC FOLDING SYSTEM
6. SECURITY SYSTEMS
7. BODY
8. DISC
9. ROLLERS

**Note:** the number of the plough's manufacture, engraved on the nameplate, must match the number engraved on the headstock's support.

\*2. IDENTIFICATION PLATE

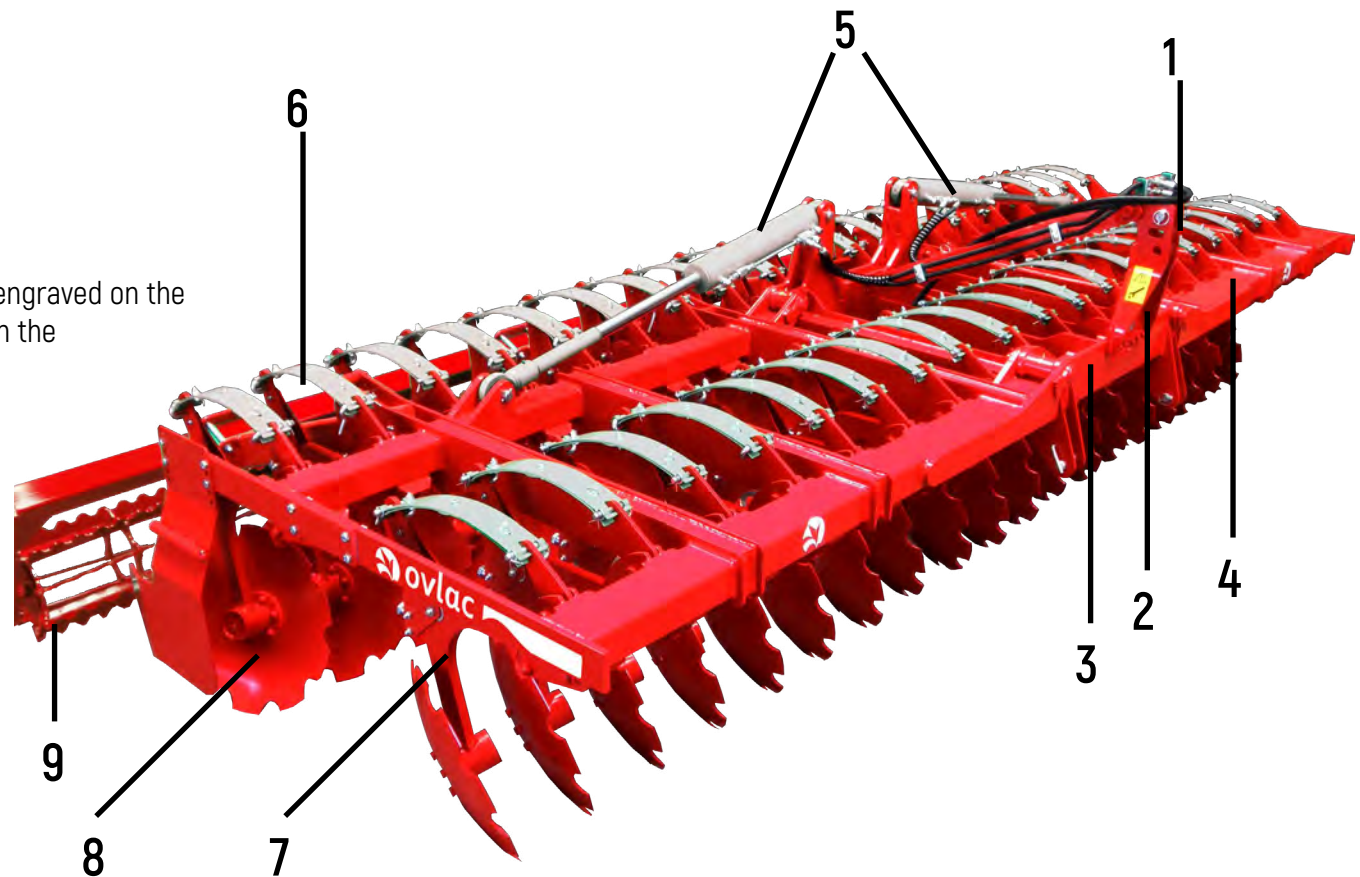

# Technical Data

<b>EURODISC</b>	DISCS	WORKING WIDTH (m)	TRANSPORT WIDTH (m)	POWER (HP)	WEIGHT (Kg) (*)
EURODISC 250	18	2,50	2,50	80-100	1.830
EURODISC 300	22	3,00	3,05	100-130	2.220
EURODISC 350	26	3,60	3,62	120-150	2.590
EURODISC 350P	26	3,60	3,00	120-150	2.790
EURODISC 400P	28	4,00	3,00	140-170	3.120
EURODISC 500P	36	5,00	3,00	160-200	3.910
EURODISC 550P	38	5,50	3,00	180-250	4.300

\* Weight with bars rollers.





# 3.- Non-Stop Security Systems

“Non-Stop” Leafspring security system acts automatically. When the share meets an obstacle, the systems gives up, elevating and saving the arm, getting back to its original position without stopping the tractor.

This way, every impact caued by uneven terrain will be absorbed by the security system, which protects the elements of the machine, and therefore, also the tractor.

For the same reason, Non-Stop security systems decreases the traction effort by avoiding the tractor HAVING TO OVERCOME every obstacle and having an uniform labor.

In the machines equipped with leafspring securiry system . the string of the bow that determinate the leafspring, must have a length of +- 500mm, measure as appears on Fig 2.

**Note:** OVLAC Non-Stop security system are factory-regulated withn an optimum pressure for midhardness terrains.



Fig. 2



# 4.- Turn up

## 4.1 - Adaptation to the tractor

**OVLAC** ploughs are designed to adapt to the 3 universal points of every tractor.

Before linking the plough must check that:

- Tractor arms are regulated to the same length and height.
- Tractor wheels have the same pressure, and check that it fits with the manufacturer rules.



## 4.2 - Alignment

The Short Disc Harrow must work aligned with the tractor, or this will tend to abandon the tractor's straight. Must check that the  $A_1 = A_2$  (Fig. 3).

The third point arm must be coupled in a way that the end that links over the disc harrow remains slightly higher than the end that links to the tractor (Fig. 4).

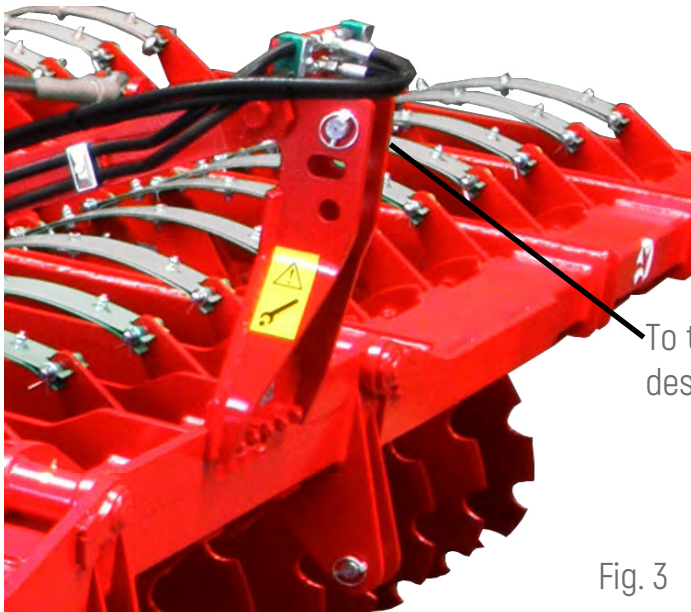

Fig. 3

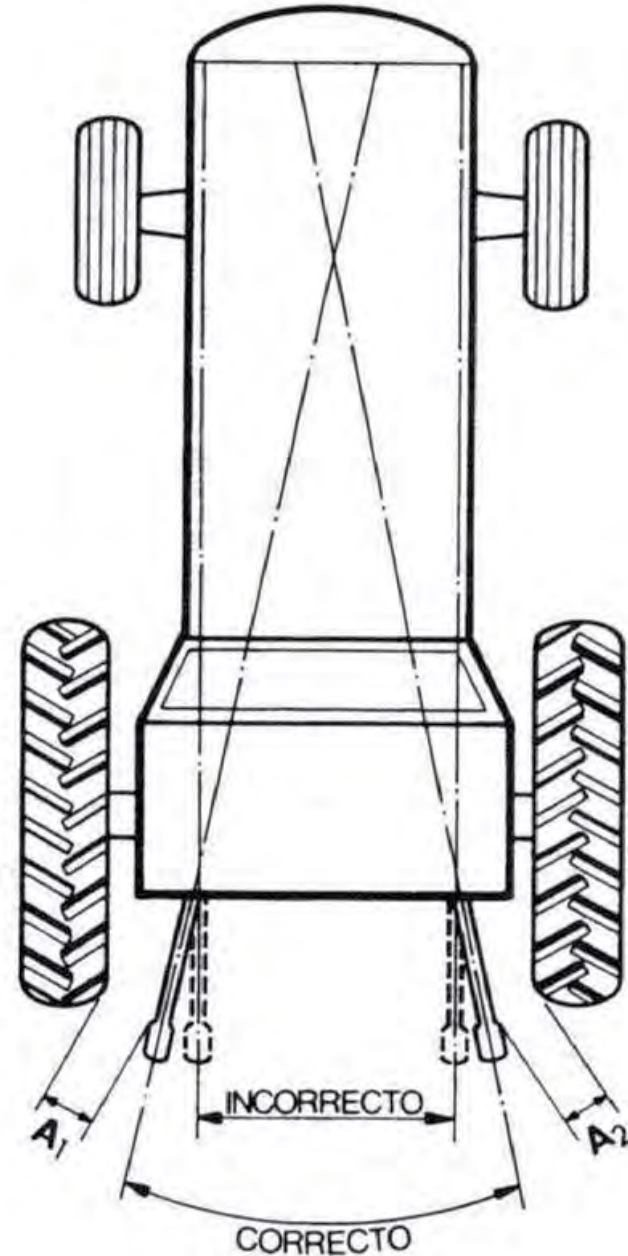

Fig. 4



## 4.3 - Other adjustments

The length of the 3rd point must be adjusted in a way that the frame adopts a parallel position to the ground, if not, the rows of arms will work at uneven depths, causing a wrong labor. (Fig. 6)

For the same reason, is necessary for the tractor arms to be found at the same height, so the machine works at the same depth in its whole width (Fig. 7) and side triggers doesn't happen, so the tractor doesn't find it hard to keep its path. (Fig. 7)

**IMPORTANT:** Must try not totake curves while working, specially with very heavy machinery, since the pulling effort may cause severe damage to the machine's structure.

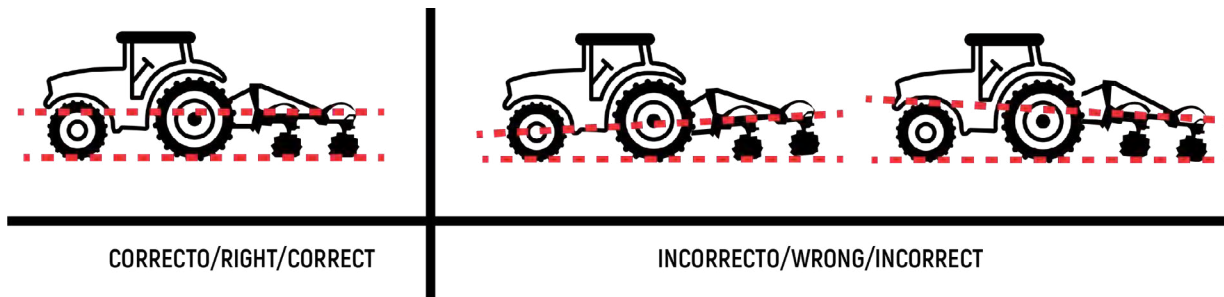

Fig. 5

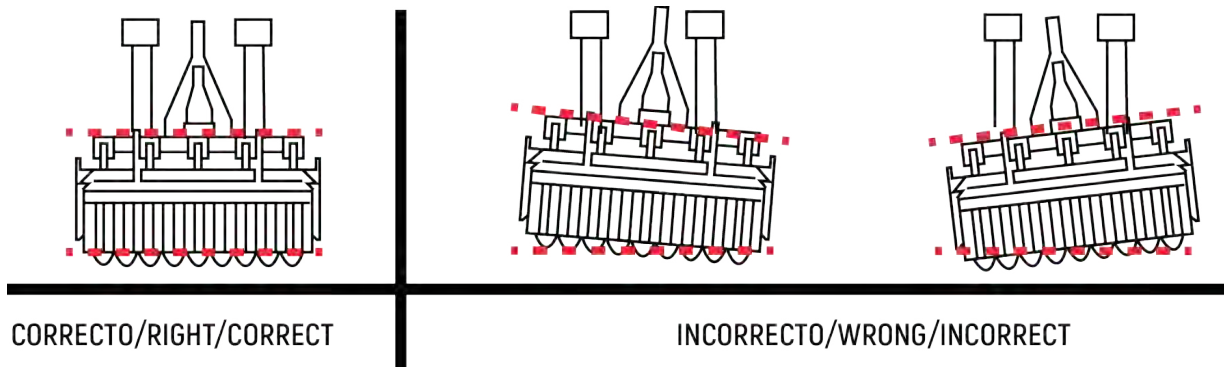

Fig. 6



# 5.- Working depth

The working depth is regulated by the standard roller, through the regulation bolts A (Fig.7).

Nevertheless, the Eurodisc can be equipped with limiting wheels, whose height is regulated through the bolts B (Fig. 8)

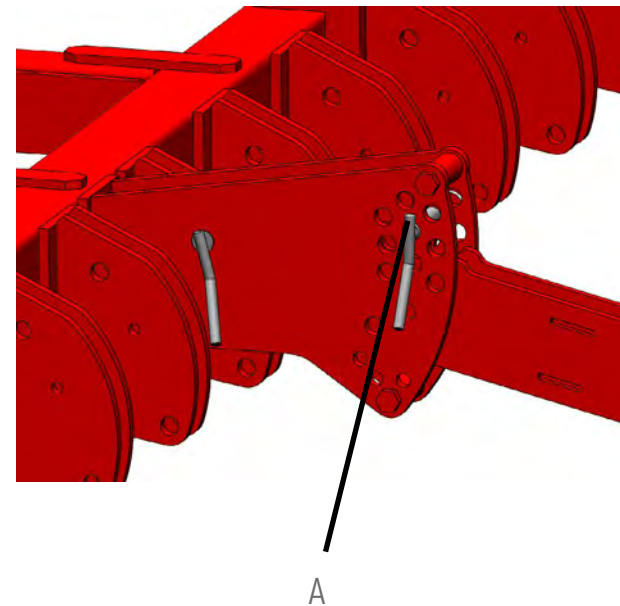



# 6.- Transport

At the machines with hydraulic folding, this will be retracted in order to ease its transport, leaving the machine at its minimum width. See Fig.9. In order to avoid the oscillation of the rollers, fix the lower bolts A described in the previous point.

At the trailed models the machine must elevate the most on its transport wheels by the cylinder C (Fig 10) up to its maximum extension for a safe transport. The cylinder C have on the inside a shock absorpther for a more comfortable driving.



Fig. 9

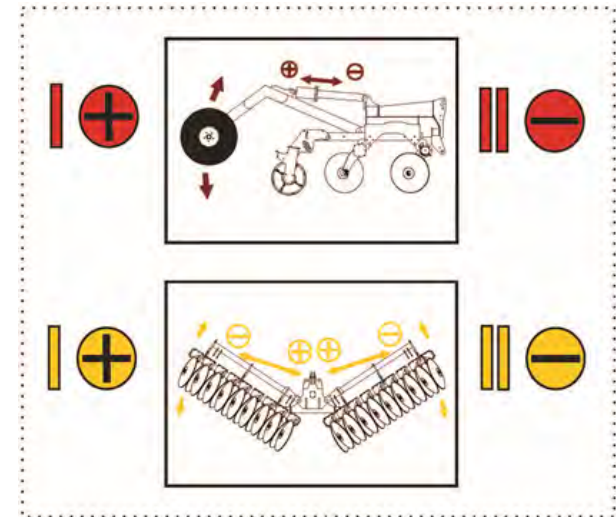

Fig. 10

## 6.1- Hydraulic Functions

There's 2 hydraulic functions available:

1. Red: Elevate/Lower the trail kit, in order to regulate the height of the machine.
2. Yellow: Fold/unfold the machine for Work (folding cylinders stretched) –Transport (retracted cylinders)



# 7.- Maintenance

Must check how tighten the bolts are after the first 2 hours of labor, specially the ones on the bodies and shares. Afterwards, check every 100 hours of labor. When finishing the campaign, wash the plough and grease the bodies to avoid rust.

**Lube:** Greasing points must be greased up regularly.

## Safe maintenance

Get familiar with the maintenance procedures before doing any labor. The working area must be clean and dry. Not doing any greasing labor, repair or adjustment while the engine is running. Keep the hands, feet, and clothes always far from the moving components. Place all the hydraulic controls on neutral-gear in order to relieve pressure. Lower all gear to the ground. All the components must be in good shape and correctly installed. Repair damage immediately. Change any wasted or broken piece. Keep all the components of the machine clean off of grease, oil and accumulated dirt. By dealing with trailed equipment, disconnecting the group of cables from the tractor before doing any welding on the machine.

## Watch out for the high pressure leaks

Leaking fluids from the system might leak strong enough to tear flesh, causing severe injuries. Therefore, is indispensable to leave the system pressure-less before loosing or disconnecting any pipe and assure that all the connections and connectors are well-tighten before applying pressure to the system.

In order to locate an hydraulic oil leak use a piece of cardboard placed in between the connections. Don't get near high-pressure leakings.

Even if after all this measures an accident happens, go immediately to see a doctor, who should remove the fluid surgically in a few hours in order to avoid gangrene. Unexperienced doctors with injuries of such nature may go to a specialized medical center.

Maintenance of hydraulic cylinders. **IMPORTANT:** keep the plugs clean. Abrasive particles, such as sand, metal sharps, may damage the cylinders, causing inner leaks. Once unplugged off the tractor, place the protection bolts and make sure they're not touching the ground.

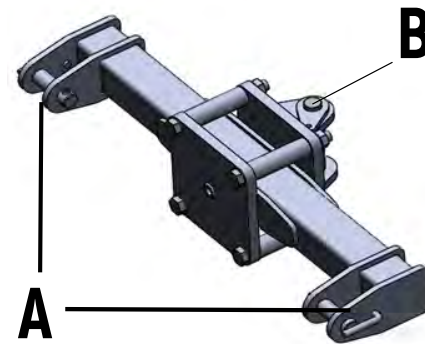

## LINKING BOLTS

The linking bolts A and the turning bolt B must be made of: F-125 TREATED of 36 and 40 diameter each.

For the proper adjustment and functioning the bolts will be replaced when the clearance between the bolt and the holder overpass 2 mm.



# 8.- Optional equipment

Ovlac' Eurodisc can be equipped with:

1. Sideplates. (Fig.11)
2. Limiting left disc. (Fig.12)
3. Side wheels. (Fig.13)
4. Rollers. (Fig.14, 15, 16, 17, 18)

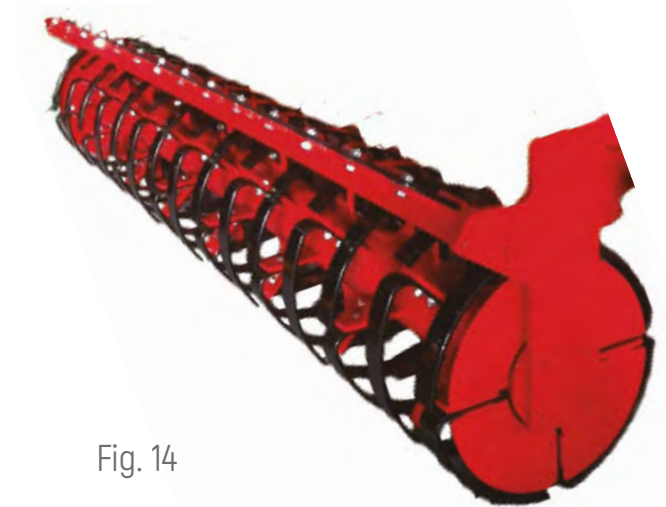

Fig. 14



Fig. 11



Fig. 12



Fig. 13





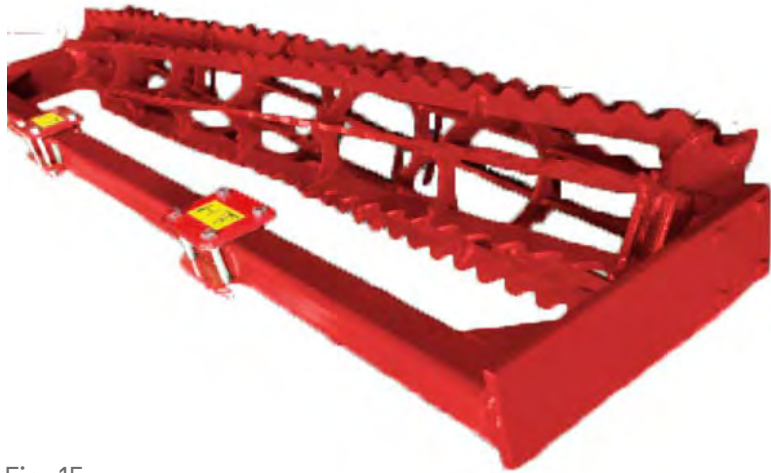

Fig. 15



Fig. 16



Fig. 17



Fig. 18



# 9.- Spare parts

Spare parts orders must always be placed through dealers and will include the next indications:

- Type, model and plough's number of manufacturing. This data is indicated on the identification plate of the plough.
- Reference of the piece. Indicated on the spareparts catalogue.
- Name of the piece and quantity required.
- Method of shipping. Transport expenses run of the purchaser.
- NOTE: The terms left or right, indicated on the name, are meant to be understood always facing the plough from its rear view. When it comes to supposed-to-break gear, rights are considered ll those that are part of the body that drifts to the righth and viceversa.
- Note on warranty: must be clearly specified if the spare parts order are ordered under warranty time. The manufacturer will be the one to decide if the order stands to warranty or not when replacing the pieces. Plus, warranty loses all its value if:
  - Repairs Unauthorized by the manufacturer are made, unoriginal spare parts and bolts are inadequate.
  - User goes through the power limit stated on the technical data sheet, or abnormal maneuvers are made.





# Index

BEAM / FRAME.....	19
BEAM / FRAME FOLDABLE .....	21
HYDRAULIC SYSTEM EURODISC .....	23
BODY .....	27
ROLLER ARM.....	29
ROLLER .....	31
DOUBLE ROLLER.....	35
V ROLLER.....	37
RUBBER ROLLER .....	39
LEAF-SPRINGS ROLLER.....	41
“T RING” ROLLER.....	43
REAR DEFLECTORS .....	47
SIDE DISC .....	51
LATERAL WHEELS .....	53
FIX EURODISC TRAFFIC LIGHT KIT .....	55
FOLDABLE EURODISC TRAFFIC LIGHT KIT.....	57
FRONT TRAILING KIT .....	59
FOLDING AUTOMATIC LOCKER .....	61
REAR TRAILING KIT .....	63
HYDRAULIC SYSTEM TRAILING KIT.....	65
FRONT WHEEL EURODISC (>21).....	67
FRONT WHEEL EURODISC (<21).....	69
FRONT SIGNALING KIT .....	71
REAR SIGNALING KIT.....	73



# BEAM / FRAME

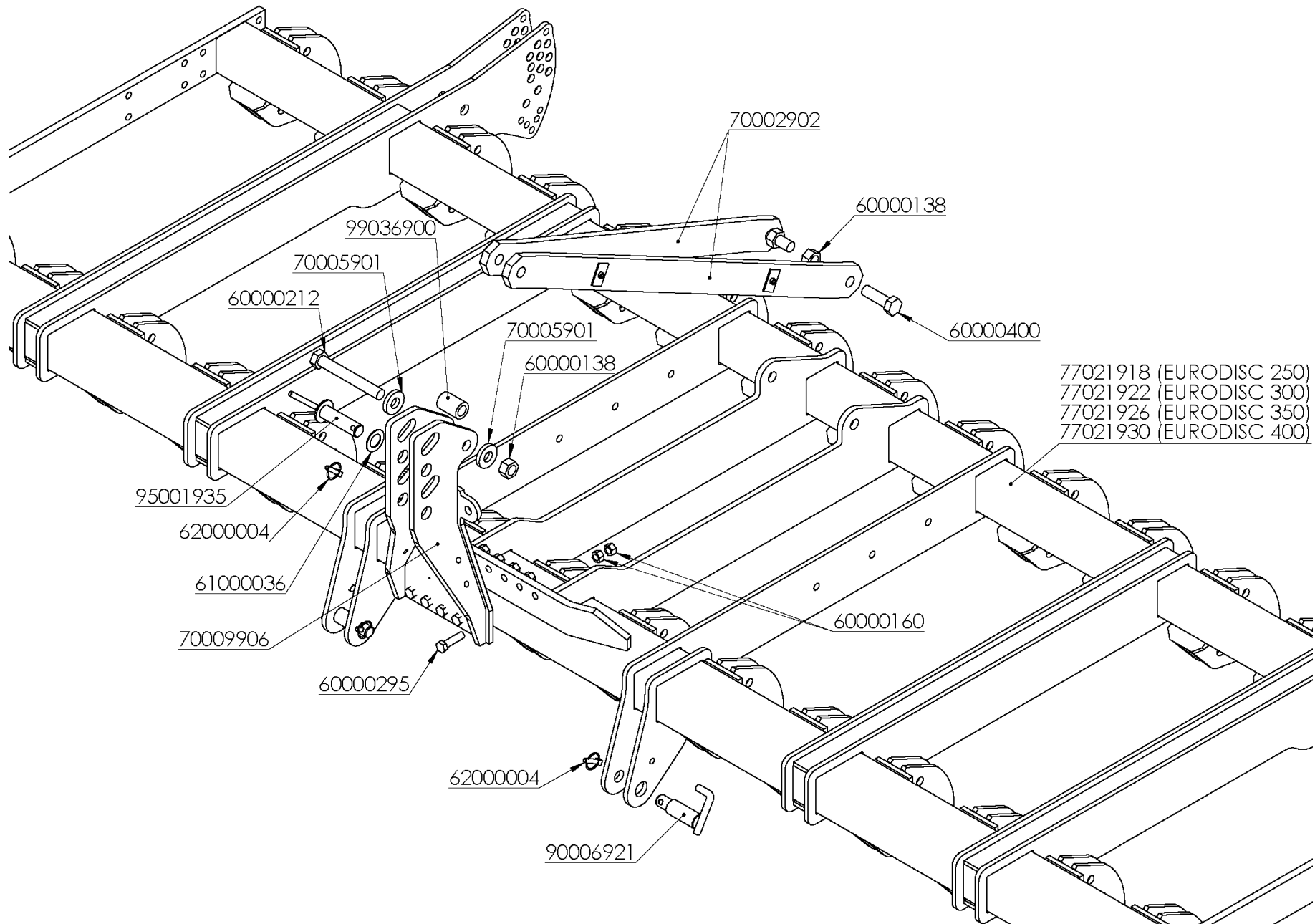

## BEAM / FRAME

REFERENCIA	DESCRIPCIÓN
60000138	TUER.AUTO.DIN-980 1"SAE 10.9 ZINC.
60000160	TUER.EXAG.DIN-934 16 8.8 ZINC.
60000212	TORN.EXAG.C/LAR.1"*190 SAE 12.9
60000295	TORN.EXAG.DIN-931 16* 60 12.9
60000400	TORN.EXAG.DIN-931 1"* 70 SAE 12.9
61000036	ARAND.ESTANDAR-A 32 ZINC.
62000004	PASADOR ANILLA 10 ZINC.
70002902	TIRANTE SUP.CH-1"
70005901	ARAND.RFZO.D= 58*26 E-10mm.
70009906	TORRETA CH/FENIX/EURODISC CAT-III (TORN-1")
77021918	BAST.EURODISC 2,50m. RFZD.
77021922	BAST.EURODISC 3,00m. RFZD.
77021926	BAST.EURODISC 3,50m. RFZD.
77021930	BAST.EURODISC 4,00m. RFZD.
90006921	BULON D=36/28*124mm.ENG.EURODISC/VBC/MCH-III
95001935	BULON D=31,2*115mm.3er.PTO.PENT.CAT.III (D/02)
99036900	SEP.B.P.42/26* 60mm.ZINC.



# BEAM / FRAME FOLDABLE

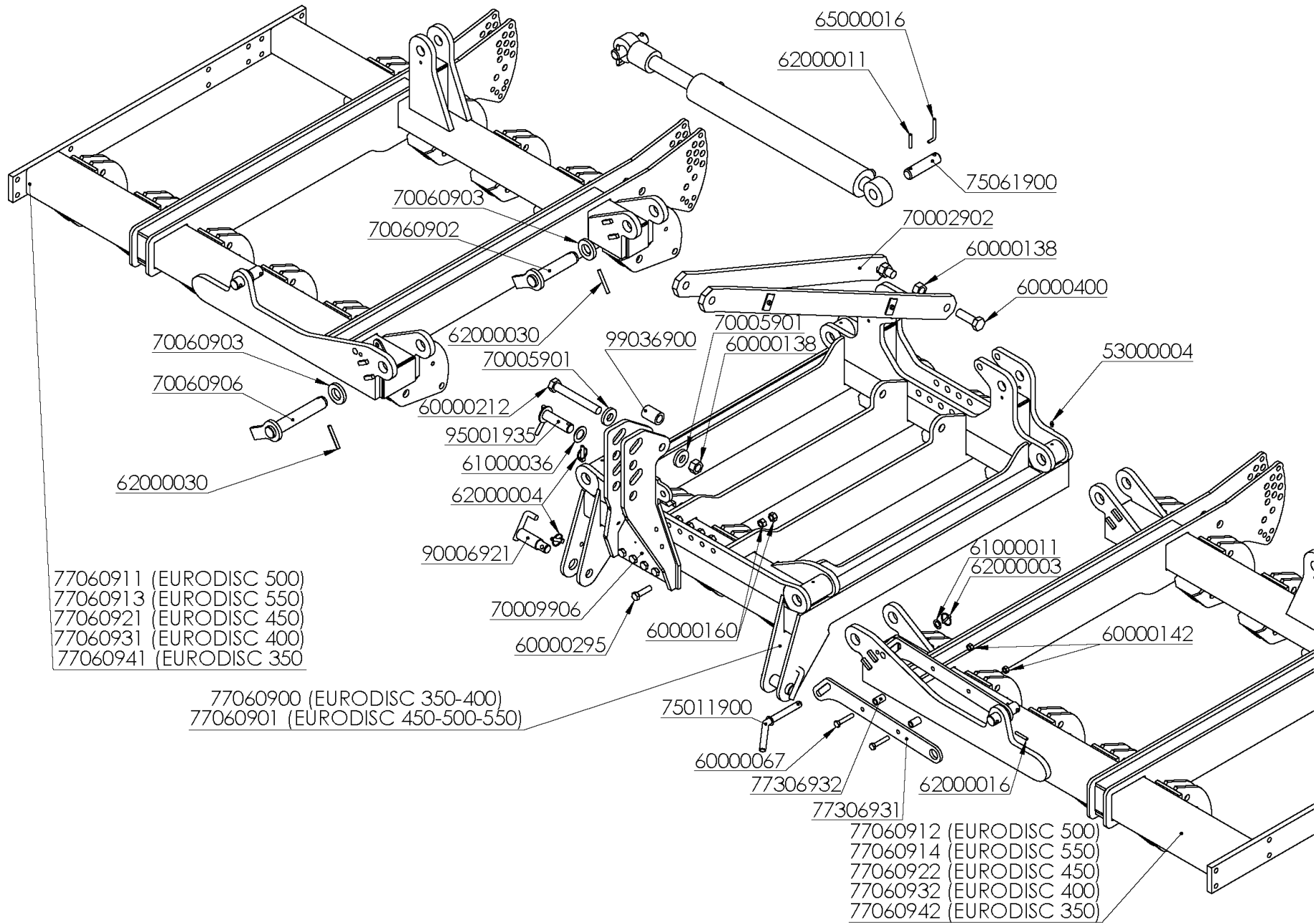

## BEAM / FRAME FOLDABLE

REFERENCIA	DESCRIPCIÓN	REFERENCIA	DESCRIPCIÓN
53000004	ENGRASADOR AC° DIN-71412 8*125	70060906	BULON D=40*244mm.EURODISC
60000067	TORN.EXAG.DIN-931 12* 70 8.8 ZINC.	75011900	BULON D=20*200mm.REG.DISCO FENIX/VBC
60000138	TUER.AUTO.DIN-980 1"SAE 10.9 ZINC.	75061900	BULON D=34,8*138mm.CILIND.LATERAL + DACROMET
60000142	TUER.AUTO.DIN-980 12 8.8 ZINC.	77060900	BAST.CENTRAL EURODISC PLEG.350/400
60000160	TUER.EXAG.DIN-934 16 8.8 ZINC.	77060901	BAST.CENTRAL EURODISC PLEG.450/500/550
60000212	TORN.EXAG.C/LAR.1"*190 SAE 12.9	77060911	BAST.DCH.EURODISC 500
60000295	TORN.EXAG.DIN-931 16* 60 12.9	77060912	BAST.IZQDO.EURODISC 500
60000400	TORN.EXAG.DIN-931 1"* 70 SAE 12.9	77060913	BAST.DCH.EURODISC 550
61000011	ARAND.DIN-125 20 ZINC.	77060914	BAST.IZQD.EURODISC 550
61000036	ARAND.ESTANDAR-A 32 ZINC.	77060921	BAST.DCH.EURODISC 450
62000003	PASADOR ANILLA 6 ZINC.	77060922	BAST.IZQDO.EURODISC 450
62000004	PASADOR ANILLA 10 ZINC.	77060931	BAST.DCH.EURODISC 400
62000011	PASADOR ELAST.DIN-1481 8* 50 ZINC.	77060932	BAST.IZQDO.EURODISC 400
62000016	PASADOR ELAST.DIN-1481 10* 50 ZINC.	77060941	BAST.DCH.EURODISC 350
62000030	PASADOR ELAST.DIN-1481 10* 80 ZINC.	77060942	BAST.IZQDO.EURODISC 350
65000016	PASADOR FIJACION D= 7,5mm.	77306931	BIELA TRANQUE MANUAL
70002902	TIRANTE SUP.CH-1"	77306932	SEP.TUBO 22*16*36mm.
70005901	ARAND.RFZO.D= 58*26 E-10mm.	90006921	BULON D=36/28*124mm.ENG.EURODISC/VBC/MCH-III
70009906	TORRETA CH/FENIX/EURODISC CAT-III (TORN-1")	95001935	BULON D=31,2*115mm.3er.PTO.PENT.CAT.III (D/02)
70060902	BULON D=40*194mm.PLEG.CH/MCH/DISC	99036900	SEP.B.P.42/26* 60mm.ZINC.
70060903	ARAND.P/BULON PLEG.CH/MCH/DISC		





# HYDRAULIC SYSTEM EURODISC

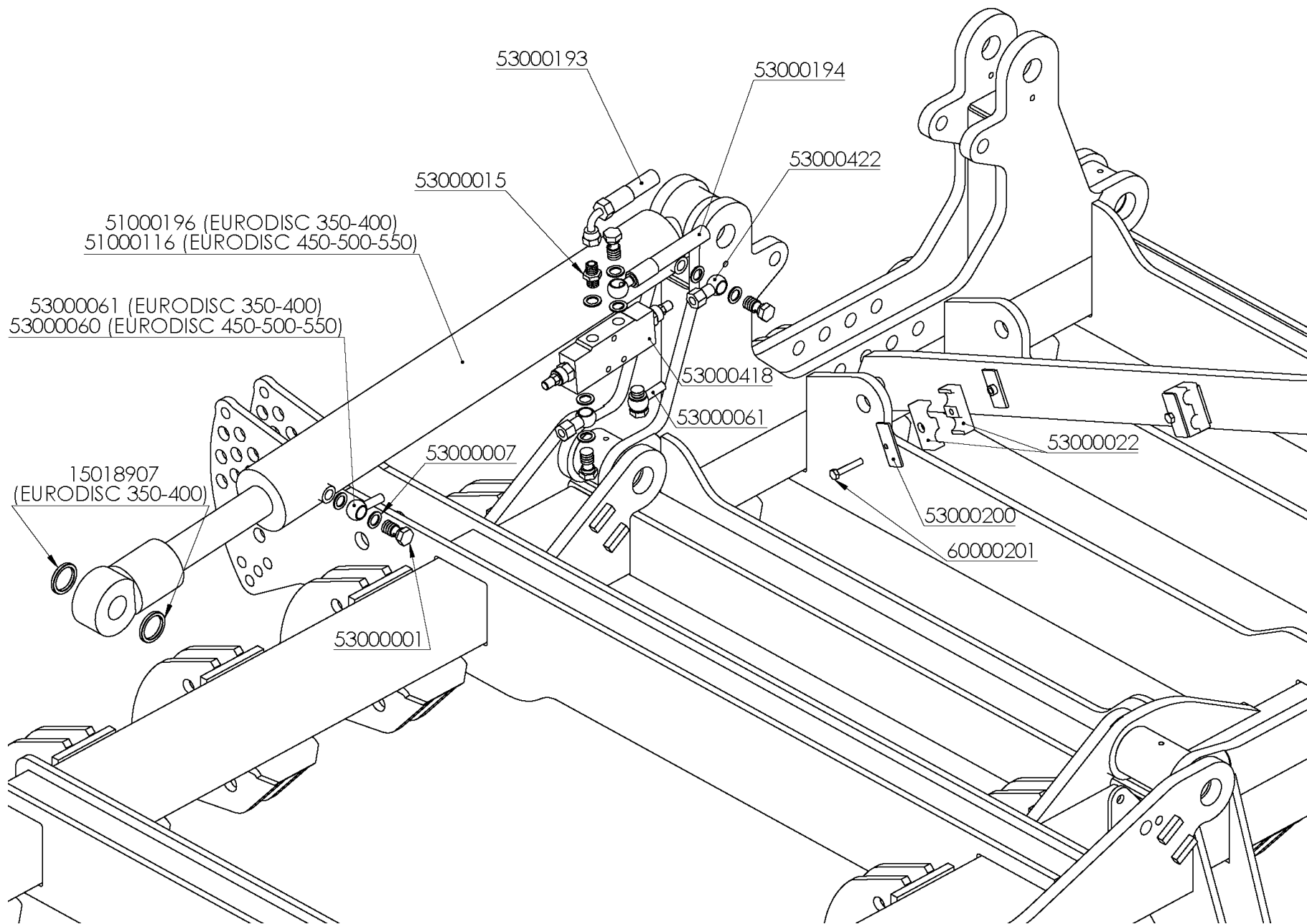

# HYDRAULIC SYSTEM EURODISC

REFERENCIA	DESCRIPCIÓN
15018907	CASQ.D=45/35*5 SEP.PLEGADOS.CICRO
51000116	CILIND.PLEG.MCH/DISC/FENIX 50/100/500
51000196	CILIND.PLEG.CHISEL/VBC/EURO/MAXIDISC 90/45/375
53000001	TORNILLO SIMPLE 3/8 4022
53000007	JUNTA METAL/GOMA 3/8" 11602
53000015	UNION MACHO 3/8 4062
53000022	ABRAZ.DOBLE D=19mm. 1D19PP
53000060	ESFERICO 3/8" TUBO 12mm.L=400 4002E2
53000061	ESFERICO 3/8" TUBO 12mm.L=200
53000193	LATIG.R2-3/8*1780mm.CTL-3/8/TL-18
53000194	LATIG.R2-3/8*1740mm.OR-3/8/TL-18
53000200	PLACA RFZO.AB.DOBLE 19 GD3D
53000418	VALV.OVERCENTER VBCD 3/8 DE-A V0422
53000422	ESFERICO 3/8" + UNION TUBO/TUBO 12 4002E+12L
60000201	TORN.EXAG.DIN-931 8* 45 8.8 ZINC.



# HYDRAULIC SYSTEM EURODISC

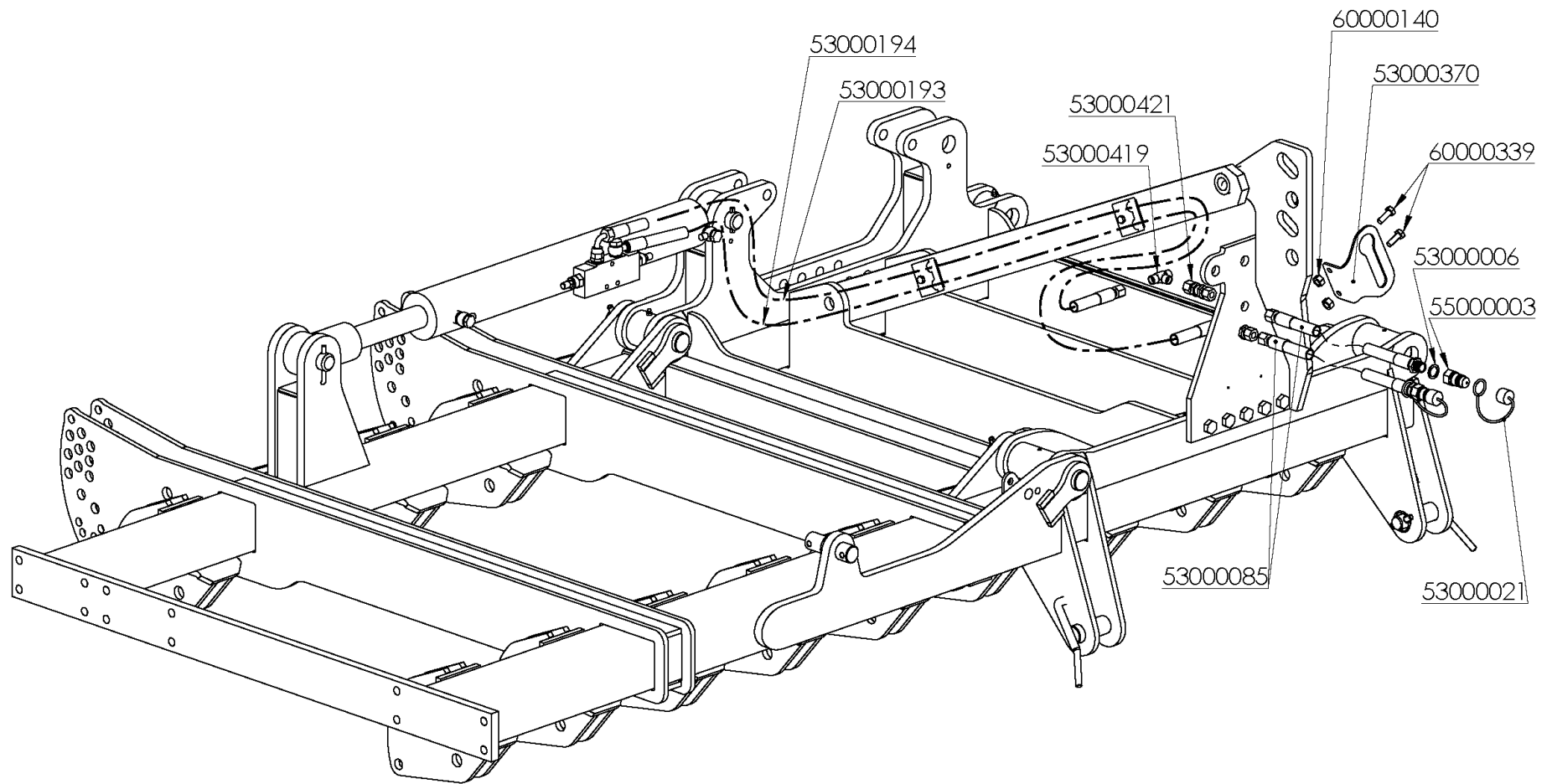

## HYDRAULIC SYSTEM EURODISC

REFERENCIA	DESCRIPCIÓN
53000006	JUNTA METAL/GOMA 1/2" 11603
53000021	PROTECTOR E.R.MACHO 1/2" ROJO 5029-4PR
53000085	LATIG.R2-3/8*1600mm.MF-1/2/TL-18
53000193	LATIG.R2-3/8*1780mm.CTL-3/8/TL-18
53000194	LATIG.R2-3/8*1740mm.OR-3/8/TL-18
53000370	SOPORTE LATIG.TORRETA 1 HUECO ZINC.
53000419	TE M/M C/TCA.LOCA CENTRAL 18x150 12L
53000421	PASATABIQUES 18*1,5 12L
55000003	ADAPTADOR E.R.FASTER 1/2" 30410108
60000140	TUER.AUTO.DIN-980 10 8.8 ZINC.
60000339	TORN.EXAG.DIN-933 10* 30 8.8 ZINC.



# BODY

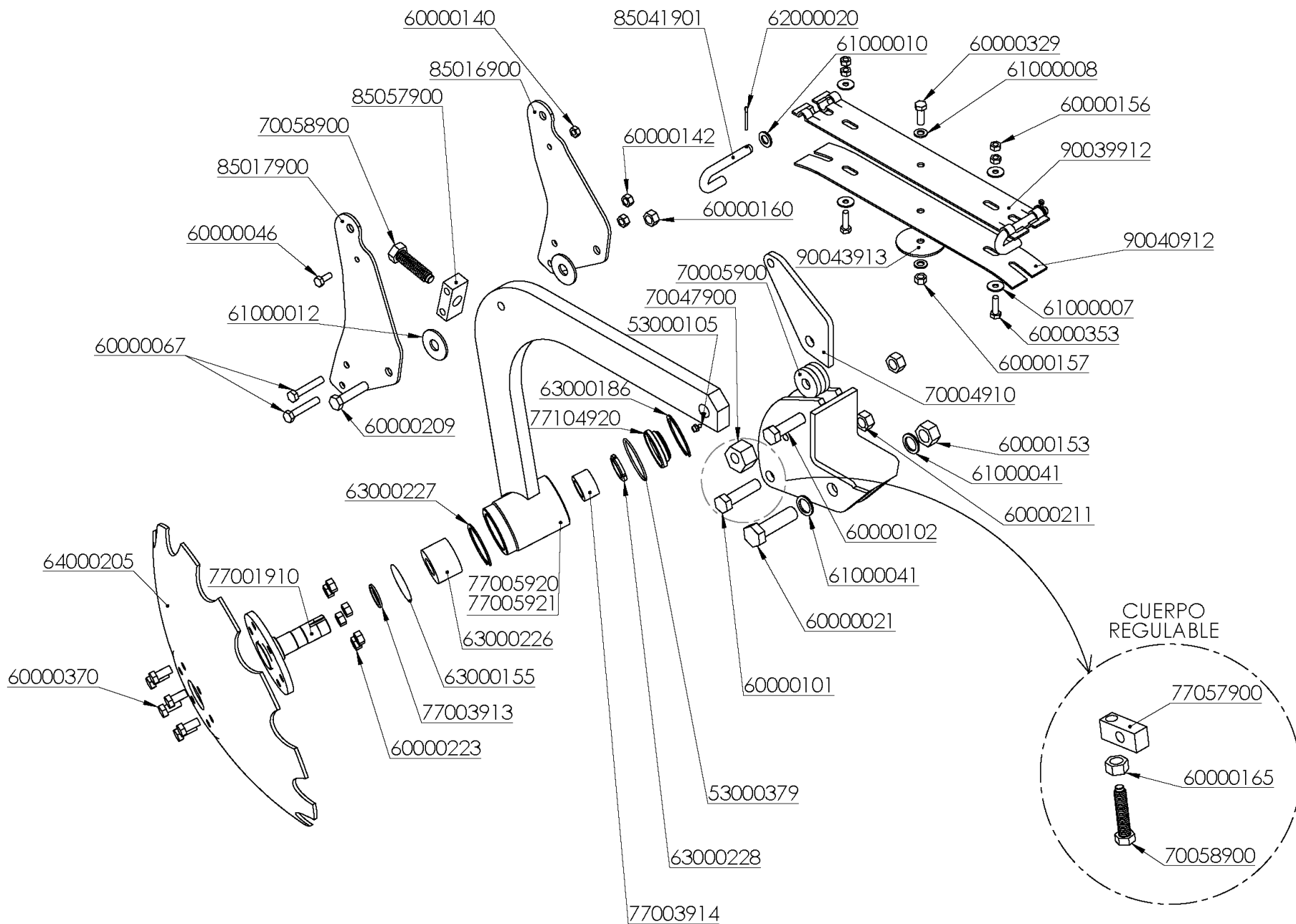

# BODY

REFERENCIA	DESCRIPCIÓN	REFERENCIA	DESCRIPCIÓN
53000105	ENGRASADOR MT-503 10*150	62000020	PASADOR MED.CAÑA DIN-94 4*40 ZINC.
53000379	JUNTA TORICA 72.62-3.53	63000155	RETEN AP6 45*75*12,5
60000021	TORN.EXAG.C/LAR.1"* 85 SAE 12.9	63000186	ANILLO ELASTICO DIN-472 75
60000046	TORN.EXAG.DIN-933 10* 25 8.8 ZINC.	63000226	CARTUCHO GRADA FC40772S03
60000067	TORN.EXAG.DIN-931 12* 70 8.8 ZINC.	63000227	ANILLO ELASTICO DIN-472-I 68
60000101	TORN.EXAG.DIN-931 20* 80 10.9 ZINC.	63000228	TUERCA FIJACION KMA 7
60000102	TORN.EXAG.DIN-931 20* 80 8.8	64000205	DISCO CONCAVO MUESC.EURODISC 1961-24" 6mm.MR-61
60000140	TUER.AUTO.DIN-980 10 8.8 ZINC.	70004910	PORTABALLESTA ANTER CH-S
60000142	TUER.AUTO.DIN-980 12 8.8 ZINC.	70005900	ARAND.RFZO.D= 58*21 E-10mm.
60000153	TUER.EXAG.DIN-934 1"SAE 8.8 ZINC.	70047900	SEP.HEXAG.REGULAC.CH
60000156	TUER.EXAG.DIN-934 10 8.8 ZINC.	70058900	TORNILLO REGULACION BALLESTA CHISEL (22*100)
60000157	TUER.EXAG.DIN-934 12 8.8 ZINC.	77001910	CONJ.EJE DISCO EURODISC
60000160	TUER.EXAG.DIN-934 16 8.8 ZINC.	77003913	ARANDELA EJE CONJ.MAXIDISC (D/15)
60000165	TUER.EXAG.DIN-934 22 8.8 ZINC.	77003914	CASQUILLO TUERCA CONJ.MAXIDISC (D/15)
60000209	TORN.EXAG.C/LAR.16* 70 12.9 ZINC.	77005920	CONJ.BRAZO DCH.EURODISC (ANTER.) (D/15)
60000211	TUER.AUTO.DIN-985 20 8.8	77005921	CONJ.BRAZO IZQD.EURODISC (POST.) (D/15)
60000223	TUER.AUTO.DIN-980 14 8.8 ZINC.	77057900	SOP.REGULACION CAMBA EURODISC
60000329	TORN.EXAG.DIN-933 12* 35 10.9 ZINC.	77104920	TAPA BUJE DISCOS EURO/MAXIDISC (D/11)
60000353	TORN.EXAG.DIN-931 10* 35 10.9 ZINC.	85016900	PORTABALLESTA LARGA IZQD.
60000370	TORN.EXAG.DIN-933 14* 35 8.8 ZINC.	85017900	PORTABALLESTA LARGA DCH.
61000007	ARAND.DIN-9021 10 ZINC.	85041901	PASADOR CACHABA BALLESTA EURODISC + DACROMET
61000008	ARAND.DIN-125 12 ZINC.	85057900	SOP.REGULACION BALLESTA ZINC.
61000010	ARAND.DIN-125 16 ZINC.	90039912	BALLESTA MAESTRA EURODISC VERDE RAL-6029
61000012	ARAND.DIN-9021 20 ZINC.	90040912	BALLESTA 1er.RFZO.EURODISC VERDE RAL-6029
61000041	PAR ARAND.NORD-LOCK 1"	90043913	BALLESTA BOTON EURODISC VERDE RAL-6029





# ROLLER ARM

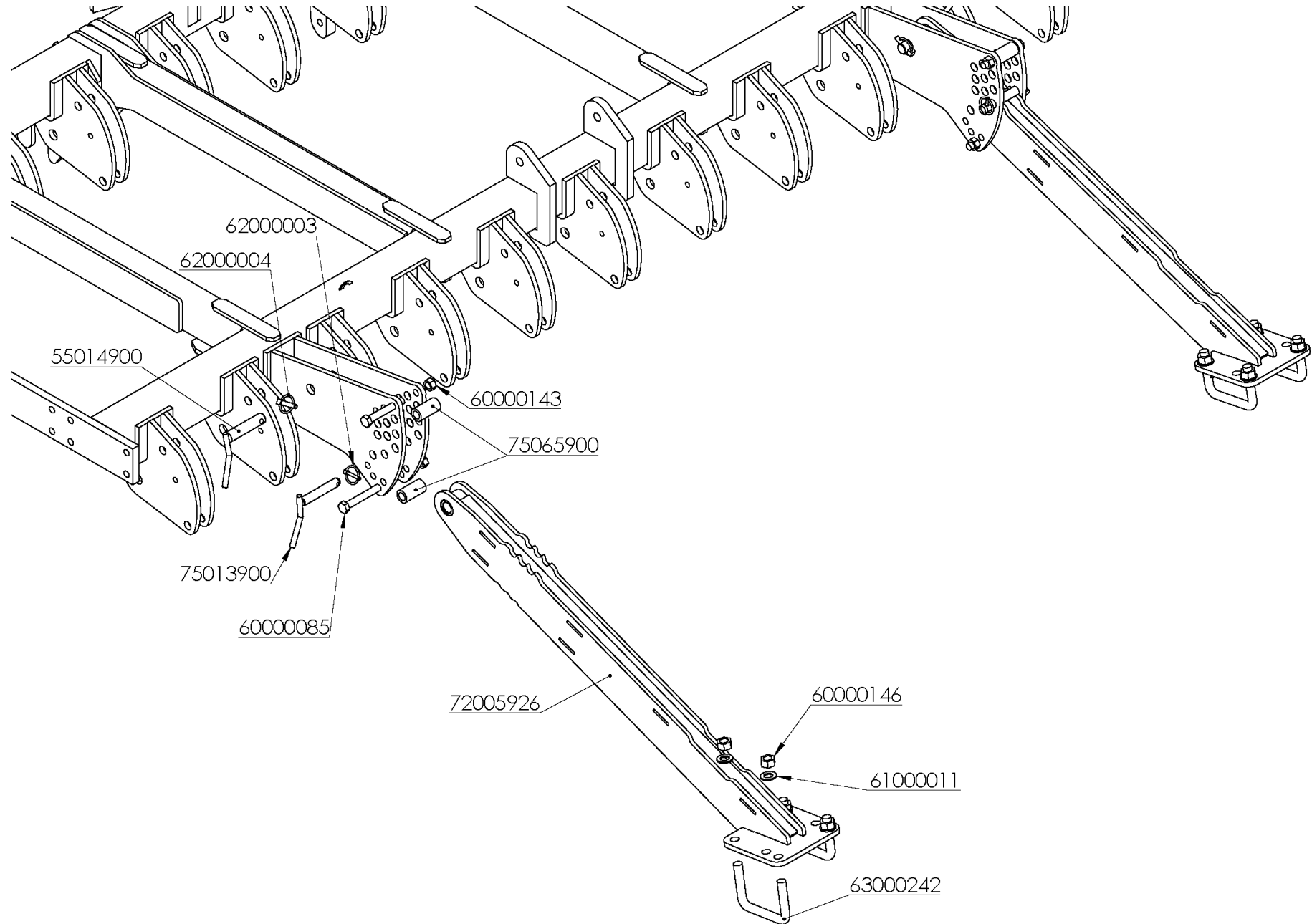

## ROLLER ARM

REFERENCIA	DESCRIPCIÓN
55014900	BULON D=25*110mm.BLOQUEO/BRAZO RODILLO
60000085	TORN.EXAG.DIN-931 16*110 8.8 ZINC.
60000143	TUER.AUTO.DIN-980 16 8.8 ZINC.
60000146	TUER.AUTO.DIN-980 20 10.9 ZINC.
61000011	ARAND.DIN-125 20 ZINC.
62000003	PASADOR ANILLA 6 ZINC.
62000004	PASADOR ANILLA 10 ZINC.
63000242	ABARCON RODILLO 122x98 M-20 10.9 ZINC.
72005926	BRAZO SOP.RODILLO EURODISC (D/15)
75013900	BULON D=20*118mm.REG.RODILLO ZINC.
75065900	SEP.B.P.32/20* 62mm.
77368920	PLACA AMARRE RODILLO MAXIDISC-II/VBC



# ROLLER

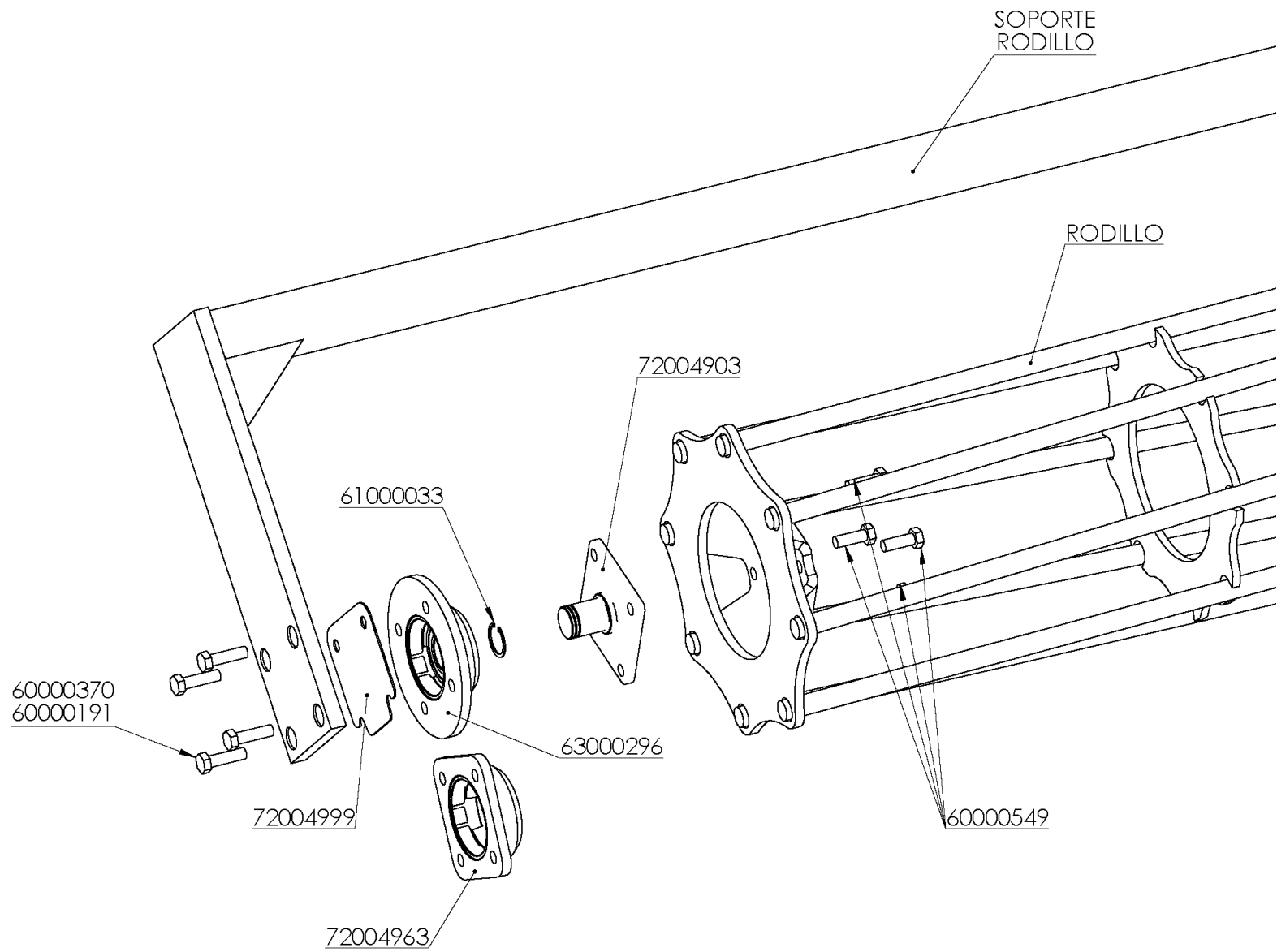

## ROLLER

REFERENCIA	DESCRIPCIÓN
60000549	TORN.EXAG.DIN-933 14*25 8.8
72004903	EJE RODILLO (FKL) CUADRADO
61000033	ANILLO ELASTICO DIN-471 40
72004963	RODAMIENTO C/BRIDA CUADRADO (D/18)
63000296	RODAMIENTO C/BRIDA REDONDO (D/20)
72004999	CALZO BUJE RODILLO
60000370	TORN.EXAG.DIN-933 14* 35 8.8 ZINC.
60000191	TORN.EXAG.DIN-933 14* 30 8.8 ZINC.



RODILLOS							
EURODISC	METROS	SOPORTE RODILLOS	SOP. RODILLOS DOBLE	RODILLO 8 MUESCAS	RODILLO 8 BARRAS	RODILLO 10 MUESCAS	RODILLO 10 BARRAS
250/18-24''	2,55	72102926	72053925	72101926	72001926	72151926	72011926
300/22-24''	3,00	72102931	72053931	72101931	72001931	72151931	72011931
	3,30	72102930	72053930	72101930	72001930	72151933	72011930
350/26-24''	3,80	72102935	72053938	72101935	72001935	72151935	72011935
400/28-24''	1,95	72102919	72053919	72101919	72001919	72151919	72011919
	+ 2,20	+ 72102920	+ 72053922	+ 72101920	+ 72001920	+ 72151920	+ 72011920



RODILLOS							
EURODISC	METROS	SOPORTE RODILLOS	SOP. RODILLOS DOBLE	RODILLO 8 MUESCAS	RODILLO 8 BARRAS	RODILLO 10 MUESCAS	RODILLO 10 BARRAS
350P/26-24''	2 x 1,95	72102919	72053919	72101919	72001919	72151919	72011919
400P/28-24''	1,95	72102919	72053919	72101919	72001919	72151919	72011919
	+ 2,20	+ 72102920	+ 72053922	+ 72101920	+ 72001920	+ 72151920	+ 72011920
450P/32-24''	2,55	72102926	72053925	72101926	72001926	72151926	72011926
	+ 2,20	+ 72102920	+ 72053922	+ 72101920	+ 72001920	+ 72151920	+ 72011920
500P/36-24''	2,70	72102925	72053927	72101925	72001925	72151925	72011925
	+ 2,55	+ 72102926	+ 72053925	+ 72101926	+ 72001926	+ 72151926	+ 72011926
550P/38-24''	2,70	72102925	72053927	72101925	72001925	72151925	72011925
	+ 3,00	+ 72102931	+ 72053931	+ 72101931	+ 72001931	+ 72151931	+ 72011931





# DOUBLE ROLLER

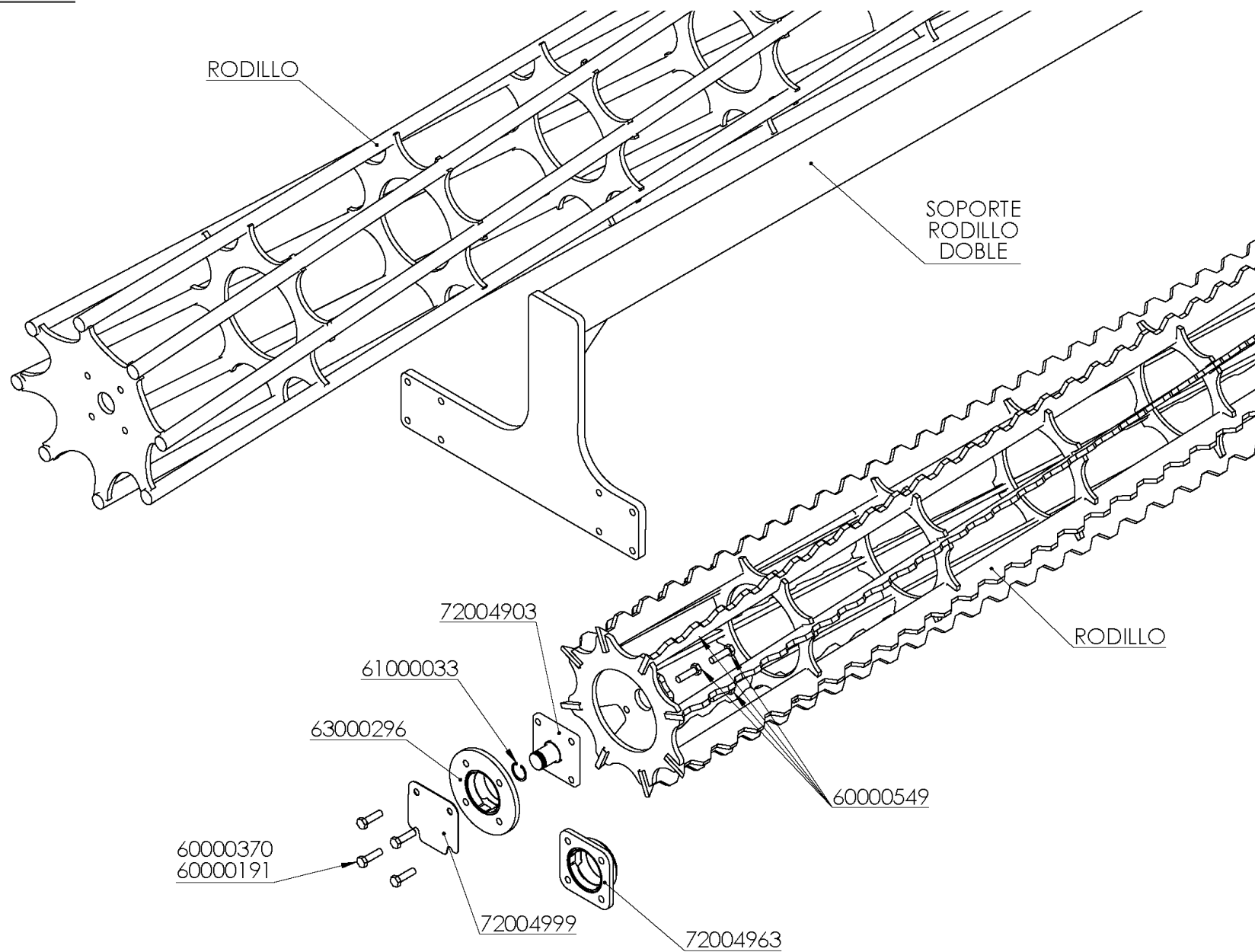

## DOUBLE ROLLER

REFERENCIA	DESCRIPCIÓN
60000191	TORN.EXAG.DIN-933 14* 30 8.8 ZINC.
60000370	TORN.EXAG.DIN-933 14* 35 8.8 ZINC.
60000549	TORN.EXAG.DIN-933 14*25 8.8
61000033	ANILLO ELASTICO DIN-471 40
63000296	RODAMIENTO C/BRIDA REDONDO (D/20)
72004903	EJE RODILLO (FKL) CUADRADO
72004963	RODAMIENTO C/BRIDA CUADRADO (D/18)
72004999	CALZO BUJE RODILLO



# V ROLLER

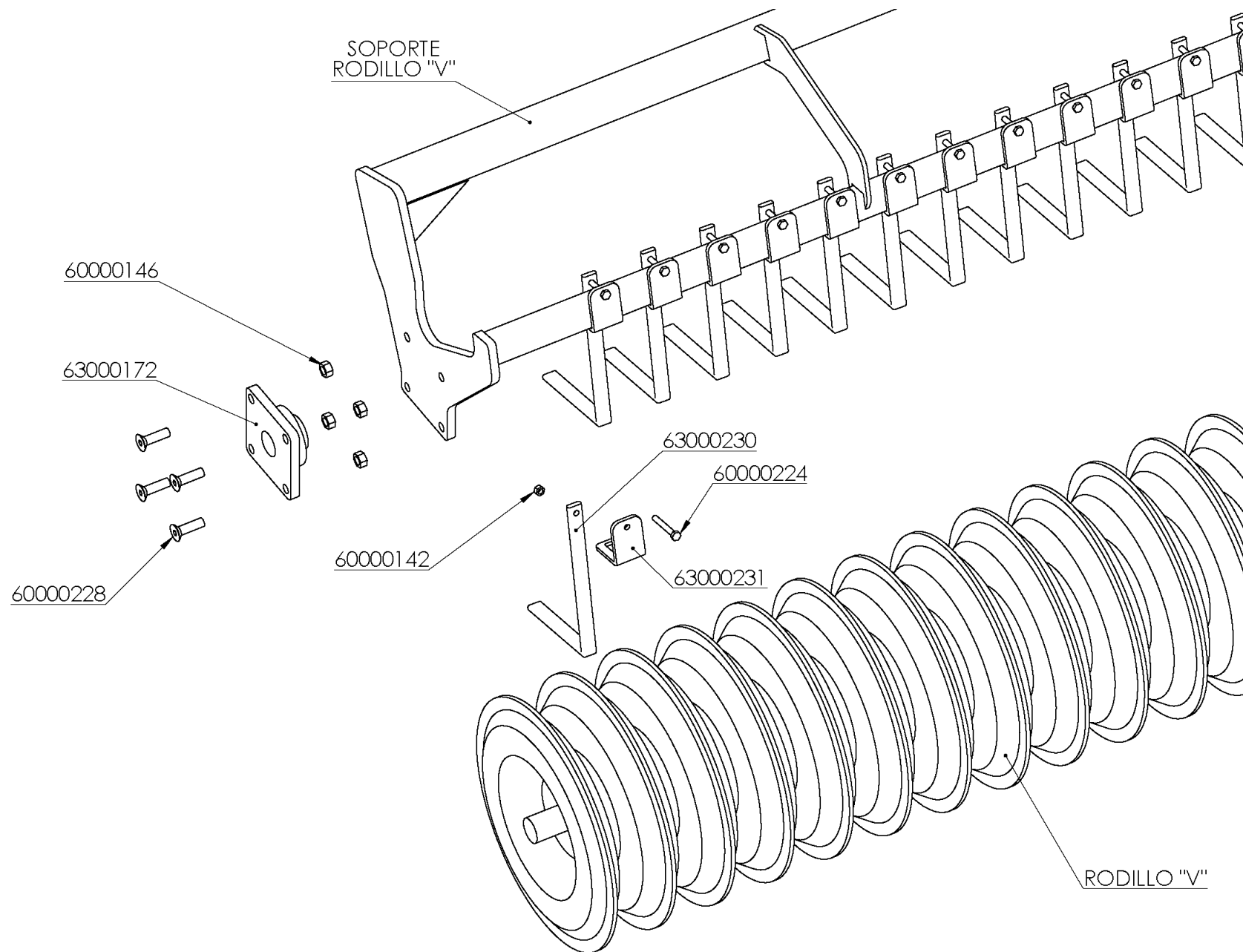

## V ROLLER

REFERENCIA	DESCRIPCIÓN
60000142	TUER.AUTO.DIN-980 12 8.8 ZINC.
60000146	TUER.AUTO.DIN-980 20 10.9 ZINC.
60000224	TORN.EXAG.DIN-931 12* 90 10.9 ZINC.
60000228	TORN.ALLEN DIN-7991 20* 70 12.9
63000172	RODAM.DE BRIDA RCJY60-N REFORZADO
63000230	RASQUETA SIMPLE RODILLO "V" MOD.2013
63000231	PLACA SOP.RASQUETA RODILLO "V" MOD.2013



# RUBBER ROLLER

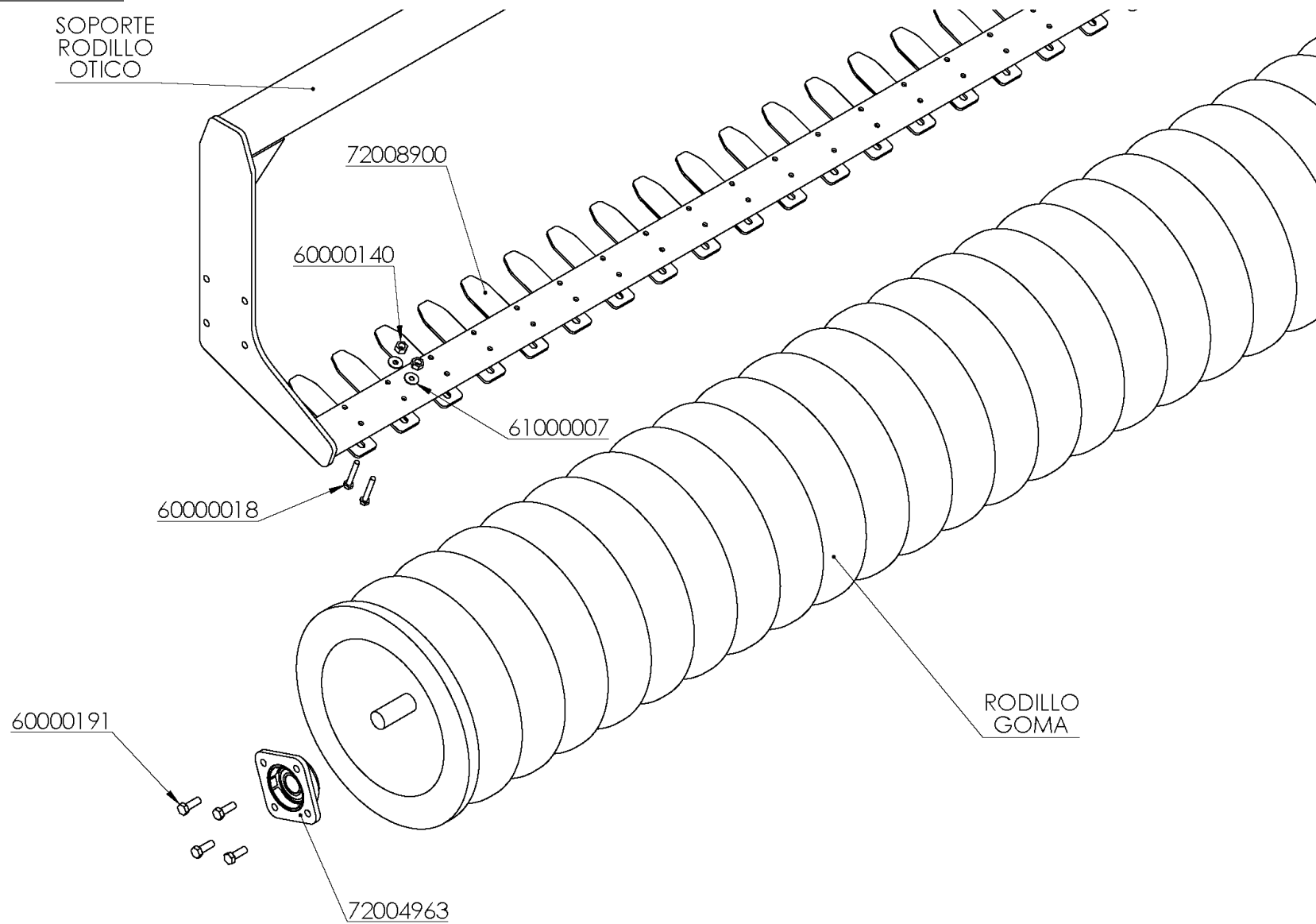

## RUBBER ROLLER

REFERENCIA	DESCRIPCIÓN
60000018	TORN.EXAG.DIN-931 10* 70 8.8 ZINC.
60000140	TUER.AUTO.DIN-980 10 8.8 ZINC.
60000191	TORN.EXAG.DIN-933 14* 30 8.8 ZINC.
61000007	ARAND.DIN-9021 10 ZINC.
72004963	RODAMIENTO C/BRIDA CUADRADO (D/18)
72008900	RALLADERA RODILLO OTICO





# LEAF-SPRINGS ROLLER

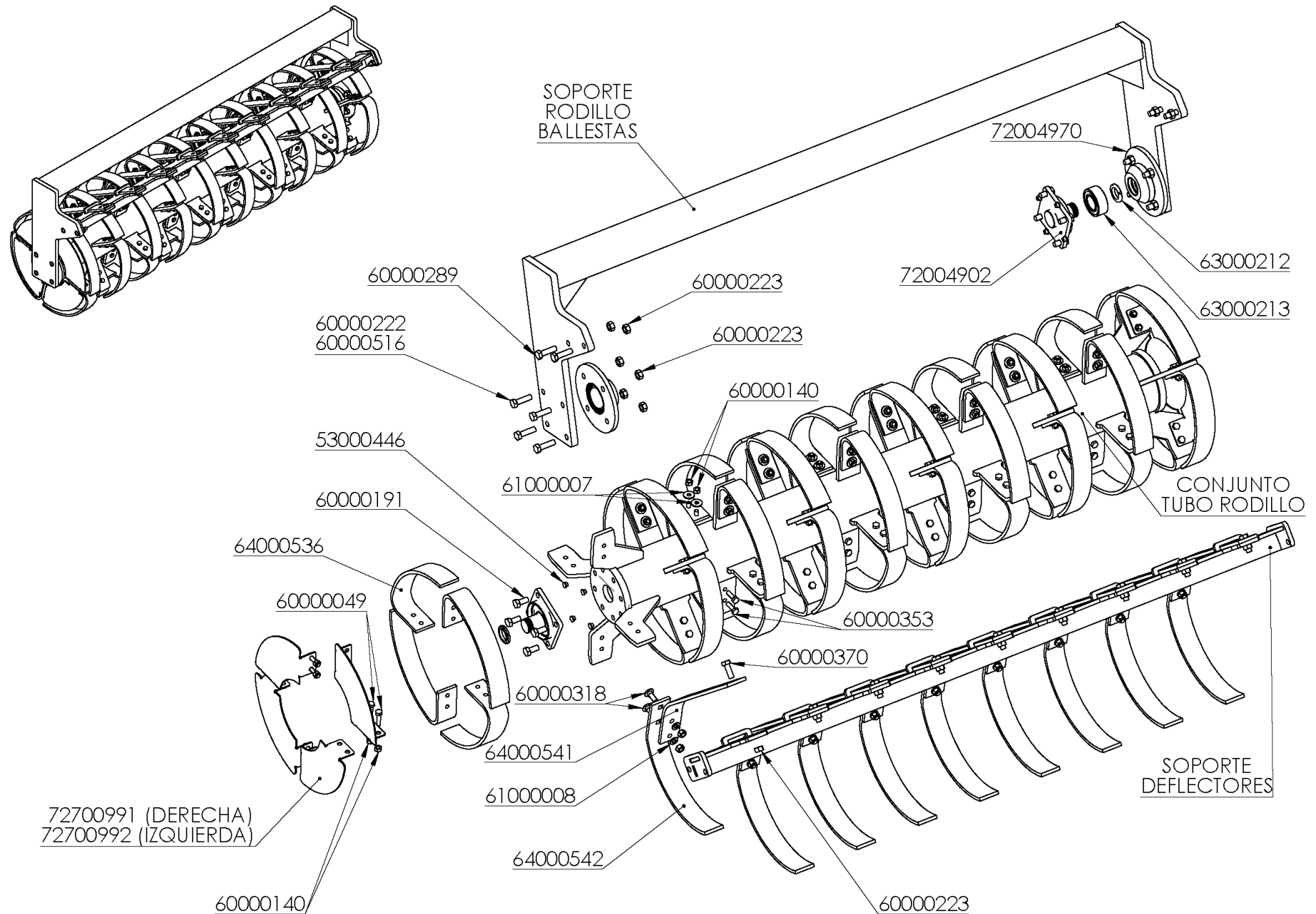

## LEAF-SPRINGS ROLLER

REFERENCIA	DESCRIPCIÓN	REFERENCIA	DESCRIPCIÓN
53000446	TAPON PVC NEGRO 12,3mm.	63000213	RODAM.ENT-140225-308E BUJE RODILLO MCH
60000049	TORN.EXAG.DIN-931 10* 40 10.9 ZINC.	64000536	BALLESTA RODILLO 60*9
60000140	TUER.AUTO.DIN-980 10 8.8 ZINC.	64000541	SOP.DEFLECTOR ROD.BALLESTA 60*9
60000191	TORN.EXAG.DIN-933 14* 30 8.8 ZINC.	64000542	DEFLECTOR ROD.BALLESTA
60000222	TORN.EXAG.DIN-931/933 14* 40 8.8	72004902	EJE RODILLO CIERRE ESFERICO (OJO PEDIR RODAM.63000213)
60000223	TUER.AUTO.DIN-980 14 8.8 ZINC.	72004970	BUJE C/BRIDA RODILLO MCH (D/14)
60000289	TORN.EXAG.DIN-931 14* 40 12.9 ZINC.	72004974	CONJ.RODAMIENTO RODILLO REDONDO (BALLESTAS-"T"- "U")
60000318	TORN.ARADO DIN-603/934 12*35 8.8 ZINC.	72004999	CALZO BUJE RODILLO
60000353	TORN.EXAG.DIN-931 10* 35 10.9 ZINC.	72700920	CONJUNTO TUBO RODILLO BALLESTAS 2,00m.
60000370	TORN.EXAG.DIN-933 14* 35 8.8 ZINC.	72700991	CHAPA PLEGADA DCHA. ROD. BALL.
60000516	TORN.EXAG.DIN-933 14* 45 8.8	72700992	CHAPA PLEGADA IZQ. ROD. BALL.
61000007	ARAND.DIN-9021 10 ZINC.	72702920	SOP.DEFLECTORES RODILLO BALLESTAS 2,00m.
61000008	ARAND.DIN-125 12 ZINC.	72703920	SOP.RODILLO BALLESTAS 2,00m. (D/14)
63000212	TUERCA FIJACION KMA 8		



# "T RING" ROLLER

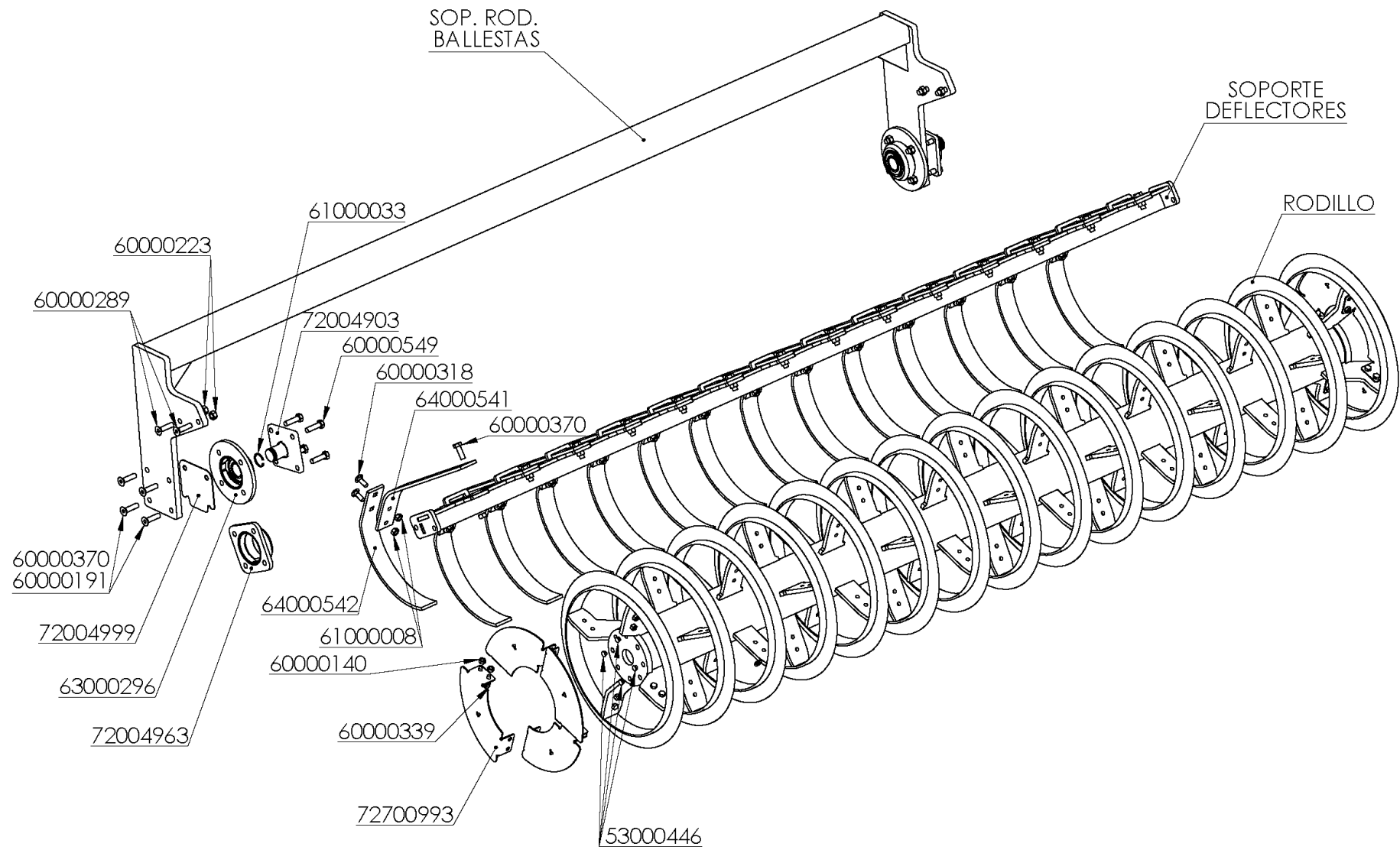

## "T RING" ROLLER

REFERENCIA	DESCRIPCIÓN
53000446	TAPON PVC NEGRO 12,3mm.
60000140	TUER.AUTO.DIN-980 10 8.8 ZINC.
60000191	TORN.EXAG.DIN-933 14* 30 8.8 ZINC.
60000223	TUER.AUTO.DIN-980 14 8.8 ZINC.
60000289	TORN.EXAG.DIN-931 14* 40 12.9 ZINC.
60000318	TORN.ARADO DIN-603/934 12*35 8.8 ZINC.
60000339	TORN.EXAG.DIN-933 10* 30 8.8 ZINC.
60000370	TORN.EXAG.DIN-933 14* 35 8.8 ZINC.
60000549	TORN.EXAG.DIN-933 14*25 8.8
61000008	ARAND.DIN-125 12 ZINC.
61000033	ANILLO ELASTICO DIN-471 40
63000296	RODAMIENTO C/BRIDA REDONDO (D/20)
64000541	SOP.DEFLECTOR ROD.BALLESTA 60*9
64000542	DEFLECTOR ROD.BALLESTA
72004903	EJE RODILLO (FKL) CUADRADO
72004963	RODAMIENTO C/BRIDA CUADRADO (D/18)
72004999	CALZO BUJE RODILLO
72700993	CHAPA PLEGADA ROD. RING



BALLESTAS						
EURODISC	METROS	SOPORTE RODILLOS	SOPORTE DEFLECTORES	CONJ. TUBO RODILLO BALLESTAS	CONJ. TUBO RODILLO "T-RING"	CONJ. TUBO RODILLO "U-RING"
250/18-24''	2,60	72703926	72702926	72700926	72730926	
300/22-24''	3,00	72703930	72702930	72700930	72730930	72740930
	3,20	72703932	72702932	72700932		
350/26-24''	3,60	72703936	72702936	72700936		72740936
400/28-24''	2,00	72703920	72702920	72700920	72730920	72740920
	+ 2,20	+ 72703922	+ 72702922	+ 72700922	+ 72730922	+ 72740922



BALLESTAS						
EURODISC	METROS	SOPORTE RODILLOS	SOPORTE DEFLECTORES	CONJ. TUBO RODILLO BALLESTAS	CONJ. TUBO RODILLO "T-RING"	CONJ. TUBO RODILLO "U-RING"
<b>350P/26-24''</b>	2 x 2,00	72703920,00	72702920,00	72700920	72730920	72740920
<b>400P/28-24''</b>	2,00	72703920	72702920	72700920	72730920	72740920
	+ 2,20	+ 72703922	+ 72702922	+ 72700922	+ 72730922	+ 72740922
<b>450P/32-24''</b>	2,60	72703926	72702926	72700926	72730926	
	+ 2,20	+ 72703922	+ 72702922	+ 72700922	+ 72730922	
<b>500P/36-24''</b>	2,80	72703928	72702928	72700928		
	+ 2,60	+ 72703926	+ 72702926	+ 72700926		
<b>550P/38-24''</b>	2,60	72703926	72702926	72700926	72730926	
	+ 3,00	+ 72703930	+ 72702930	+ 72700930	+ 72730930	





# REAR DEFLECTORS

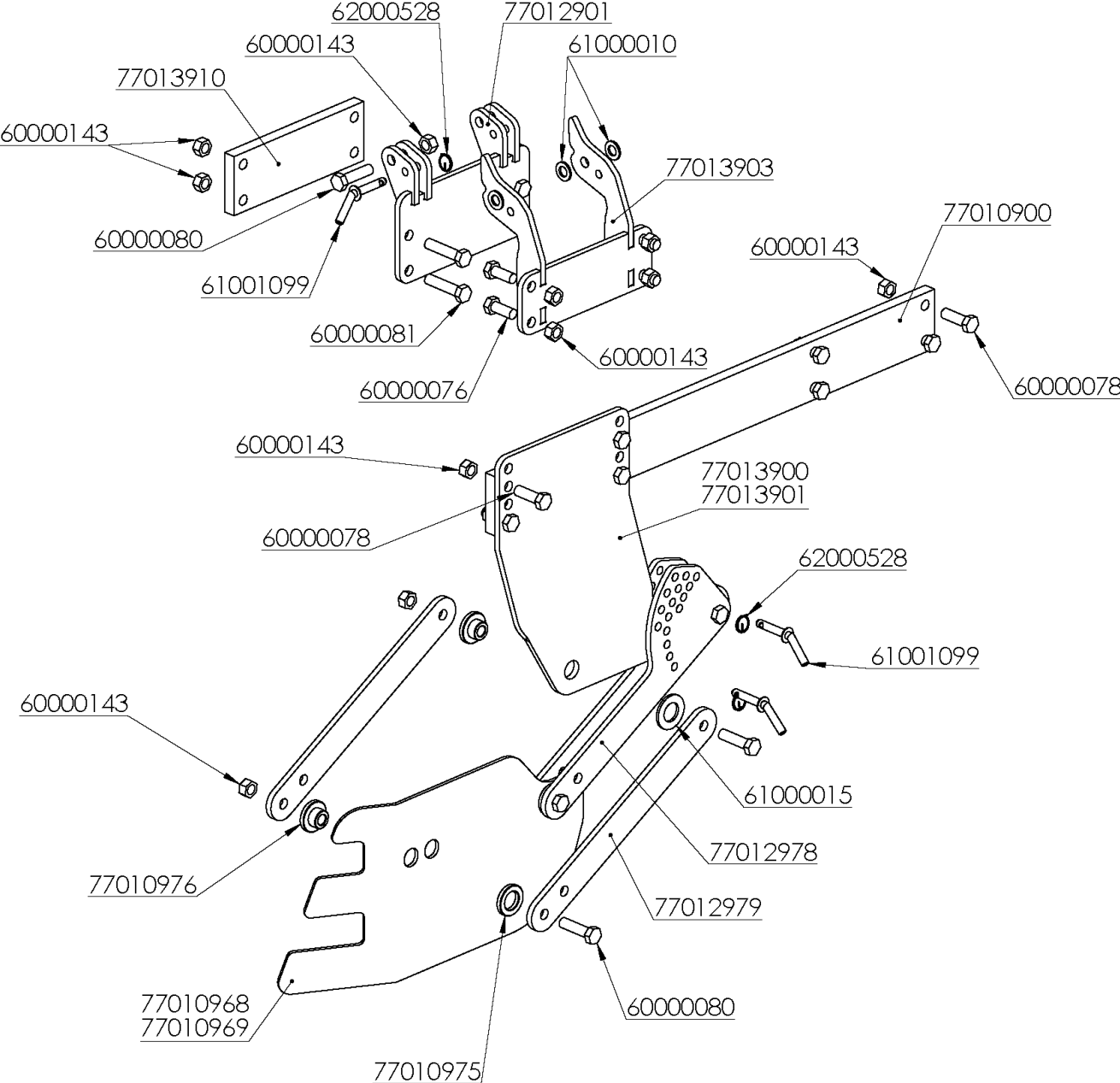

## REAR DEFLECTORS

REFERENCIA	DESCRIPCIÓN
60000076	TORN.EXAG.DIN-933 16* 40 8.8 ZINC.
60000078	TORN.EXAG.DIN-933 16* 50 8.8 ZINC.
60000080	TORN.EXAG.DIN-931 16* 60 8.8 ZINC.
60000081	TORN.EXAG.DIN-931 16* 70 8.8 ZINC.
60000143	TUER.AUTO.DIN-980 16 8.8 ZINC.
61000010	ARAND.DIN-125 16 ZINC.
61000015	ARAND.DIN-125-B 30 ZINC.
61001099	BULON D=12*120mm.ACODADO
62000010	PASADOR ELAST.DIN-1481 8* 40 ZINC.
62000528	ANILLA PASADOR INOX-36x3 1,5V LUZ 5mm.
77010900	LLANTA SOP.FALDON TRASERO EURODISC
77010968	PLACA FALDON DEL. MAXIDISC
77010969	PLACA FALDON TRAS. MAXIDISC
77010975	ARANDELA 50*30*8mm.
77010976	CASQ.D=50/29,5/16,5*22.5mm. FALD.
77012901	SOP. BISAGRA FALDON EURODISC
77012978	BIELA REG.FALDON EURODISC
77012979	BIELA FALDON EURODISC
77013900	PLACA DEL. SOP. FALDON PARALEL. EURODISC
77013901	PLACA TRAS. SOP. FALDON PARALEL. EURODISC
77013903	SOP. ABAT. FALDON PARALEL EURODISC
77013910	LLANTA CALZO FALDON PARALEL. EURODISC



# POSITIONING OF DEFLECTORS

FIJO IZQUIERDO

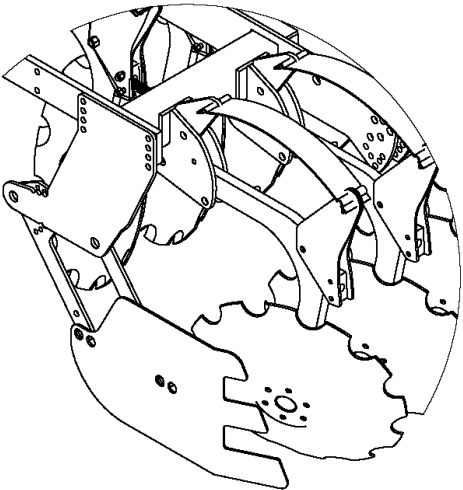

FIJO DERECHO

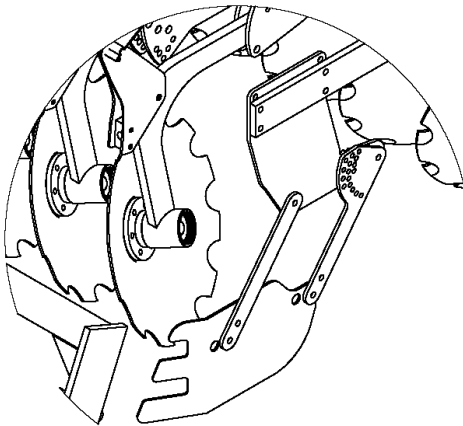

PLEGABLE IZQUIERDO

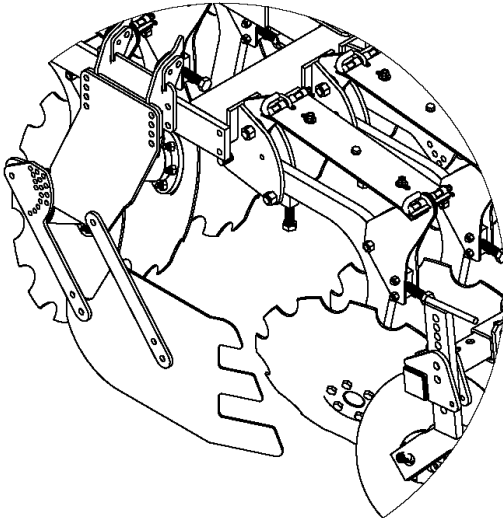

PLEGABLE DERECHO

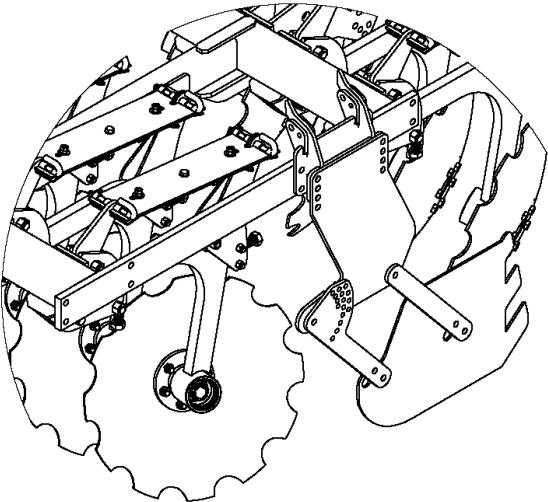



# SIDE DISC

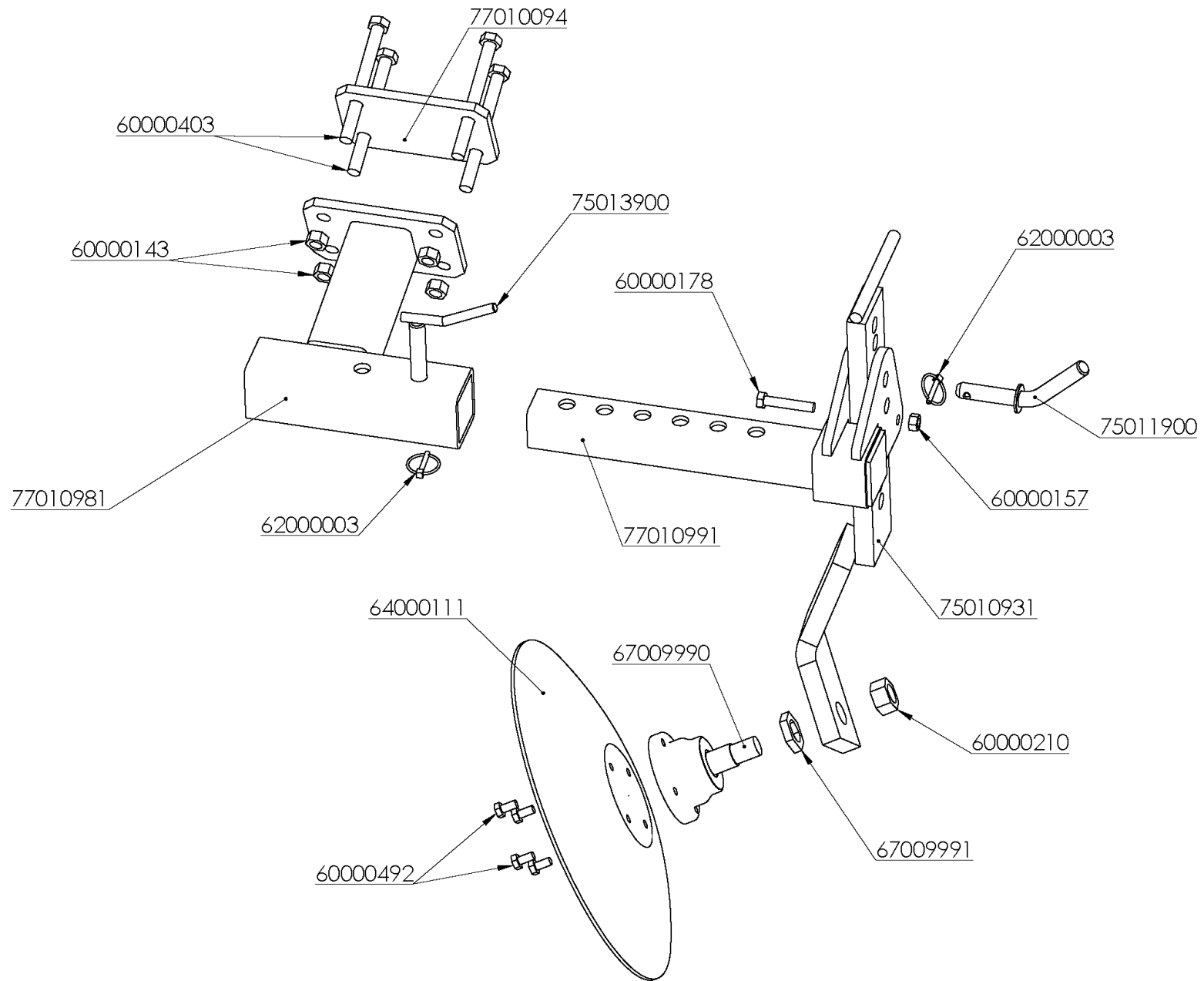

## SIDE DISC

REFERENCIA	DESCRIPCIÓN
60000143	TUER.AUTO.DIN-980 16 8.8 ZINC.
60000157	TUER.EXAG.DIN-934 12 8.8 ZINC
60000178	TORN.EXAG.DIN-931 12* 65 8.8 ZINC.
60000210	TUER.AUTO.DIN-985 1" SAE 8.8 ZN.
60000403	TORN.EXAG.DIN-931 16*170 10.9 ZINC.
60000492	TORN.EXAG.DIN-933 10* 20 10.9 ZINC.
62000003	PASADOR ANILLA 6 ZINC.
64000111	DISCO CONCAVO LISO FENIX/VB 1960-18" 4mm.
67009990	CONJ.BUJE + EJE DISCOS 20" (D/16)
67009991	ARANDELA FRENO BUJE DISCOS
75010931	SOP.DISCOS VBC IZQD.
75011900	BULON D=20*200mm.REG.DISCO FENIX/VBC
75013900	BULON D=20*118mm.REG.RODILLO ZINC.
77010094	PLACA AMARRE DISCO CIERRE MAXIDISC-II
77010981	SOP.DISCO CIERRE REG.LAT. MAXIDISC
77010991	BRAZO DISCO CIERRE EURO/MAXIDISC



# LATERAL WHEELS

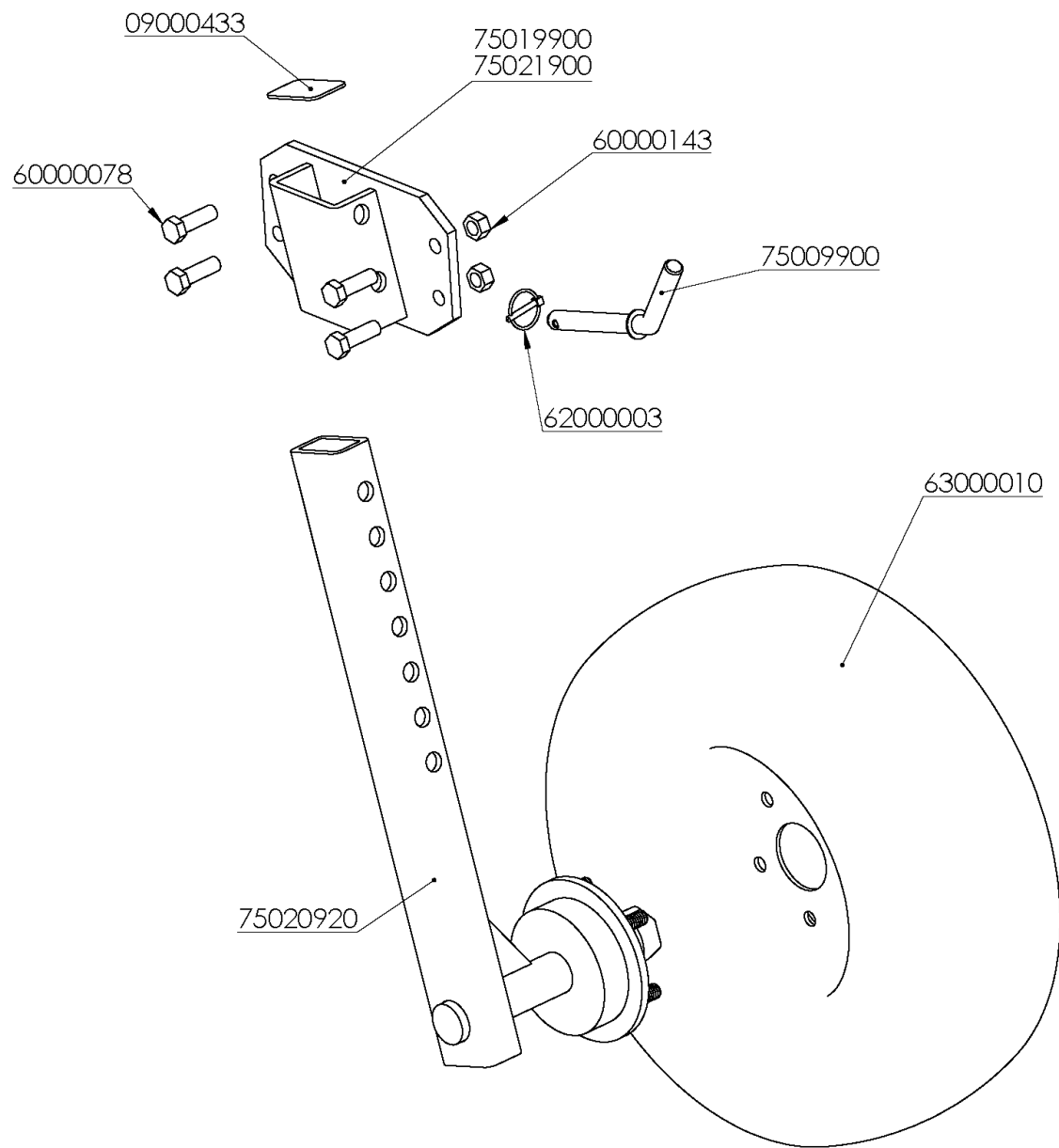

## LATERAL WHEELS

REFERENCIA	DESCRIPCIÓN
9000433	TAPON GOMA 80* 50* 8mm.
60000078	TORN.EXAG.DIN-933 16* 50 8.8 ZINC.
60000143	TUER.AUTO.DIN-980 16 8.8 ZINC.
62000003	PASADOR ANILLA 6 ZINC.
63000010	R.N.C/ATAQUE 200/60*14,5"-10PR RAL-6029
75009900	BULON D=20*255mm.REG.RDA.CH ZINC.
75019900	SOP.RDA.CHISEL DCH.
75020920	BRAZO RDA.NEUM.(608*205) CHISEL
75021900	SOP.RDA.CHISEL IZQD.





# FIX EURODISC TRAFFIC LIGHT KIT

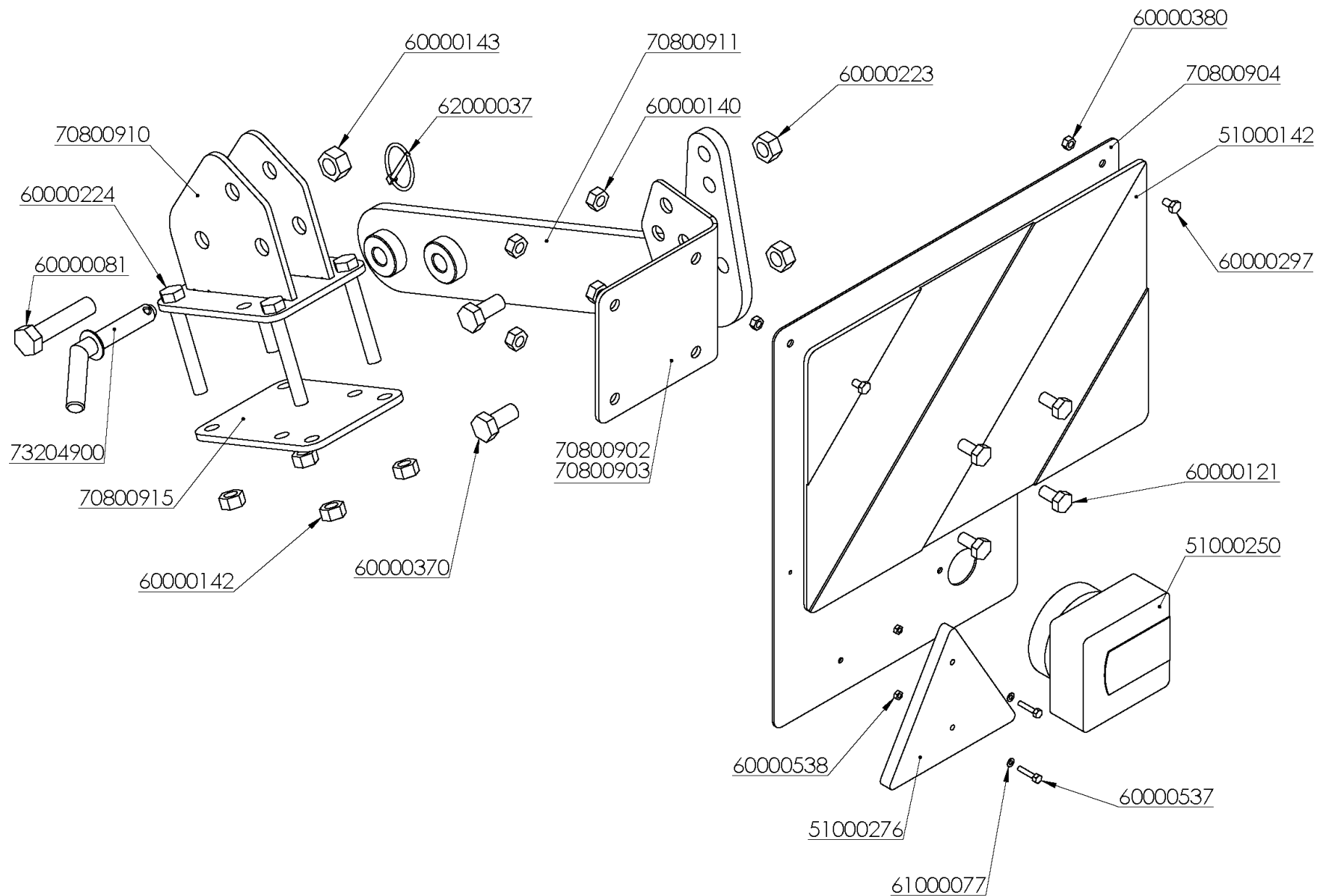

## FIX EURODISC TRAFFIC LIGHT KIT

REFERENCIAS	DESCRIPCIÓN
51000142	PAREJA PANEL PLACA 423x282 239909
51000250	KIT LUCES MAGNETICAS LED INALAMBRICAS 1216802
51000276	TRIANGULO ROJO 04010
60000081	TORN.EXAG.DIN-931 16* 70 8.8 ZINC.
60000121	TORN.EXAG.DIN-933 10* 20 8.8 ZINC.
60000140	TUER.AUTO.DIN-980 10 8.8 ZINC.
60000142	TUER.AUTO.DIN-980 12 8.8 ZINC.
60000143	TUER.AUTO.DIN-980 16 8.8 ZINC.
60000223	TUER.AUTO.DIN-980 14 8.8 ZINC.
60000224	TORN.EXAG.DIN-931 12* 90 10.9 ZINC.
60000297	TORN.EXAG.DIN-931 6* 10 8.8 ZINC.
60000370	TORN.EXAG.DIN-933 14* 35 8.8 ZINC.
60000380	TUER.AUTO.DIN-985 6 8.8 ZINC.
60000537	TORN.EXAG.DIN-933 4* 20 8.8 ZINC.
60000538	TUER.AUTO.DIN-985 4 8.8 ZINC.
61000077	ARAND.DIN-125 4 ZINC.
62000037	PASADOR ANILLA 4,5 ZINC.
70800902	PLACA SOP.IZQDA.SEÑALIZACION MULTIPLE
70800903	PLACA SOP.DCHA.SEÑALIZACION MULTIPLE
70800904	PLACA SEÑALIZACION MULTIPLE
70800910	SOP.SEÑAL.VBC/MAXIDISC
70800911	BRAZO SEÑAL.VBC/MAXIDISC FIJA
70800915	PLACA AMARRE.SOP.SEÑAL.VBC/MAXIDISC
73204900	BULON D=16*150mm.REG.RDA.DOBLE



# FOLDABLE EURODISC TRAFFIC LIGHT KIT

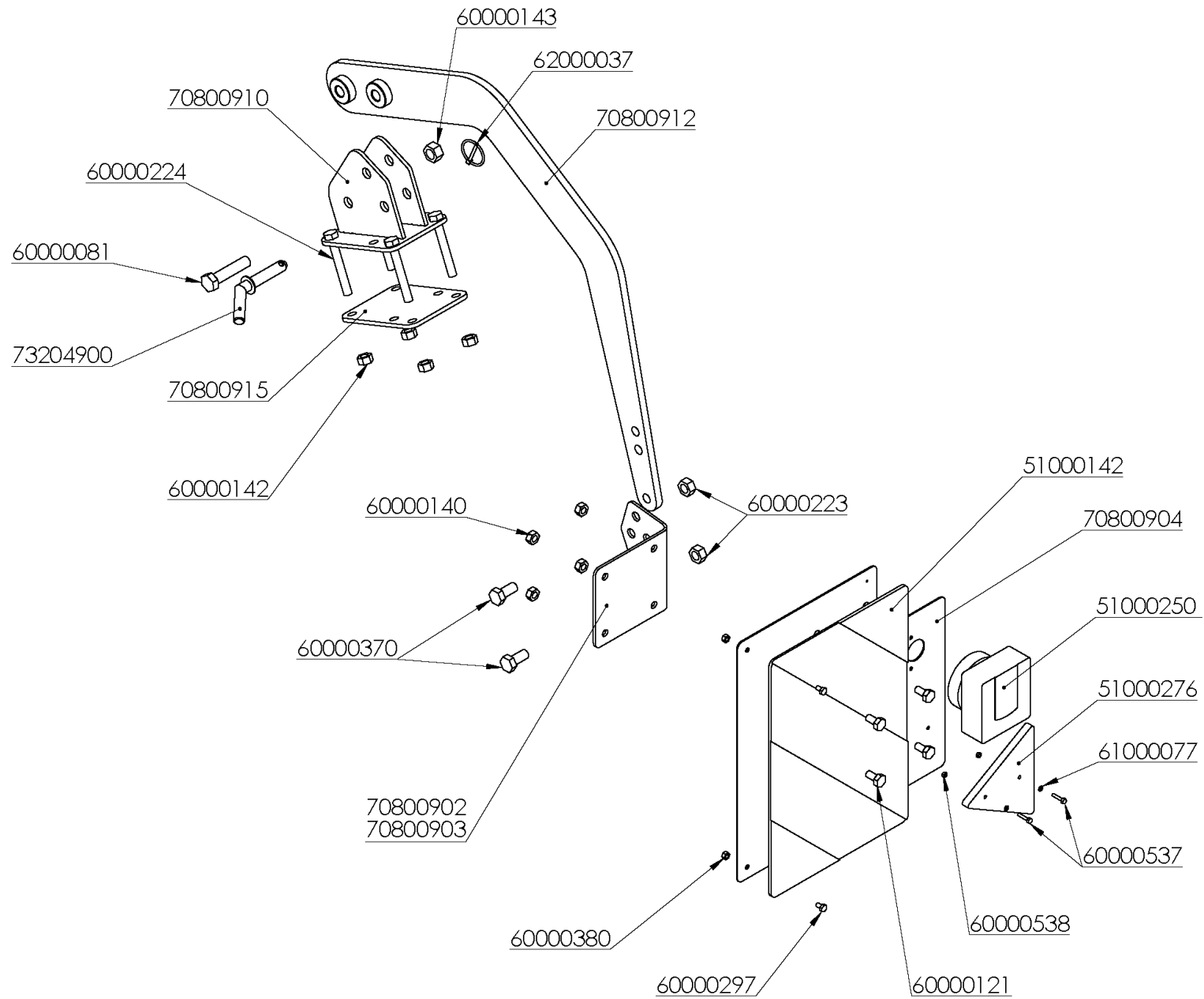

## FOLDABLE EURODISC TRAFFIC LIGHT KIT

REFERENCIAS	DESCRIPCIÓN
51000142	PAREJA PANEL PLACA 423x282 239909
51000250	KIT LUCES MAGNETICAS LED INALAMBRICAS 1216802
51000276	TRIANGULO ROJO 04010
60000081	TORN.EXAG.DIN-931 16* 70 8.8 ZINC.
60000121	TORN.EXAG.DIN-933 10* 20 8.8 ZINC.
60000140	TUER.AUTO.DIN-980 10 8.8 ZINC.
60000142	TUER.AUTO.DIN-980 12 8.8 ZINC.
60000143	TUER.AUTO.DIN-980 16 8.8 ZINC.
60000223	TUER.AUTO.DIN-980 14 8.8 ZINC.
60000224	TORN.EXAG.DIN-931 12* 90 10.9 ZINC.
60000297	TORN.EXAG.DIN-931 6* 10 8.8 ZINC.
60000370	TORN.EXAG.DIN-933 14* 35 8.8 ZINC.
60000380	TUER.AUTO.DIN-985 6 8.8 ZINC.
60000537	TORN.EXAG.DIN-933 4* 20 8.8 ZINC.
60000538	TUER.AUTO.DIN-985 4 8.8 ZINC.
61000077	ARAND.DIN-125 4 ZINC.
62000037	PASADOR ANILLA 4,5 ZINC.
70800902	PLACA SOP.IZQDA.SEÑALIZACION MULTIPLE
70800903	PLACA SOP.DCHA.SEÑALIZACION MULTIPLE
70800904	PLACA SEÑALIZACION MULTIPLE
70800910	SOP.SEÑAL.VBC/MAXIDISC
70800912	BRAZO SEÑAL.VBC/MAXIDISC PLEG.
70800915	PLACA AMARRE.SOP.SEÑAL.VBC/MAXIDISC
73204900	BULON D=16*150mm.REG.RDA.DOBLE



# FRONT TRAILING KIT

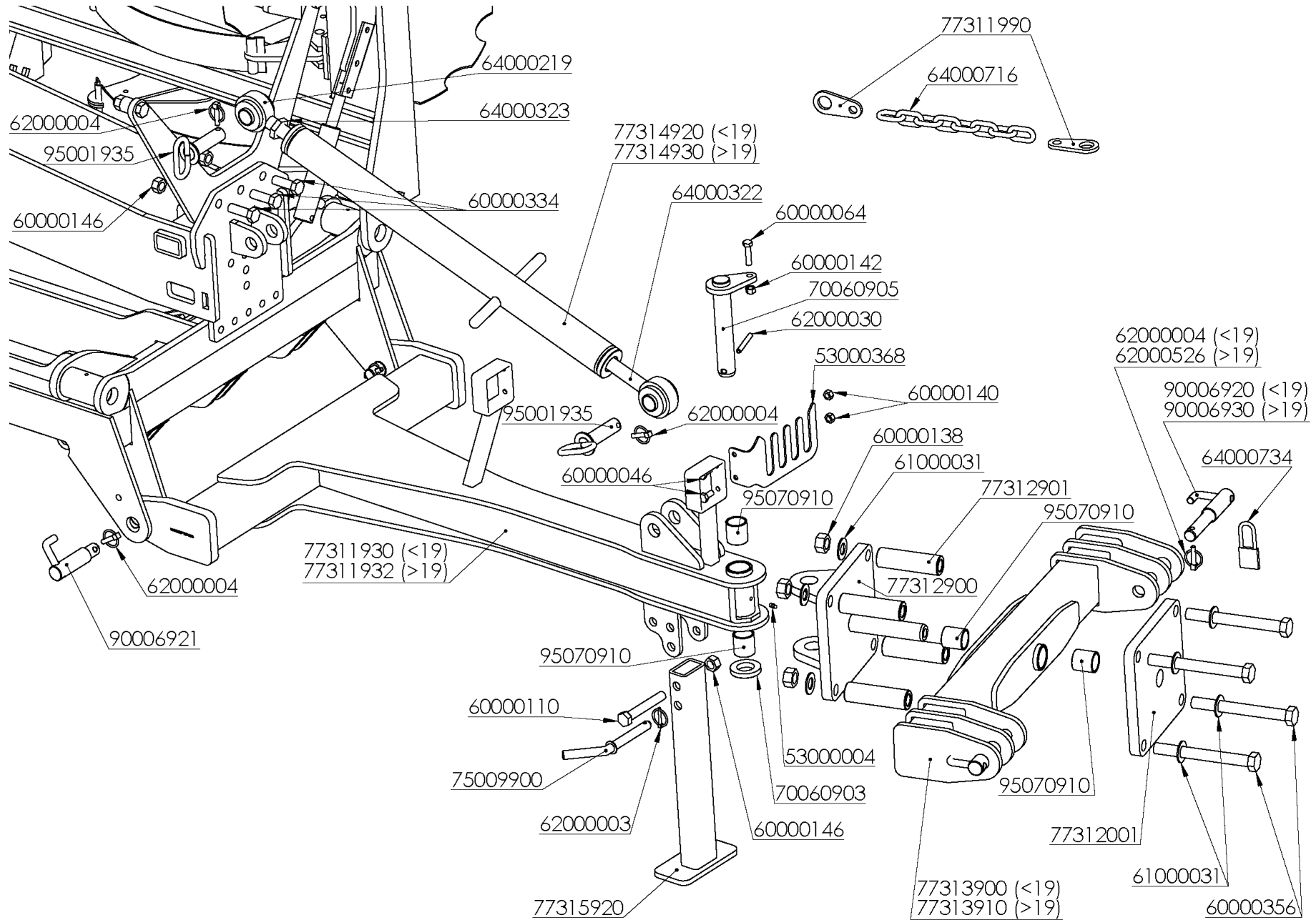

# FRONT TRAILING KIT

REFERENCIA	DESCRIPCIÓN	REFERENCIA	DESCRIPCIÓN
53000004	ENGRASADOR AC° DIN-71412 8*125	64000734	CANDADO SEGURIDAD LATON IFAM K-40 AL PARA SS
53000368	SOPORTE LATIG.TORRETA 4 HUECOS ZINC.	70060903	ARAND.P/BULON PLEG.CH/MCH/DISC
60000046	TORN.EXAG.DIN-933 10* 25 8.8 ZINC.	70060905	BULON D=40*244mm.ARRASTRE MAXIDISC
60000064	TORN.EXAG.DIN-931 12* 50 10.9 ZINC.	75009900	BULON D=20*255mm.REG.RDA.CH ZINC.
60000110	TORN.EXAG.DIN-931 20*130 8.8 ZINC.	77311930	LANZA TIRO VBC
60000138	TUER.AUTO.DIN-980 1"SAE 10.9 ZINC.	77311932	LANZA TIRO VBC/EURODISC (D/19)
60000140	TUER.AUTO.DIN-980 10 8.8 ZINC.	77311990	PLACA CADENA KIT ARRASTRE
60000142	TUER.AUTO.DIN-980 12 8.8 ZINC.	77312001	PLACA ROTULA MAXIDISC
60000146	TUER.AUTO.DIN-980 20 10.9 ZINC. CON SOBREGOLPE	77312900	ROTULA MAXIDISC
60000334	TORN.EXAG.DIN-931 20* 60 8.8 ZINC.	77312901	CASQ.D=45/26*150mm.ROTULA MAXIDISC
60000356	TORN.EXAG.C/LAR.1"*240 SAE 12.9	77313900	BALANC.MAXIDISC
61000031	ARAND.STANDAR S/BISEL CL-26 ZINC.(50x27x3)	77313910	BALANC.VBC/MAXI/EURODISC CAT.III
62000003	PASADOR ANILLA 6 ZINC.	77314920	CUERPO TENSOR VBC
62000004	PASADOR ANILLA 10 ZINC.	77314930	CUERPO TENSOR VBC/EURODISC (D/19)
62000030	PASADOR ELAST.DIN-1481 10* 80 ZINC.	77315920	PEON VBC/EURODISC
62000526	PASADOR ANILLA LATERAL 16 ZINC.	90006920	BULON D=36/28*205mm.ENG.MAXIDISC/VBC/MCH-PV
64000219	BRAZO IZQD.C/ROT.32mm 30354	90006921	BULON D=36/28*124mm.ENG.EURODISC/VBC/MCH-III
64000322	BRAZO DCH.C/ROT.32mm 30353	90006930	BULON D=40/36*145mm.ENGANCHE MAXI/EURO/VBC CAT-III
64000323	CONTRATUERCA M-39	95001935	BULON D=31,2*115mm.3er.PTO.PENT.CAT.III (D/02)
64000716	CADENA SEGURIDAD KIT ARRASTRE	95070910	CASQ.D= 48/40*50mm.CEM.ARTIC.KIT ARRASTRE



# FOLDING AUTOMATIC LOCKER

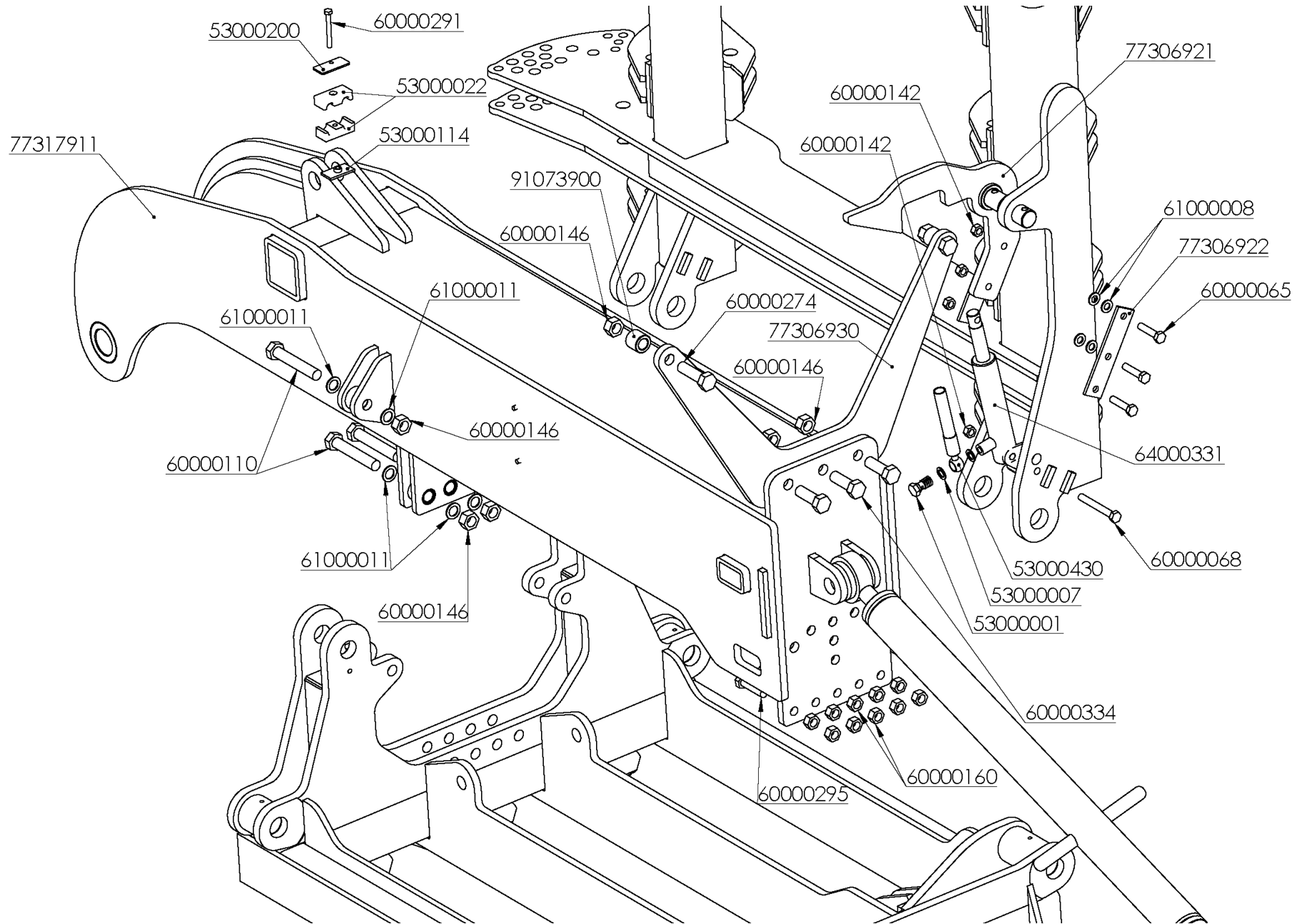

## FOLDING AUTOMATIC LOCKER

REFERENCIA	DESCRIPCIÓN
53000001	TORNILLO SIMPLE 3/8 4022
53000007	JUNTA METAL/GOMA 3/8" 11602
53000022	ABRAZ.DOBLE D=19mm. 1D19PP
53000114	PLACA SOLDAR AB.DOBLE 19 SP3D
53000200	PLACA RFZO.AB.DOBLE 19 GD3D
53000430	LATIG.R2-1/4* 700mm.OR-3/8/TL-18
60000065	TORN.EXAG.DIN-931 12* 55 10.9 ZINC.
60000068	TORN.EXAG.DIN-931 12*100 8.8 ZINC.
60000110	TORN.EXAG.DIN-931 20*130 8.8 ZINC.
60000142	TUER.AUTO.DIN-980 12 8.8 ZINC.
60000146	TUER.AUTO.DIN-980 20 10.9 ZINC.
60000160	TUER.EXAG.DIN-934 16 8.8 ZINC.
60000274	TORN.EXAG.DIN-931 20* 70 8.8 ZINC.
60000291	TORN.EXAG.DIN-931/933 8* 40 8.8 ZINC.
60000295	TORN.EXAG.DIN-931 16* 60 12.9
60000334	TORN.EXAG.DIN-931 20* 60 8.8 ZINC.
61000008	ARAND.DIN-125 12 ZINC.
61000011	ARAND.DIN-125 20 ZINC.
64000331	CILIND.FRENO 25/50/100
77306921	CONJ.GANCHO TRANQUE BAST.MAXIDISC (D/12)
77306922	LLANTA GANCHO TRANQUE BAST.MAXIDISC (D/12)
77306930	PLACA FIJA TRANQUE AUTOMATICO
77317911	SOP.ARRASTRE EURODISC (D/18)
91073900	CASQ.D= 35/21*31mm.SEP.PORTAC.SM/SF





# REAR TRAILING KIT

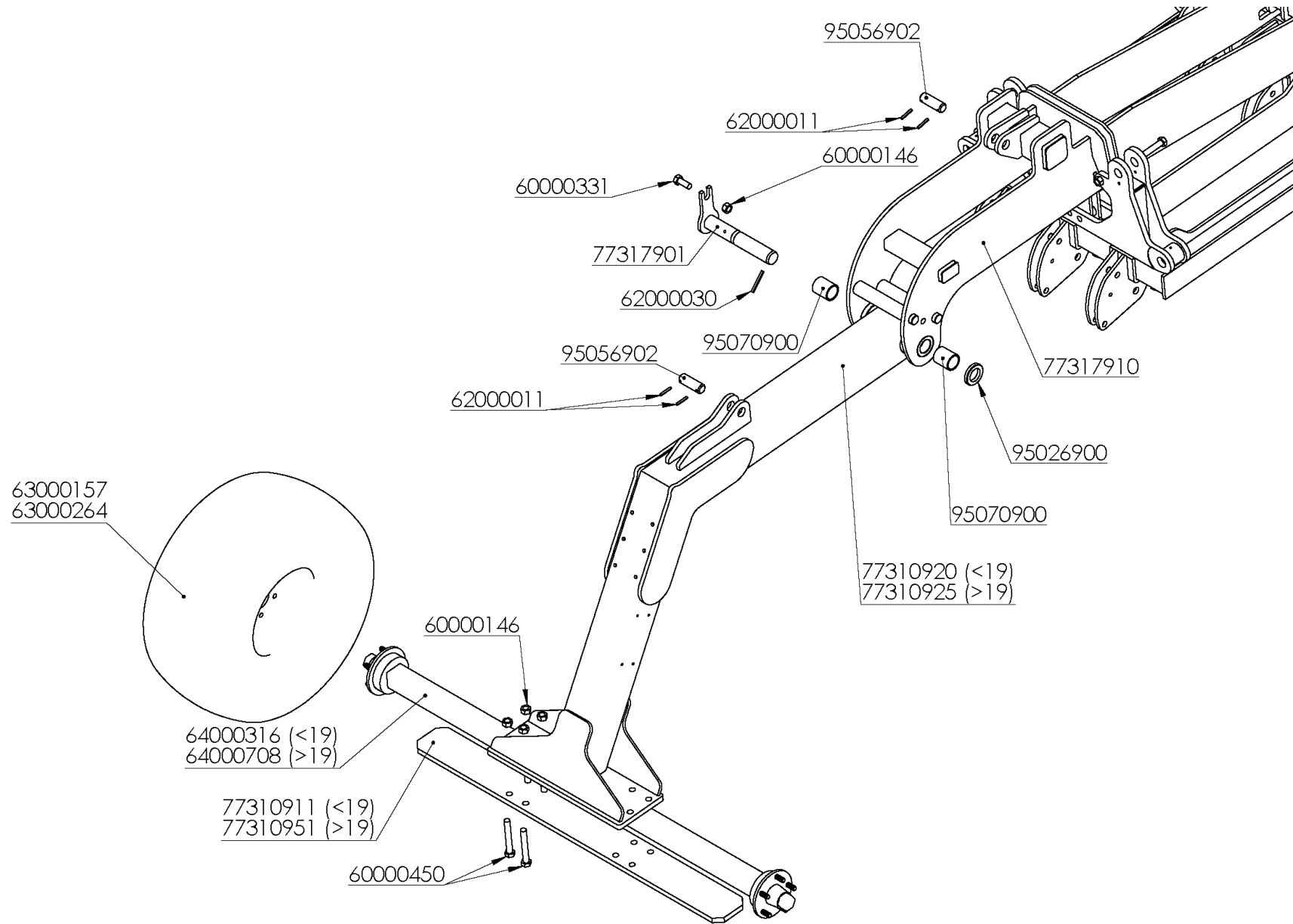

## REAR TRAILING KIT

REFERENCIA	DESCRIPCIÓN
60000146	TUER.AUTO.DIN-980 20 10.9 ZINC.
60000331	TORN.EXAG.DIN-933 20* 50 8.8 ZINC.
60000450	TORN.EXAG.DIN-931 20*140 8.8 ZINC.
62000011	PASADOR ELAST.DIN-1481 8* 50 ZINC.
62000030	PASADOR ELAST.DIN-1481 10* 80 ZINC.
63000157	R.N.C/ATAQUE 400/60*15,5"TL-14PR FLOTATION
63000264	N.C/ATAQUE 500/50-17"-18PR DCH+IZQ. 6 ESPARR. ARRASTR.
64000316	EJE RECTO C/F-70-65-300-60-16018-2100BL
64000708	EJE RECTO S/F-80-70-300-60-16020-2450BL
77310911	LLANTA FIJACION EJE RDA.MAXIDISC (D/11)
77310920	ARBOL RDA.EURODISC
77310925	ARBOL RDA.EURODISC (D/19)
77310951	PLACA INF.EJE ARBOL RDA.MAXIDISC (D/19)
77317901	BULON D=50*342mm.ARRASTRE VBC
77317910	SOP.ARRASTRE EURODISC
95026900	ARAND.P/BULON GIRO BASTIDOR
95056902	BULON D=34,8*100mm.CILIND.VOLTEO SS + DACROMET
95070900	CASQ.D= 60/50*70mm.CEM.ARTIC.SS/GIRO BAST.



# HYDRAULIC SYSTEM TRAILING KIT

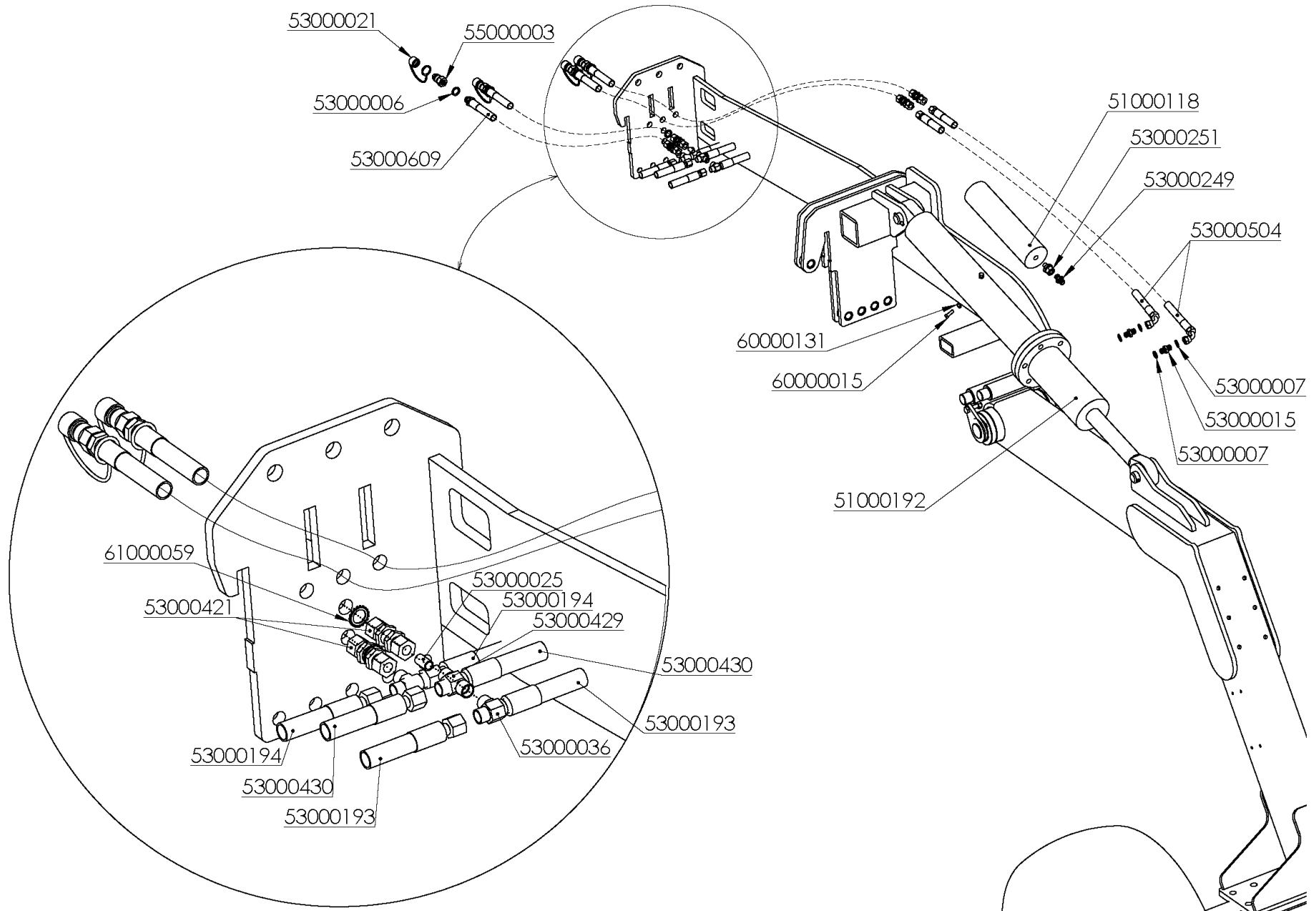

# HYDRAULIC SYSTEM TRAILING KIT

REFERENCIA	DESCRIPCIÓN	REFERENCIA	DESCRIPCIÓN
51000118	ACUMULADOR PISTON PO10A34N1-AC RAL-6029	53000430	LATIG.R2-1/4* 700mm.OR-3/8/TL-18
51000192	CILIND.ELEV.RDAS.50/110/210 VBC	53000504	LATIG.R2-3/8*2450mm.TL-18/CTL-3/8
53000006	JUNTA METAL/GOMA 1/2" 11603	53000505	LATIG.R2-1/4*4750mm.TL-18/CTL-3/8
53000007	JUNTA METAL/GOMA 3/8" 11602	53000609	LATIG.R2-3/8*3600mm.MF-1/2/TL-18
53000015	UNION MACHO 3/8 4062	55000003	ADAPTADOR E.R.FASTER 1/2" 30410108
53000021	PROTECTOR E.R.MACHO 1/2" ROJO 5029-4PR	60000015	TORN.EXAG.DIN-933 8* 25 8.8 ZINC.
53000025	M.TUBO ACERO D=12*9mm.ZINC..	60000061	TORN.EXAG.DIN-933 12* 40 8.8 ZINC.
53000036	TE UNION IGUAL 12 T12-L	60000064	TORN.EXAG.DIN-931 12* 50 10.9 ZINC.
53000193	LATIG.R2-3/8*1780mm.CTL-3/8/TL-18	60000131	TUER.AUTO.DIN-980 8 8.8 ZINC.
53000194	LATIG.R2-3/8*1740mm.OR-3/8/TL-18	60000142	TUER.AUTO.DIN-980 12 8.8 ZINC.
53000249	UNION MACHO 1/2 4063	61000059	ARAND.DIN-6798-A 18
53000251	UNION MACHO-TL 1/2 4313	64000331	CILIND.FRENO 25/50/100
53000421	PASATABIQUES 18*1,5 12L	64000463	HORQUILLA CILINDRO FRENO CHF-12
53000429	CRUZ UNION IGUAL 12 K12-L		



# FRONT WHEEL EURODISC (>21)

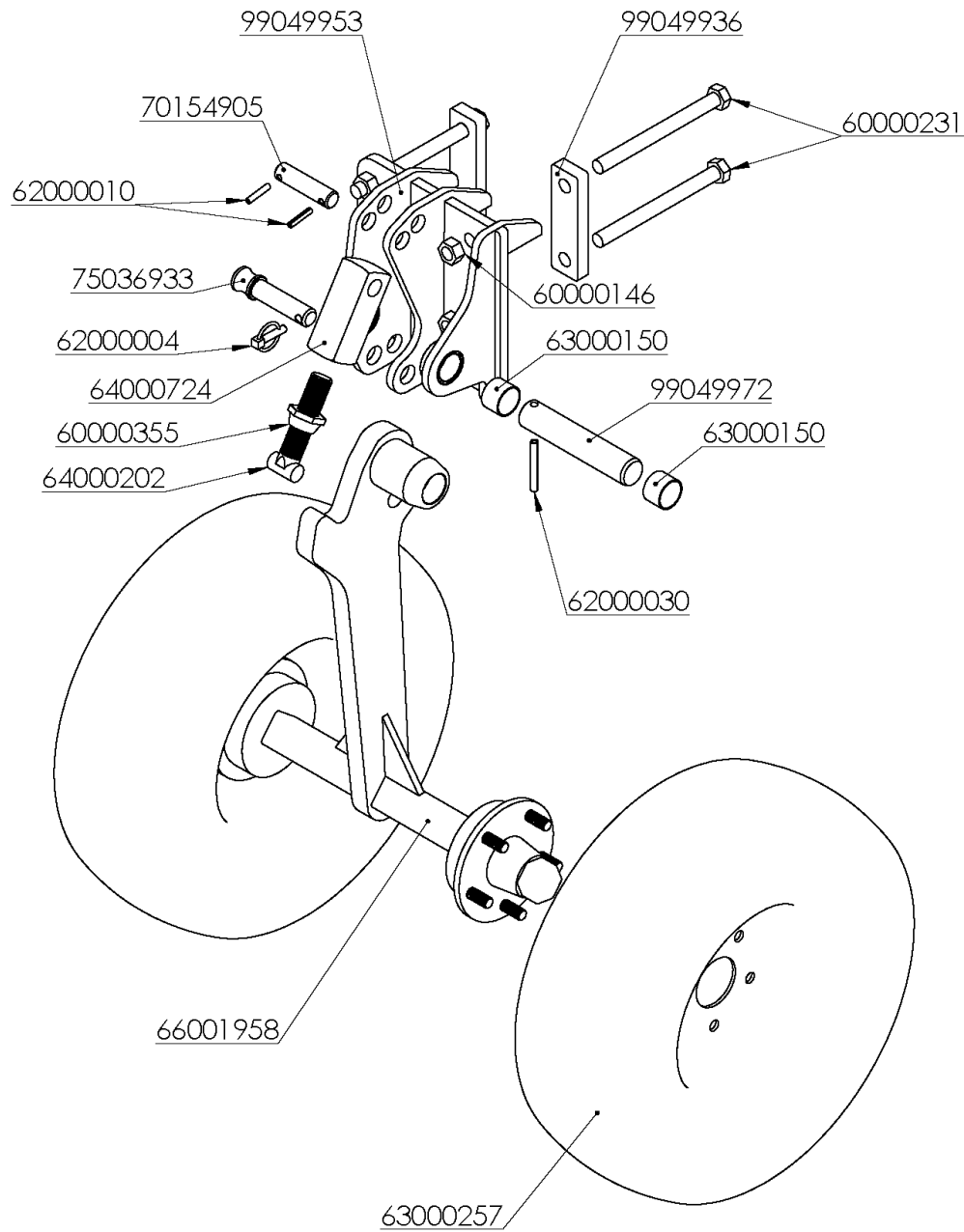

## FRONT WHEEL EURODISC (>21)

REFERENCIA	DESCRIPCIÓN
60000146	TUER.AUTO.DIN-980 20 10.9 ZINC. CON SOBREGOLPE
60000231	TORN.EXAG.C/LAR.20*225 12.9
60000355	TUER.TOPE VOLTEO 30/200 8.8 ZINC.
62000004	PASADOR ANILLA 10 ZINC.
62000010	PASADOR ELAST.DIN-1481 8* 40 ZINC.
62000030	PASADOR ELAST.DIN-1481 10* 80 ZINC.
63000150	CASQ.FRICCION PAP 4030 P10
63000257	R.N.C/ATAQUE 200/60*14,5"-10PR
64000202	TOPE MOVIL RDA.C/T TRATADO + ZINC.
64000724	SOP.TOPE MOVIL RDA.C/T NH ZINC.
66001958	BRAZO IZQD.RDA.DOBLE NEUM.(200/60) EURODISC (D/21)
70154905	BULON D=25*110mm.CILIND.MINI/GRADA/MCH
75036933	BULON BRAZO RODILLO VHC
99049936	LLANTA AMARRE RDA.DELANTERA EURODISC
99049953	SOP.IZQD.RDA.DELANTERA EURODISC
99049972	BULON D=40*200mm.BRAZO RDA.MCH-A



# FRONT WHEEL EURODISC (<21)

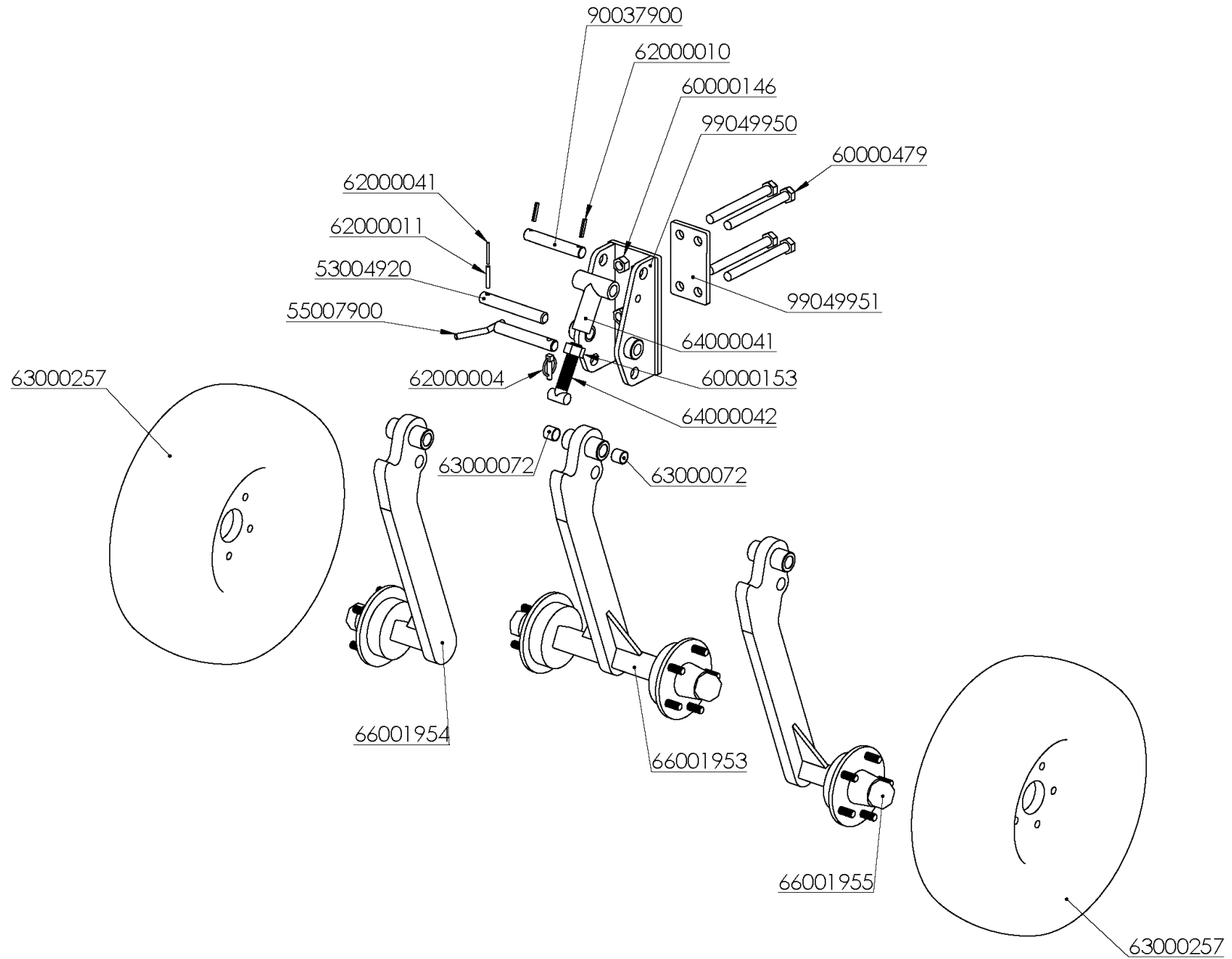

## FRONT WHEEL EURODISC (<21)

REFERENCIA	DESCRIPCIÓN
53004920	BULON D=25*175mm.BRAZO RDA.(D/03)
55007900	BULON D=25*160mm.TRANSP./CONTROL RDA.C/T
60000146	TUER.AUTO.DIN-980 20 10.9 ZINC. CON SOBREGOLPE
60000153	TUER.EXAG.DIN-934 1"SAE 8.8 ZINC.
60000479	TORN.EXAG.DIN-931 20*200 8.8 ZINC.
62000004	PASADOR ANILLA 10 ZINC.
62000010	PASADOR ELAST.DIN-1481 8* 40 ZINC.
62000011	PASADOR ELAST.DIN-1481 8* 50 ZINC.
62000041	PASADOR ELAST.DIN-1481 5* 50
63000072	CASQ.FRICCION PAP 2525 P10
63000257	R.N.C/ATAQUE 200/60*14,5"-10PR
64000041	SOP.TOPE MOVIL ZINC.
64000042	TOPE MOVIL TRATADO + ZINC.
66001953	BRAZO RDA.DOUBLE NEUM.(200/60) MAXIDISC-A
66001954	BRAZO DCHO.RDA.NEUM.(200/60) MAXIDISC-A
66001955	BRAZO IZQDO.RDA.NEUM.(200/60) MAXIDISC-A
90037900	BULON D=25*154mm.TOPE RDA.
99049950	SOP.RDA.DELANTERA EURODISC
99049951	PLACA AMARRE RDA.DELANTERA EURODISC





# FRONT SIGNALING KIT

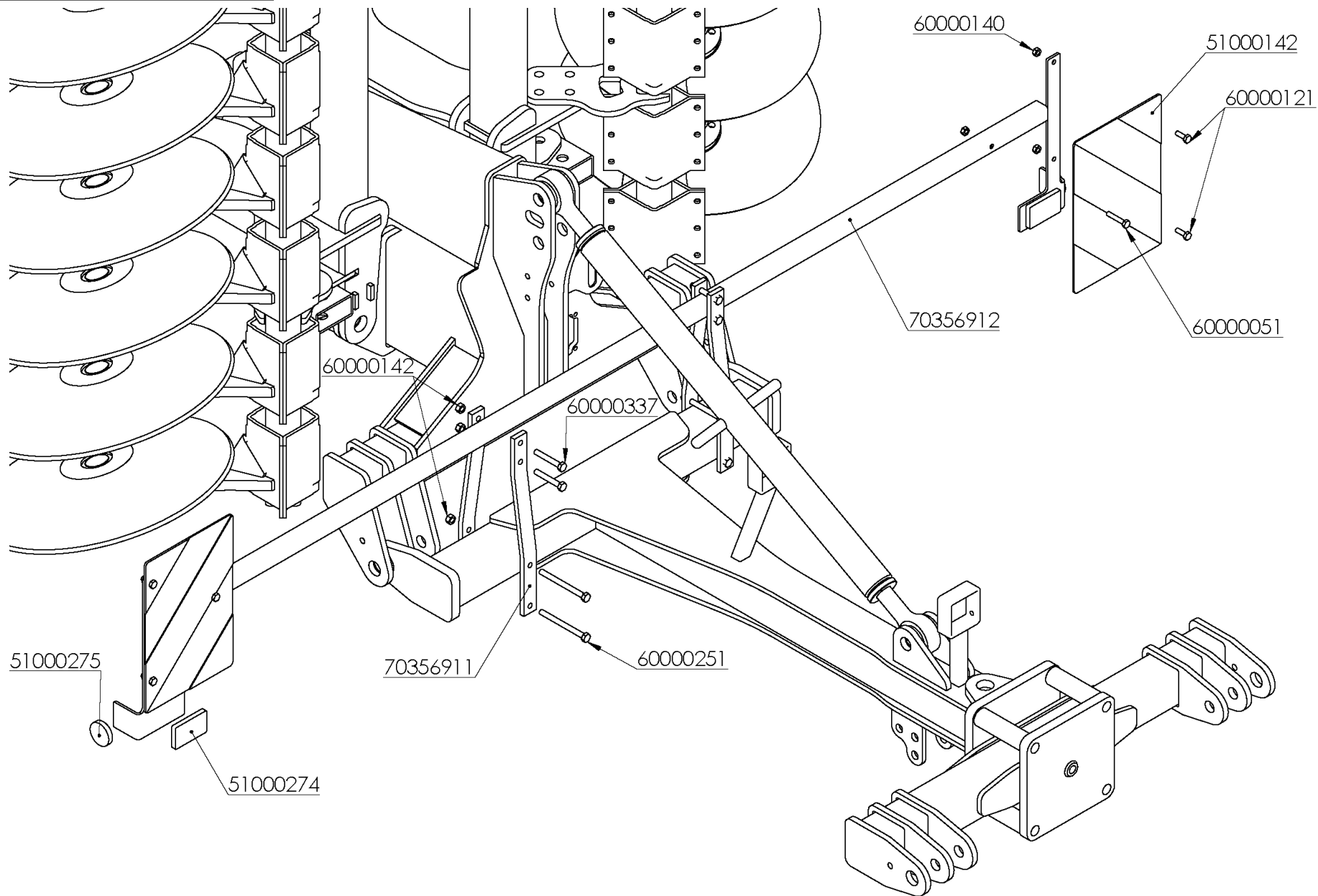

## FRONT SIGNALING KIT

REFERENCIAS	DESCRIPCIÓN
51000142	PANEL PLACA 423x282 (PAREJA) 1220128
51000274	CATADIOPTICO BLANCO 04026
51000275	CATADIOPTICO AMBAR 04007
60000051	TORN.EXAG.DIN-931 10* 50 10.9 ZINC.
60000121	TORN.EXAG.DIN-933 10* 20 8.8 ZINC.
60000140	TUER.AUTO.DIN-980 10 8.8 ZINC.
60000142	TUER.AUTO.DIN-980 12 8.8 ZINC.
60000251	TORN.EXAG.DIN-931 12*140 8.8 ZINC.
60000337	TORN.EXAG.DIN-931 12* 80 8.8 ZINC.
70356911	LLANTA SOP SEÑALIZACION FRONTAL MAXIDISC
70356912	SOP.SEÑALIZACION FRONTAL EURODISC



# REAR SIGNALING KIT

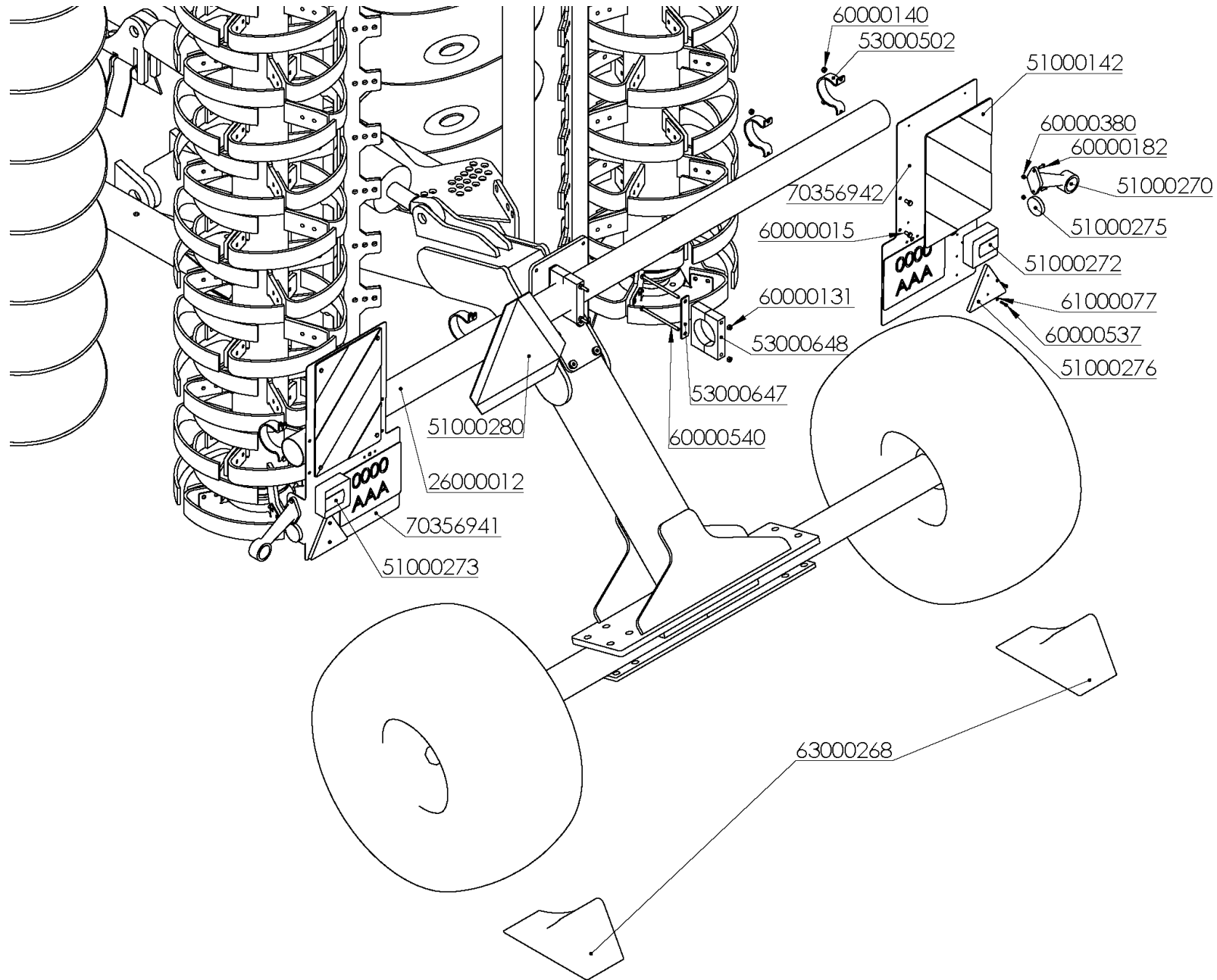

## REAR SIGNALING KIT

REFERENCIAS	DESCRIPCIÓN
26000012	M.TUBO LAMIN.FRIO GALV.D=88,9*2mm.
51000142	PANEL PLACA 423x282 (PAREJA) 1220128
51000270	CUERNO GALIBO LED LARGO 195X118 - FT009E
51000272	PILOTO TRASERO LED 02007DHLED3 DCHO.
51000273	PILOTO TRASERO LED 02007IZLED3 IZQ.
51000275	CATADIOPTRICO AMBAR 04007
51000276	TRIANGULO ROJO 04010
51000280	PANEL PLACA V-5 VEHICULO LENTO 06050
53000502	ABRAZ.ACUMULADOR 80/88 MPC
53000647	PLACA RFZO ABRAZADERA KIT SEÑALIZACION
53000648	ABRAZ.2 TORN.D.88,9 SER. (C9-88-9) KIT LUCES
60000015	TORN.EXAG.DIN-933 8* 25 8.8 ZINC.
60000131	TUER.AUTO.DIN-980 8 8.8 ZINC.
60000140	TUER.AUTO.DIN-980 10 8.8 ZINC.
60000182	TORN.EXAG.DIN-931 6* 35 8.8 ZINC.
60000380	TUER.AUTO.DIN-985 6 8.8 ZINC.
60000537	TORN.EXAG.DIN-933 4* 20 8.8 ZINC.
60000540	TORN.EXAG.DIN-931 8*150 8.8 ZINC.
61000077	ARAND.DIN-125 4 ZINC.
63000268	CALZO AL-KO ZINCADO 5000kg TIPO UK 46 St
70356941	PLACA IZQ. SEÑALIZACION MAXIDISC (D/18)
70356942	PLACA DCH. SEÑALIZACION MAXIDISC (D/18)





Polígono Industrial, C/ TAF, P163  
34200 - Venta de Baños  
Palencia - España



+34 979 76 10 11



comercial@ovlac.com



www.ovlac.com